

EXHIBIT "A"

LEGAL DESCRIPTION

ESCROW NO.: 030802369

Lot 10, in Block M, as set forth on that certain Final Map of SUNRIDGE HEIGHTS, PHASES 7B and 9, a Planned Unit Development, recorded in the office of the Douglas County Recorder on September 5, 1995 in Book 995, Page 410, as Document No. 369825, and by Certificate of Amendment recorded August 14, 1996, in Book 896, Page 2588, as Document No. 394289.

Assessor's Parcel No. 1420-18-510-006.

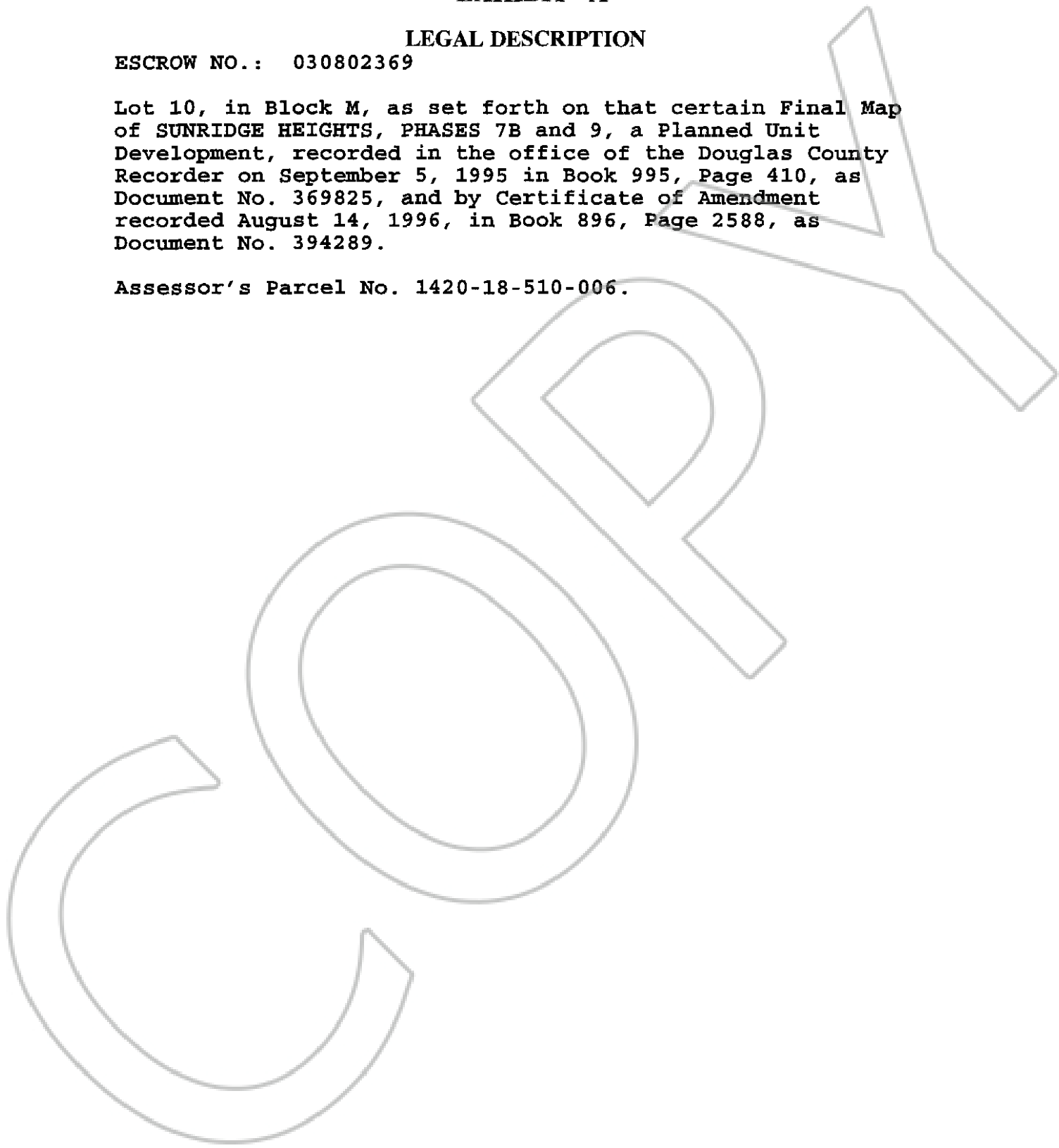

0584077

BK0703PG10603