

A.P.N. # 1320-29-110-039

R.P.T.T. \$ 369.20  
ESCROW NO. 030801608

RECORDING REQUESTED BY:  
**STEWART TITLE COMPANY**  
MAIL TAX STATEMENTS TO:  
**SAME AS BELOW**

WHEN RECORDED MAIL TO:  
**GRANTEE**  
**1785 LANTANA DRIVE**  
**MINDEN, NEVADA**

REQUESTED BY  
**Stewart Title of Douglas County**  
IN OFFICIAL RECORDS OF  
DOUGLAS CO., NEVADA

2003 JUL 25 PM 3:01

WERNER CHRISTEN  
RECORDER

\$15<sup>00</sup> PAID *Kj* DEPUTY

(Space Above for Recorder's Use Only)

### GRANT, BARGAIN, SALE DEED

THIS INDENTURE WITNESSETH: That **GLORIA M. MCGEHEE**, as Trustee of  
the **ARCHIE D. MCGEHEE 1991 FAMILY TRUST**

in consideration of \$10.00, the receipt of which is hereby acknowledged, does hereby Grant, Bargain Sell  
and Convey to **STANFORD L. HOPKINS AND JUANITA HOPKINS,**  
**HUSBAND AND WIFE AS JOINT TENANTS**

and to the heirs and assigns of such Grantee forever, all that real property situated in the  
County of **Douglas** State of Nevada, bounded and described as follows:

**SEE EXHIBIT "A" ATTACHED HERETO AND MADE A PART HEREOF**

Together with all and singular the tenements, hereditaments and appurtenances thereunto belonging or in  
anywise appertaining, and any reversions, remainders, rents, issues or profits thereof.

DATE: **June 12, 2003**

**ARCHIE D. MCGEHEE 1991 FAMILY TRUST**

BY: *Gloria M. McGehee*  
**GLORIA M. MCGEHEE**  
**TRUSTEE**

BY: \_\_\_\_\_

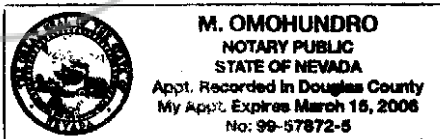

STATE OF Nevada }  
COUNTY OF Douglas } ss.

This instrument was acknowledged before me on 6/19/03  
by GLORIA M. MCGEHEE

\_\_\_\_\_  
Signature  
Notary Public

(Space Below for Recorder's Use Only)

0584448

BK0703PG12852

**EXHIBIT "A"**

**LEGAL DESCRIPTION**

ESCROW NO.: 030801608

Lot 443, in Block D, as shown on the Final Map No. 1008-8 for WINHAVEN, Unit No. 8, A PLANNED UNIT DEVELOPMENT, filed for record in the office of the County Recorder of Douglas County, Nevada on September 11, 1997, in Book 997 of Official Records at Page 2125, as Document No. 421412.

Assessors Parcel No. 1320-29-110-039

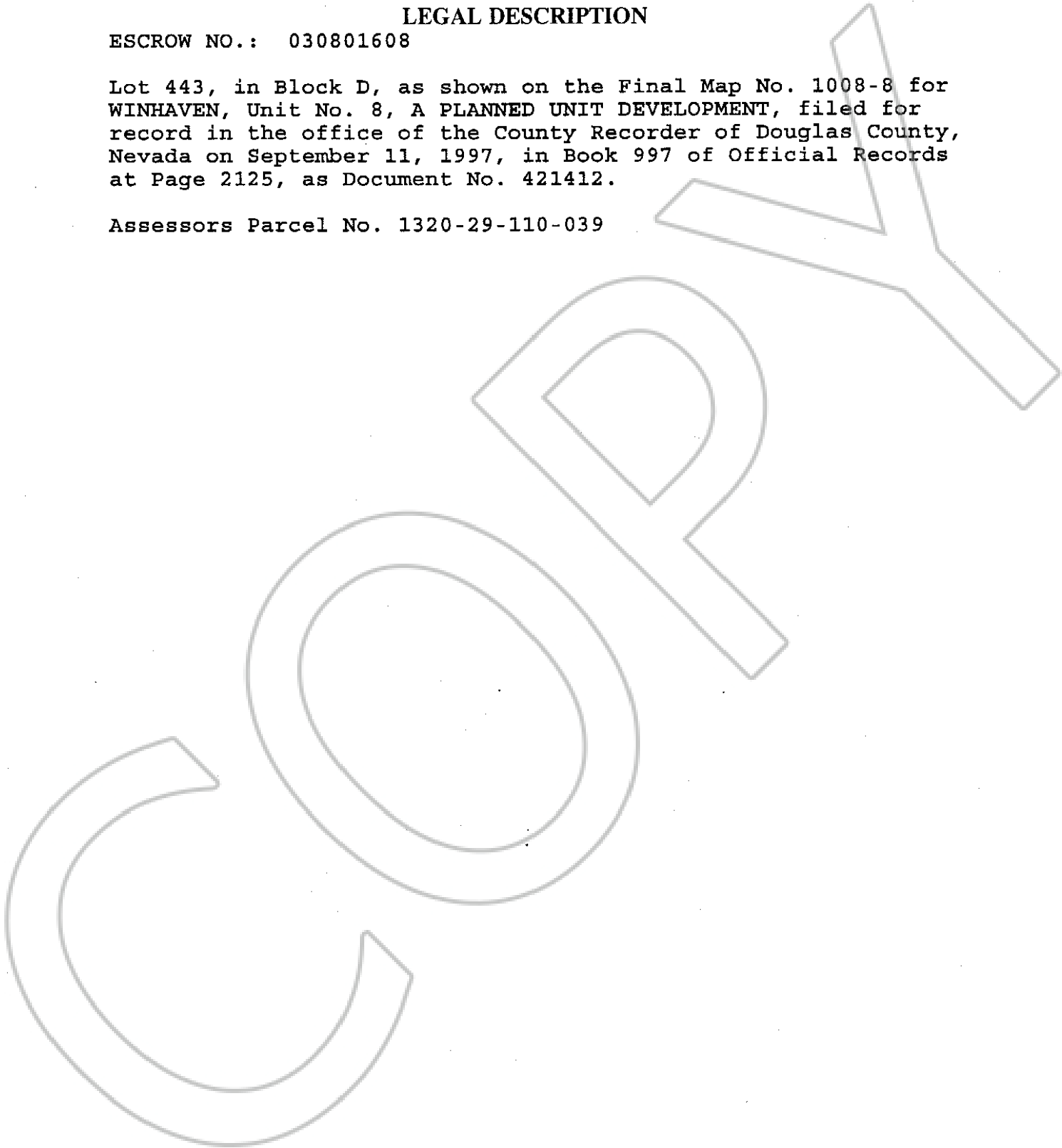

0584448

BK0703PG12853