

EXHIBIT "A"

LEGAL DESCRIPTION

ESCROW NO.: 030202430

Lot 6, Block A, as shown on the Final Map of MOUNTAIN SHADOWS APARTMENTS, recorded February 5, 1992, in Book 292, Page 472, Document No. 270423, Official Records of Douglas County, State of Nevada.

ASSESSOR'S PARCEL NO. 1220-16-411-005

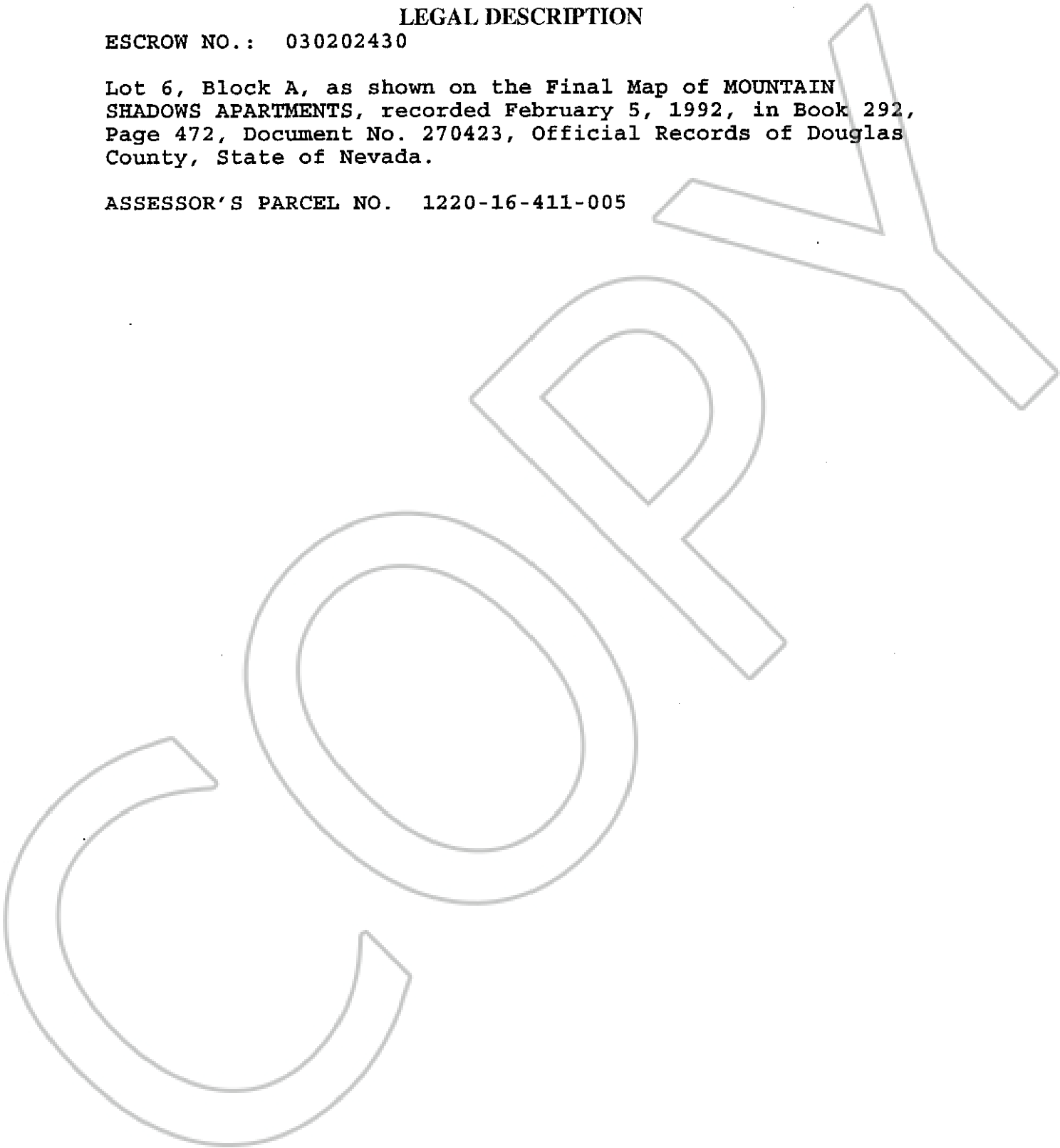

0584460

BK0703PG12956