

APN: 1320-29-212-011

RECORDING REQUESTED BY:

Anderson & Dorn, Ltd.
294 East Moana Lane, Suite B-27
Reno, Nevada 89509

AFTER RECORDING MAIL TO:

Kenneth & Laura Briscoe
2051 Desert Peach Drive
Carson City, Nevada 89703

MAIL TAX STATEMENT TO:

Ronald & Nancy Clarke
1048 Wisteria Drive
Minden, Nevada 89423

RPTT: \$170.³⁶₀₃

REQUESTED BY
Ronald A Clarke
IN OFFICIAL RECORDS OF
DOUGLAS CO., NEVADA

2003 JUL 28 AM 9:34

WERNER CHRISTEN
RECORDER

1600
\$ PAID *BE* DEPUTY

Document received
in soiled or
damaged condition

GRANT, BARGAIN, SALE DEED

THIS INDENTURE WITNESSETH THAT,

RONALD N. CLARKE and NANCY A. CLARKE, husband and wife, as
Joint Tenants with Right of Survivorship,

For Value, Hereby Grant, Bargain, Sell and Convey unto:

KENNETH C. BRISCOE and LAURA BRISCOE, Trustee(s), or their
successors in trust, under the BRISCOE LIVING TRUST, dated
June 01, 2001 and any amendments thereto to hold as
Community property,

An undivided 44% interest in that real property situated in the **County
of Douglas**, State of Nevada, more particularly described in Exhibit "A",
attached hereto and incorporated herein.

Subject To: 1. Taxes for the Current fiscal year, paid current
2. Restrictions, Conditions, Covenants, Rights, Rights of
Way, and Easements now of record, if any.

0584492

BK0703PG13178

EXHIBIT "A"

Legal Description:

Lot 128, In BLOCK D, AS SET FORTH ON THE MAP OF WINHAVEN, UNIT NO. 1, A PLANNED UNIT DEVELOPMENT FILED FOR RECORD IN THE OFFICE OF THE COUNTY RECORDER OF DOUGLAS COUNTY, STATE OF NEVADA, ON JANUARY 13, 1989 AS DOCUMENT NO. 194373.

Property Address: 1048 Wisteria Drive Minden, NV 89423

APN: 1320-29-212-011

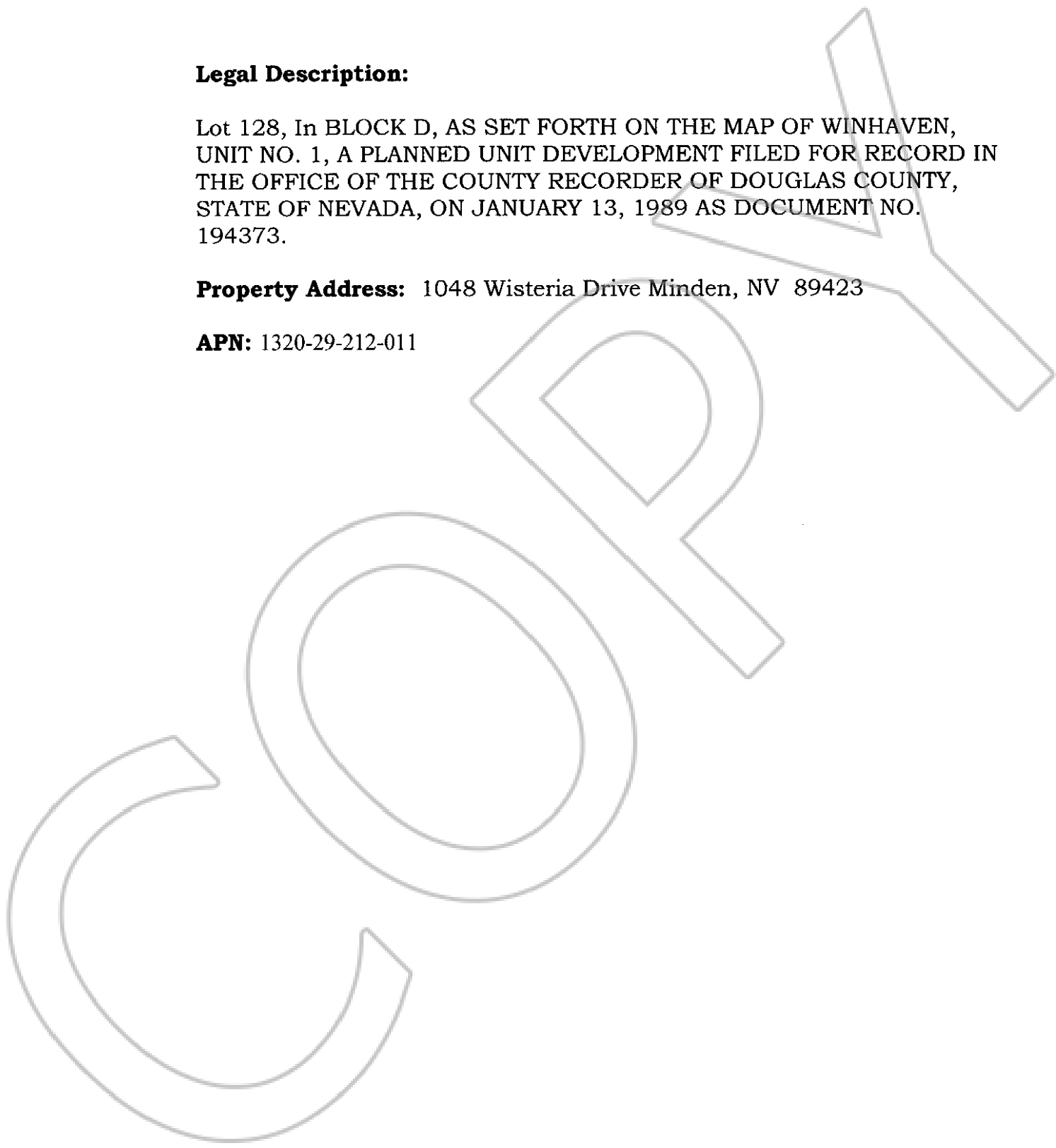

0584492

BK0703PG13180