

A.P.N. # 1320-32-114-012

R.P.T.T. \$ 331.50

ESCROW NO. 030802376

RECORDING REQUESTED BY:  
**STEWART TITLE COMPANY**

MAIL TAX STATEMENTS TO:  
**SAME AS BELOW**

WHEN RECORDED MAIL TO:

**GRANTEE**  
1749 OAKWOOD DRIVE  
MINDEN, NV 89423

REQUESTED BY  
**Stewart Title of Douglas County**  
IN OFFICIAL RECORDS OF  
DOUGLAS CO., NEVADA

2003 JUL 28 AM 10:53

WERNER CHRISTEN  
RECORDER

\$ 15.00 PAID PR DEPUTY

(Space Above for Recorder's Use Only)

### GRANT, BARGAIN, SALE DEED

THIS INDENTURE WITNESSETH: That **ALFRED J. DEL VECCHIO and LISA D. DEL VECCHIO, husband and wife** as joint tenants

in consideration of \$10.00, the receipt of which is hereby acknowledged, does hereby Grant, Bargain Sell and Convey to **GREGG A. POMERLEAU, a married man as his sole and separate property**

and to the heirs and assigns of such Grantee forever, all that real property situated in the County of **Douglas** State of Nevada, bounded and described as:

**SEE EXHIBIT "A" ATTACHED HERETO AND MADE A PART HEREOF**

Together with all and singular the tenements, hereditaments and appurtenances thereunto belonging or in anywise appertaining, and any reversions, remainders, rents, issues or profits thereof.

DATE: **July 03, 2003**

*Alfred J. Del Vecchio*  
ALFRED J. DEL VECCHIO

*Lisa D. Del Vecchio*  
LISA D. DEL VECCHIO

*HER ATTY IN FACT*

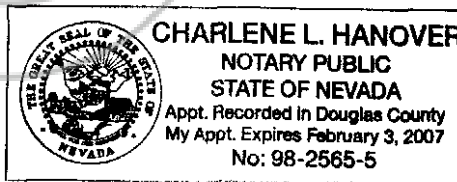

STATE OF NEVADA }  
COUNTY OF DOUGLAS } SS.

This instrument was acknowledged before me on July 17, 2003  
by ALFRED J. DEL VECCHIO and LISA D. DEL VECCHIO, BY ALFRED J. DEL VECCHIO, HER ATTY IN FACT

Signature *Charlene L. Hanover*

Notary Public (One inch margin on all sides of document for Recorder's Use Only)

0584530

BK0703PG13366

**EXHIBIT "A"**

**LEGAL DESCRIPTION**

**ESCROW NO.:** 030802376

Lot 8, in Block B, as shown on the Official Map of South Addition to Town of Minden, filed for record in the Office of the County Recorder, Douglas County, Nevada, on April 9, 1957, Document No. 12130.

**Assessors Parcel No.** 1320-32-114-012

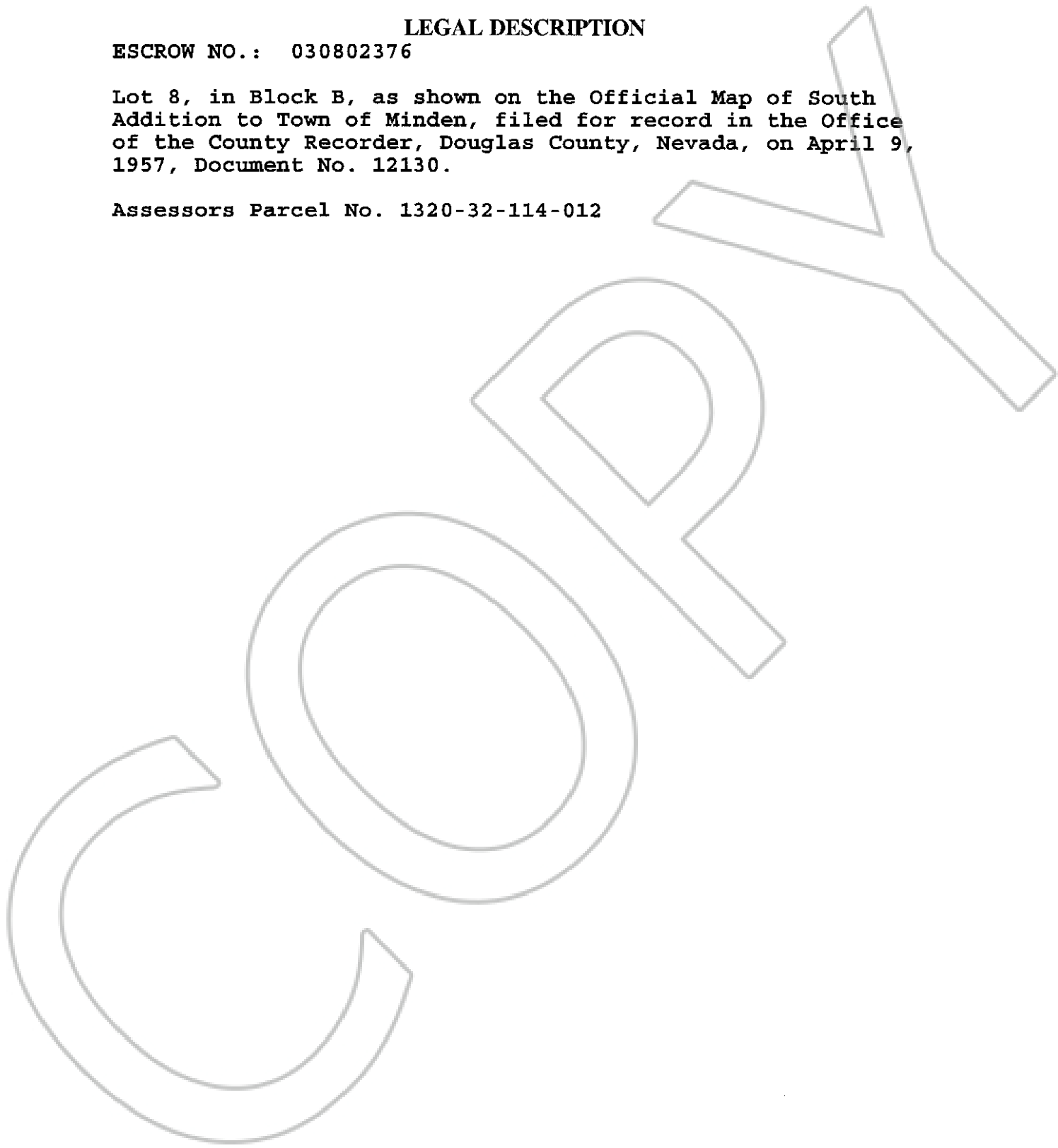

0584530

BK0703PG13367