

A.P.N. # 1022-29-310-005

R.P.T.T. \$ 93,60

ESCROW NO. 030802375

RECORDING REQUESTED BY:

**STEWART TITLE COMPANY**

MAIL TAX STATEMENTS TO:

**SAME AS BELOW**

950 MORNING STAR CT

GARDNERVILLE, NV 89460

WHEN RECORDED MAIL TO:

**GRANTEE**

REQUESTED BY  
**Stewart Title of Douglas County**  
IN OFFICIAL RECORDS OF  
DOUGLAS CO., NEVADA

2003 JUL 29 AM 10:50

WERNER CHRISTEN  
RECORDER

\$ 15<sup>00</sup> PAID Bz DEPUTY

(Space Above for Recorder's Use Only)

**GRANT, BARGAIN, SALE DEED**

THIS INDENTURE WITNESSETH: That **JAMES B. HANSEN** and **ANNA LEE HANSEN**, Trustees of the **HANSEN FAMILY TRUST DATED OCTOBER 25, 1995**

in consideration of \$10.00, the receipt of which is hereby acknowledged, does hereby Grant, Bargain Sell and Convey to **WILLIAM JAMES ROSS** and **KATHLEEN ANN ROSS**, husband and wife as joint tenants as to an undivided 1/2 interest and **TERRY B. HANSEN** and **GERALDINE JANE HANSEN**, husband and wife as joint tenants, as to an undivided 1/2 interest and to the heirs and assigns of such Grantee forever, all that real property situated in the

County of **Douglas** State of Nevada, bounded and described as:

**SEE EXHIBIT "A" ATTACHED HERETO AND MADE A PART HEREOF**

Together with all and singular the tenements, hereditaments and appurtenances thereunto belonging or in anywise appertaining, and any reversions, remainders, rents, issues or profits thereof.

DATE: **July 16, 2003**

**HANSEN FAMILY TRUST  
DATED OCTOBER 25, 1995**

BY: *James B. Hansen* trustee  
**JAMES B. HANSEN  
TRUSTEE**

BY: *Anna Lee Hansen* trustee  
**ANNA LEE HANSEN  
TRUSTEE**

STATE OF NEVADA }

COUNTY OF DOUGLAS } ss.

**CHARLENE L. HANOVER**  
NOTARY PUBLIC  
STATE OF NEVADA  
Appt. Recorded in Douglas County  
My Appt. Expires February 3, 2007  
No: 98-2565-5

This instrument was acknowledged before me on 7/23/2003  
by, JAMES B. HANSEN and ANNA LEE HANSEN

Signature *Charlene L. Hanover*

Notary Public (One Inch Margin on all sides of Document for Recorders Use Only)

0584682  
BK0703PG14389

**EXHIBIT "A"**

**LEGAL DESCRIPTION**

**ESCROW NO.:** 030802375

Lots 150 and 151, as set forth on the map of TOPAZ  
SUBDIVISION, filed in the Office of the County Recorder of  
Douglas County, State of Nevada, on August 10, 1954, as  
Document No. 9774.

**Assessors Parcel No.** 1022-29-310-005

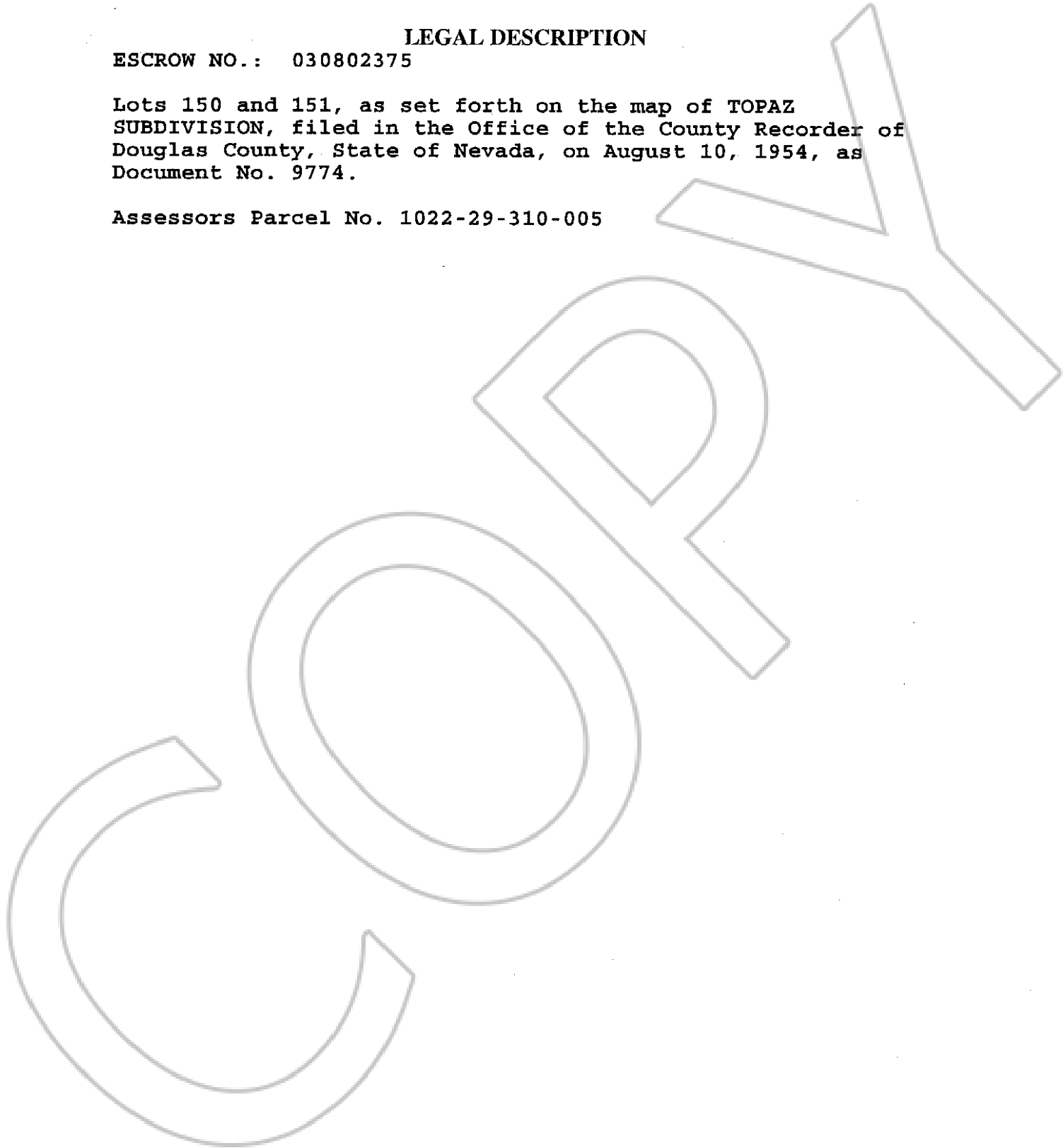

0584682

BK0703PG14390