

EXHIBIT "A"

LEGAL DESCRIPTION

ESCROW NO.: 030202448

Parcel No. 1:

Lot 12, as shown on the map of UPPAWAY, filed in the Office of the County Recorder of Douglas County, Nevada on May 21, 1976 as Document No. 00394.

Assessors Parcel No. 1418-15-511-018

Parcel No. 2:

An appurtenant easement for ingress and egress by document recorded August 15, 1988 in Book 888, Page 2279, Document No. 184315.

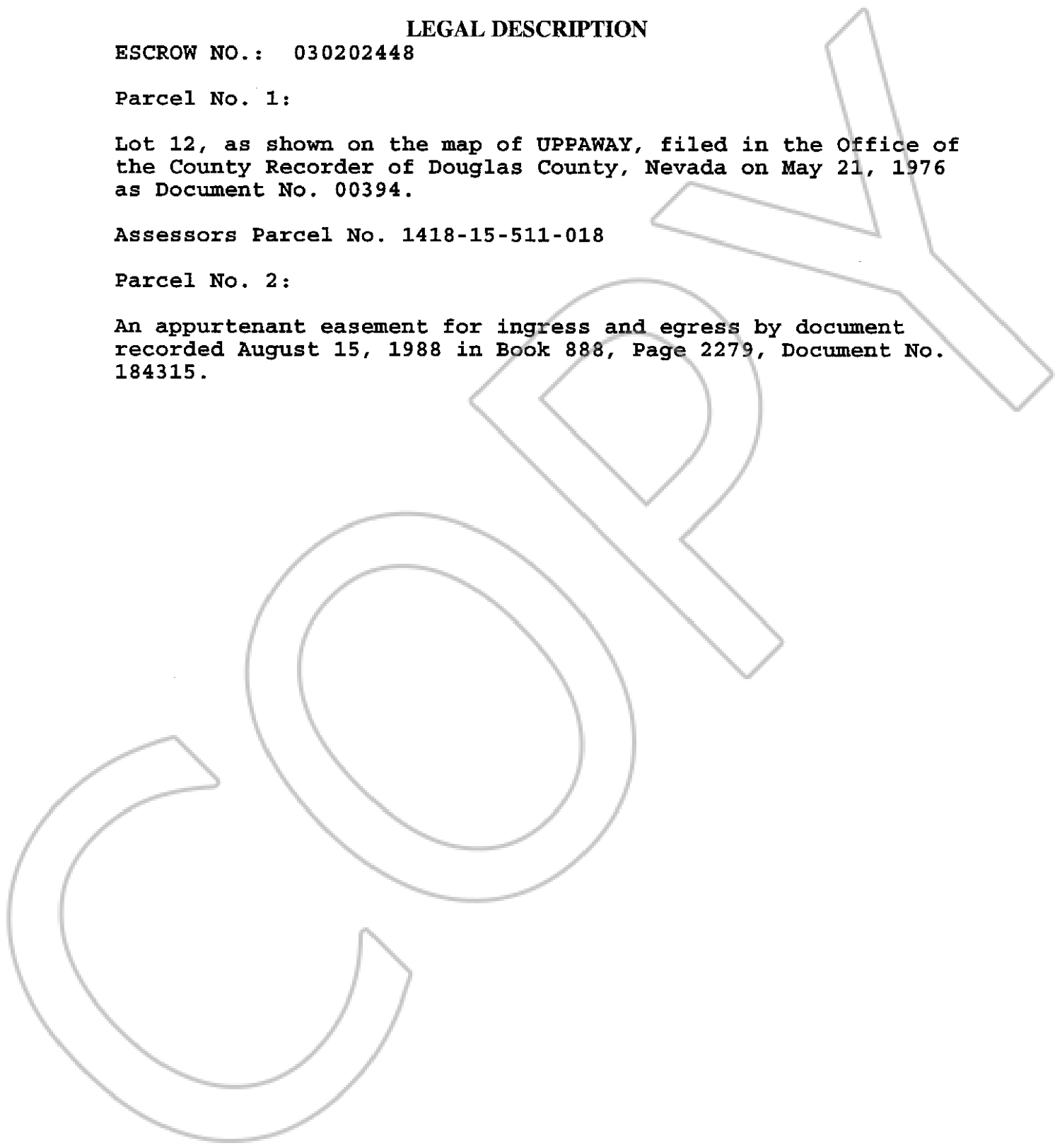

0584740

BK0703PG14893