

A.P.N. # 1220-17-614-020 & 07262003
 R.P.T.T. \$ #3
 ESCROW NO. 030710280
 RECORDING REQUESTED BY:
STEWART TITLE COMPANY
 MAIL TAX STATEMENTS TO:
same

WHEN RECORDED MAIL TO:
Grantee
1195 Manhattan Way
Gardnerville, NV 89460

(Space Above for Recorder's Use Only)

REQUESTED BY
Stewart Title of Douglas County
 IN OFFICIAL RECORDS OF
 DOUGLAS CO., NEVADA

2003 JUL 30 PM 3:18

WERNER CHRISTEN
 RECORDER

s. KW PAID BR DEPUTY

GRANT, BARGAIN, SALE DEED

THIS INDENTURE WITNESSETH: That **Kenneth J. Lillo and Lori Anne Lillo and Wife as Joint Tenants**

in consideration of \$10.00, the receipt of which is hereby acknowledged, does hereby Grant, Bargain Sell and Convey to **Lori A. Lillo and Kenneth J. Lillo, Wife and Husband as Joint Tenants**

and to the heirs and assigns of such Grantee forever, all that real property situated in the County of **Douglas** State of Nevada, bounded and described as:

SEE EXHIBIT "A" ATTACHED HERETO AND MADE A PART HEREOF

Together with all and singular the tenements, hereditaments and appurtenances thereunto belonging or in anywise appertaining, and any reversions, remainders, rents, issues or profits thereof.

DATE: **July 25, 2003**

Kenneth J. Lillo

Kenneth J. Lillo
Lori Anne Lillo

Lori Anne Lillo

SUE SULLIVAN
 Notary Public - State of Nevada
 Appointment Recorded in Washoe County
 No: 98-4983-2 - Expires October 28, 2006

STATE OF NEVADA }
 } ss.
 COUNTY OF Washoe }

This instrument was acknowledged before me on July 25, 2003
 by Kenneth J. Lillo and Lori Anne Lillo

Signature *Sue Sullivan*

 Notary Public (One inch margin on all sides of document for Recorder's Use Only)

0584907
 BK 0703 PG 15879

LEGAL DESCRIPTION

The land referred to herein is situated in the State of Nevada,
County of Douglas, described as follows:

Lot 34, Block F, as said Lot and Block are shown on the
Amended map of RANCHOS ESTATES, filed in the office of the
County Recorder of Douglas County, State of Nevada, on
October 30, 1972, as Document No. 62493.

Assessor's Parcel No. 1220-17-614-020

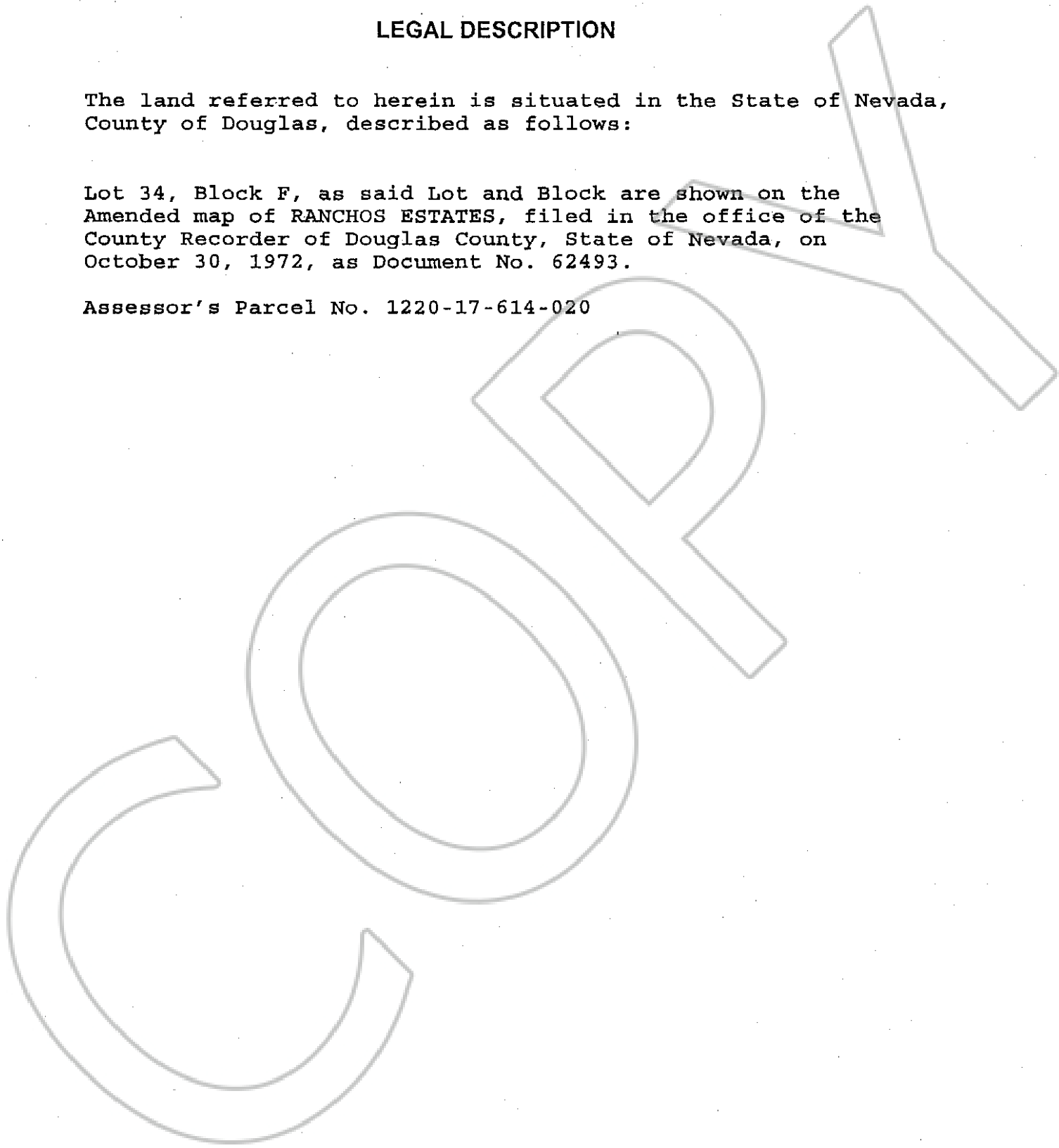

0584907

BK0703PG15880