

EXHIBIT "A"

LEGAL DESCRIPTION

ESCROW NO.: 030102743

Lot 6, as set forth upon that certain Subdivision Map entitled WILDHORSE ANNEX UNIT NO. 1, a Planned Unit Development, recorded January 6, 1994, in Book 194, at Page 1080, Official Records of Douglas County, State of Nevada, as Document No. 327012.

Assessors Parcel No. 1420-33-411-007

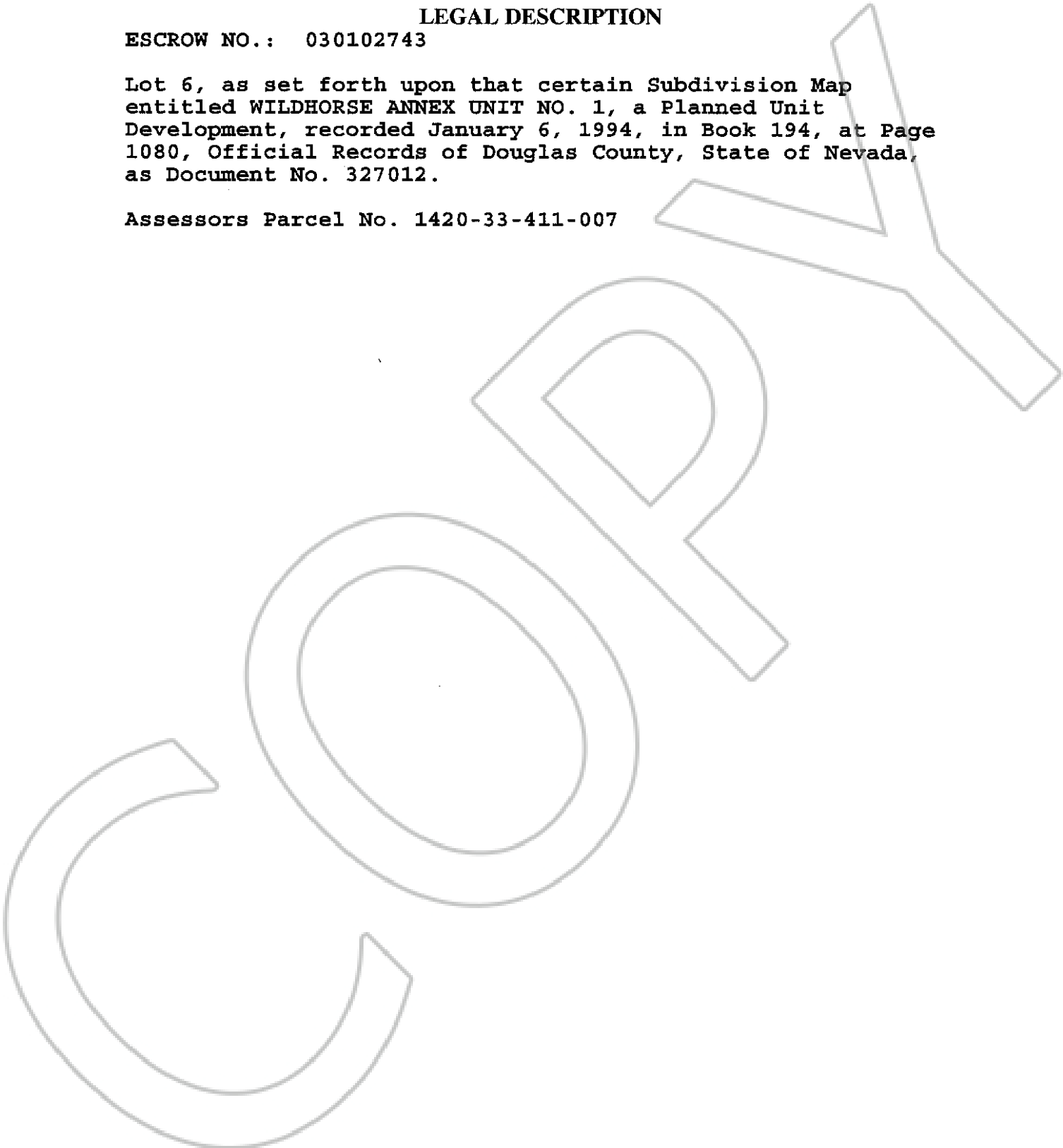

0585381

BK0803PG01220