



**EXHIBIT "A"**

**LEGAL DESCRIPTION**

ESCROW NO.: 030702831

Being within the Northeasterly 1/4 of Section 1, Township 12 North, Range 20 East, M.D.M., Douglas County, Nevada and being further described as follows:

Parcel B-1, of Parcel Map #2037 for MOLINE BUILDERS, INC., a redivision of Parcel B of Parcel Map #2032 for MOLINE BUILDERS, INC., filed for record May 15, 1997, in Book 597, Page 2440, as Document No. 412570, Official Records of Douglas County Recorder's Office, Minden, Nevada.

APN 1220-01-001-037

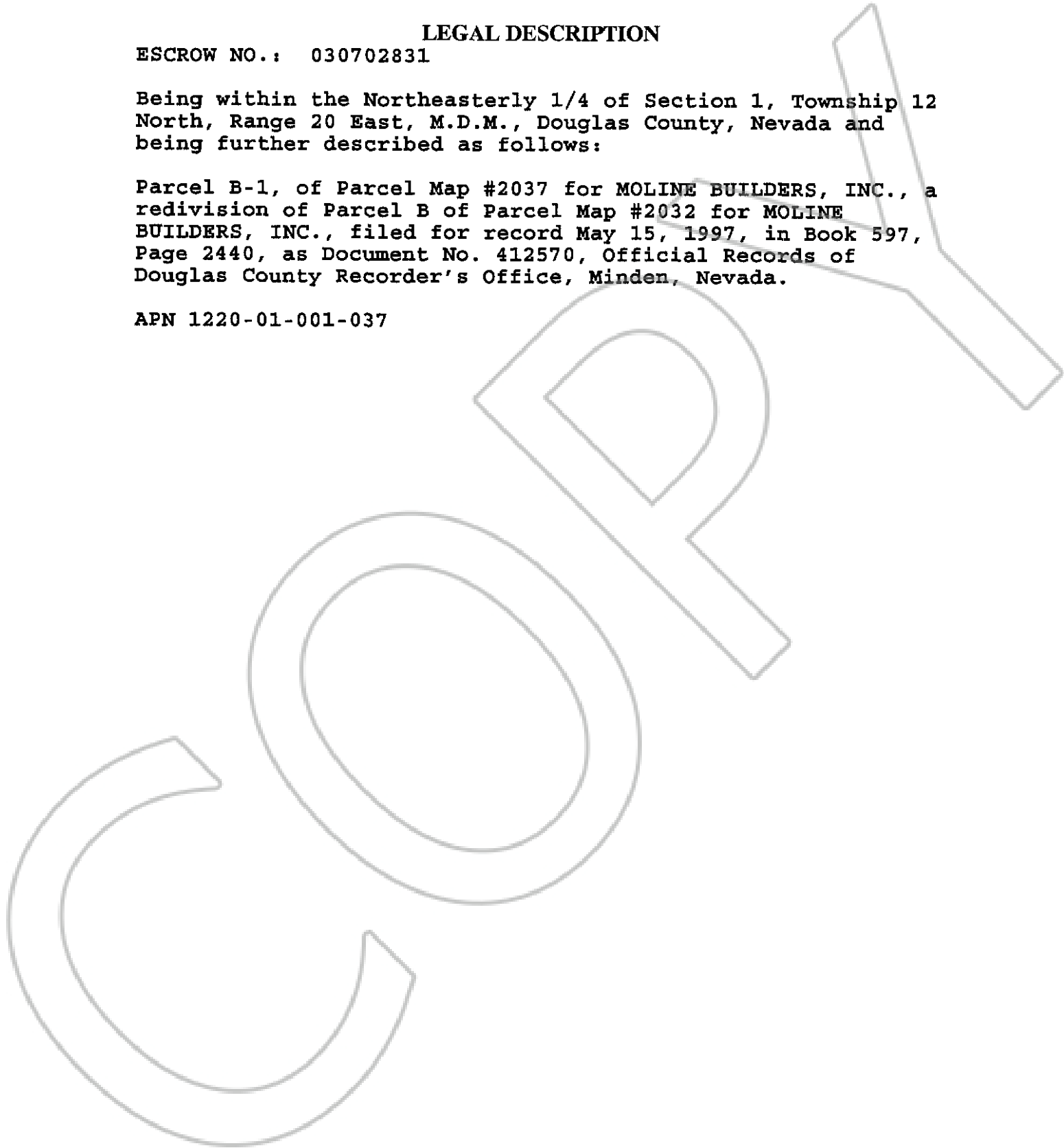

**0585683**

**BK0803PG03066**