

A.P.N. # 1220-15-410-042

R.P.T.T. \$ -0-6  
ESCROW NO. 030102745

RECORDING REQUESTED BY:  
**STEWART TITLE COMPANY**  
MAIL TAX STATEMENTS TO:  
**SAME AS BELOW**

REQUESTED BY  
**Stewart Title of Douglas County**  
IN OFFICIAL RECORDS OF  
DOUGLAS CO., NEVADA

2003 AUG -8 PM 3:01

WERNER CHRISTEN  
RECORDER

\$ 150 PAID RE DEPUTY

WHEN RECORDED MAIL TO:  
**GRANTEE**  
William C. Cunningham  
7635 Devonshire Lane  
Reno, Nevada 89511

(Space Above for Recorder's Use Only)

### GRANT, BARGAIN, SALE DEED

THIS INDENTURE WITNESSETH: That **GWYNNE C. CUNNINGHAM, SPOUSE OF GRANTEE HEREIN**

in consideration of \$10.00, the receipt of which is hereby acknowledged, does hereby Grant, Bargain Sell and Convey to **WILLIAM CARL CUNNINGHAM, A MARRIED MAN AS HIS SOLE AND SEPARATE PROPERTY**

and to the heirs and assigns of such Grantee forever, all that real property situated in the County of **Douglas** State of Nevada, bounded and described as :

**SEE EXHIBIT "A" ATTACHED HERETO AND MADE A PART HEREOF**

IT IS THE EXPRESS INTENT OF THE GRANTOR, BEING THE SPOUSE OF THE GRANTEE, TO CONVEY ALL RIGHT, TITLE AND INTEREST OF THE GRANTOR, COMMUNITY OR OTHERWISE, IN AND TO THE HEREIN DESCRIBED PROPERTY TO THE GRANTEE AS GRANTEE'S SOLE AND SEPARATE PROPERTY.

Together with all and singular the tenements, hereditaments and appurtenances thereunto belonging or in anywise appertaining, and any reversions, remainders, rents, issues or profits thereof.

DATE: **August 06, 2003**

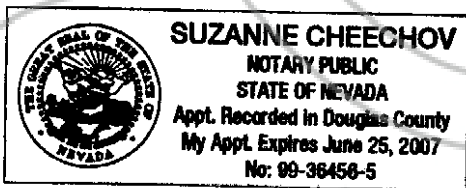

*Gwynne C. Cunningham*  
**GWYNNE C. CUNNINGHAM**

STATE OF NEVADA }  
                                  } ss.  
COUNTY OF Douglas }

This instrument was acknowledged before me on 8/8/2003,  
by, GWYNNE C. CUNNINGHAM

Signature *Suzanne Cheechov*  
Notary Public (One Inch Margin on all sides of Document for Recorder's Use Only)

**0585858**  
**BK 0803PG04112**

**EXHIBIT "A"**

**LEGAL DESCRIPTION**

ESCROW NO.: 030102745

Lot 21, Block O, as shown on the map of GARDNERVILLE RANCHOS UNIT NO. 4, filed in the office of the County Recorder of Douglas County, Nevada, on April 10, 1967, as Document No. 35914.

Assessors Parcel No. 1220-15-410-042

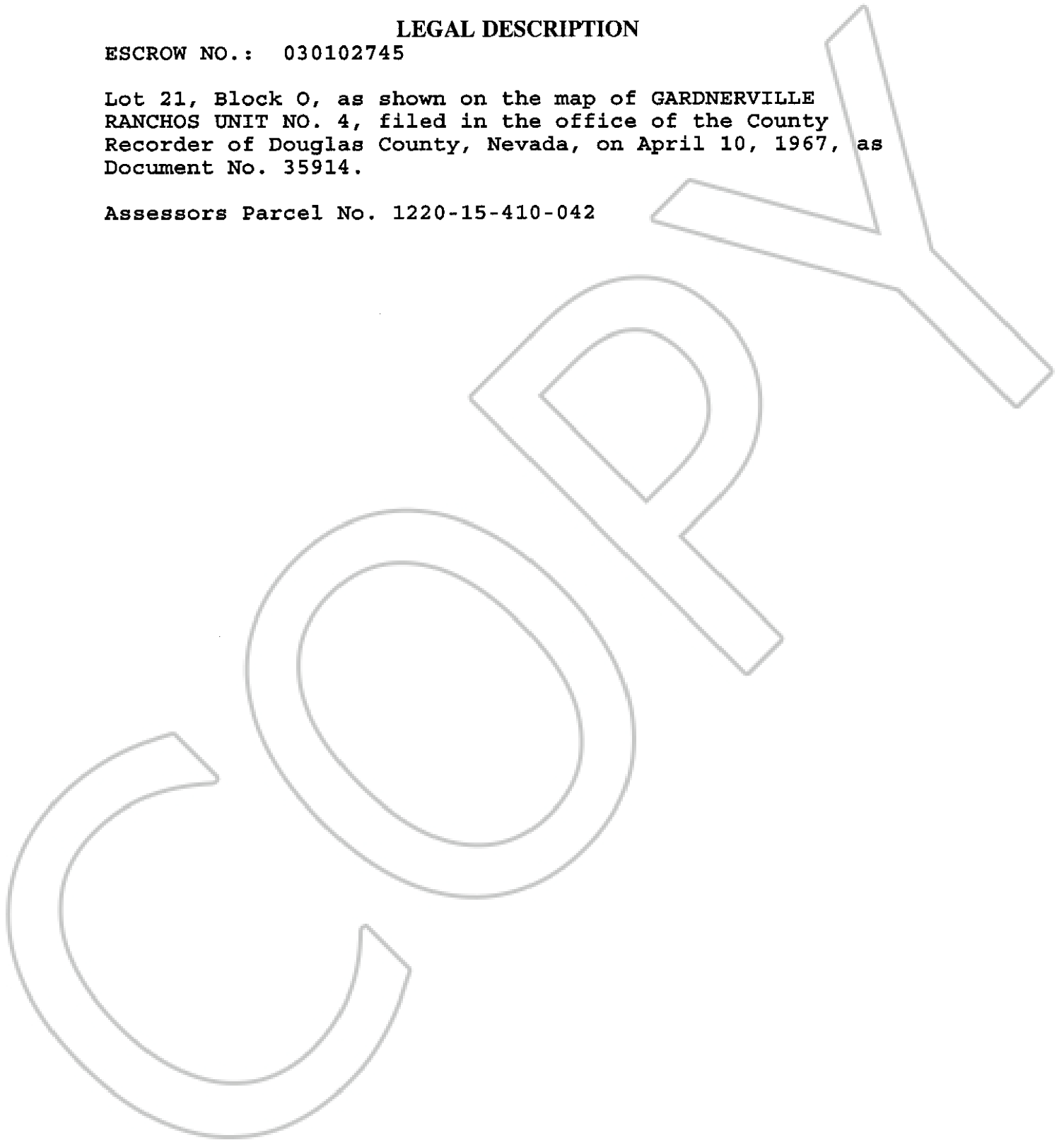

**0585858**

**BK0803PG04113**