

APN: 1320-33-816-010
RPTT \$309.40

REQUESTED BY
WESTERN TITLE COMPANY, INC.
IN OFFICIAL RECORDS OF
DOUGLAS CO., NEVADA

2003 AUG 12 PM 12:06

WERNER CHRISTEN
RECORDER

\$15.00 PAID kg DEPUTY

WHEN RECORDED MAIL TO:

Name BRUCE R. SUTHERLAND
Street 9555 EDWARD CT
Address
City,State GRANITE BAY, CA 95746
Zip

MAIL TAX STATEMENTS TO:

Name BRUCE R. SUTHERLAND
Street 9555 EDWARD CT
Address
City,State GRANITE BAY, CA 95746
Zip
Order 00088677-201- SLG
No.

(SPACE ABOVE THIS LINE FOR RECORDERS USE)

GRANT, BARGAIN AND SALE DEED

THIS INDENTURE WITNESSETH: That

FOR A VALUABLE CONSIDERATION, receipt of which is hereby acknowledged, CLASSIC HOMES LLC, Nevada Limited Liability Company, do(es) hereby GRANT(s) BARGAIN SELL and CONVEY to BRUCE R. SUTHERLAND and PAMELA T. SUTHERLAND, husband and wife, as joint tenants

and to the heirs and assigns of such Grantee forever, all the following real property situated in the City of _____, County of Douglas, State of Nevada bounded and described as follows:

See Exhibit A attached hereto and made a part hereof.

TOGETHER with all tenements, hereditaments and appurtenances, if any, thereto belonging or appertaining, and any reversions, remainders, rents, issues or profits thereof.

Dated: July 12, 2003

STATE OF California
COUNTY OF Placer

CLASSIC HOMES LLC

[Signature]
Bruce R. Sutherland

This instrument was acknowledged before me on

July 18, 2003
by Douglas M. Sutherland

[Signature]
Notary Public

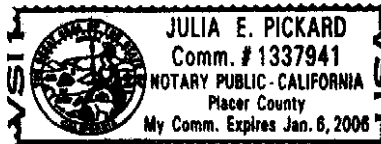

0586183

BK0803PG05416

Exhibit A

All that real property situate in the County of Douglas, State of Nevada, described as follows:

Lot **10**, in Block **A**, as shown on the Final Subdivision Map # 1006-6 of **Chichester Estates Phase 11**, filed for record in the office of the County Recorder of Douglas County, State of Nevada, on December 27, 2002, in Book 1202, Page 12732, as Document No. 562225, and amended by Certificate of Amendment, recorded March 27, 2003, in Book 0303, Page 13037, as Document No. 0571430, Official Records of Douglas County, State of Nevada.

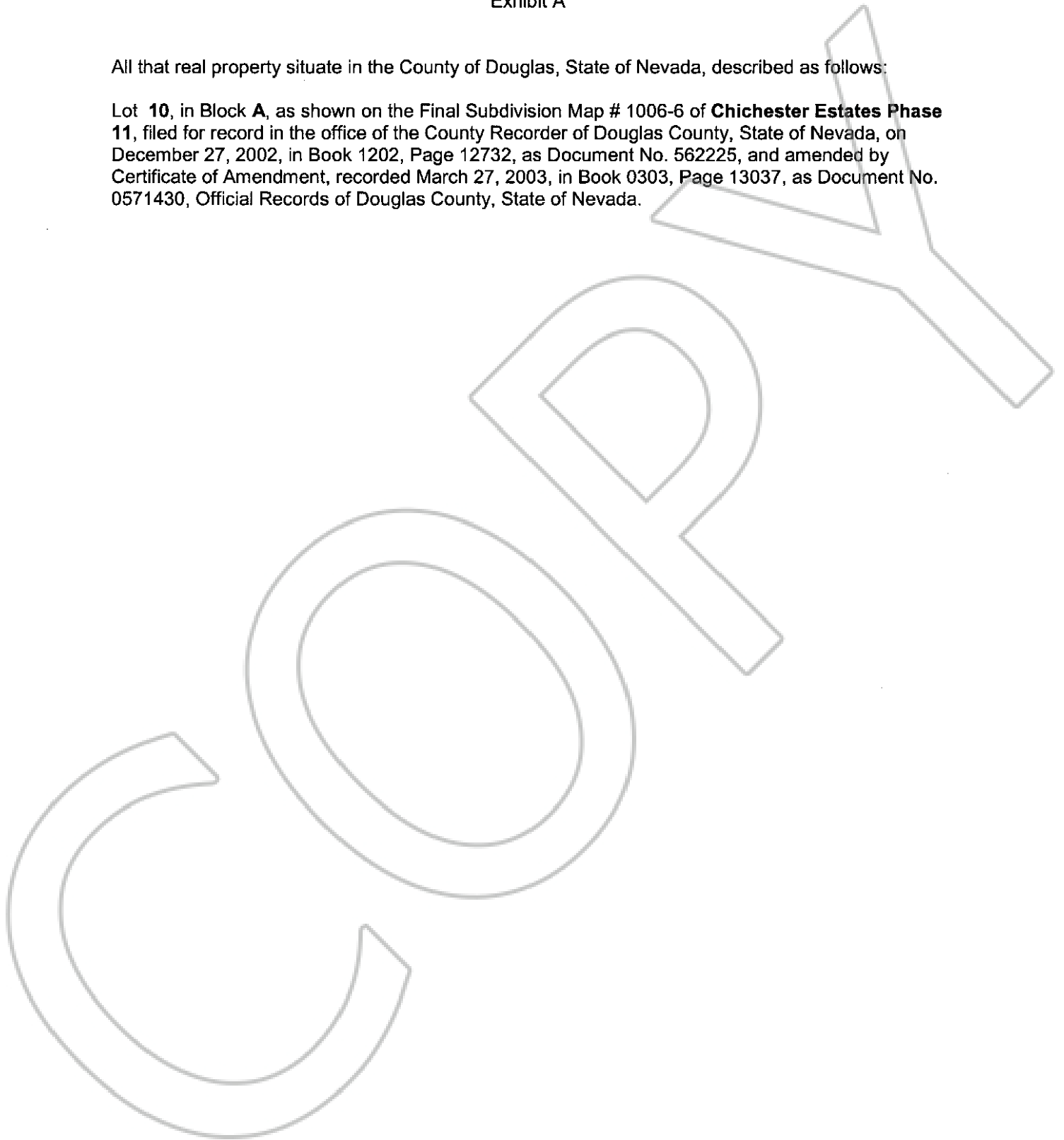

0586183

BK0803PG05417