

EXHIBIT "A"

LEGAL DESCRIPTION

ESCROW NO.: 030701334

A parcel of land located in the South 1/2 of the Northeast 1/4 of Section 4, Township 12 North, Range 20 East, M.D.B.&M., Douglas County, Nevada, more particularly described as follows:

Parcel B2 of Parcel Map LD#00-034 for Lampe Corners Ltd., filed for record in the Office of the Douglas County Recorder on August 23, 2000, in Book 0800, Page 4151, as Document No. 498148.

Assessor's Parcel No. 1220-04-601-013

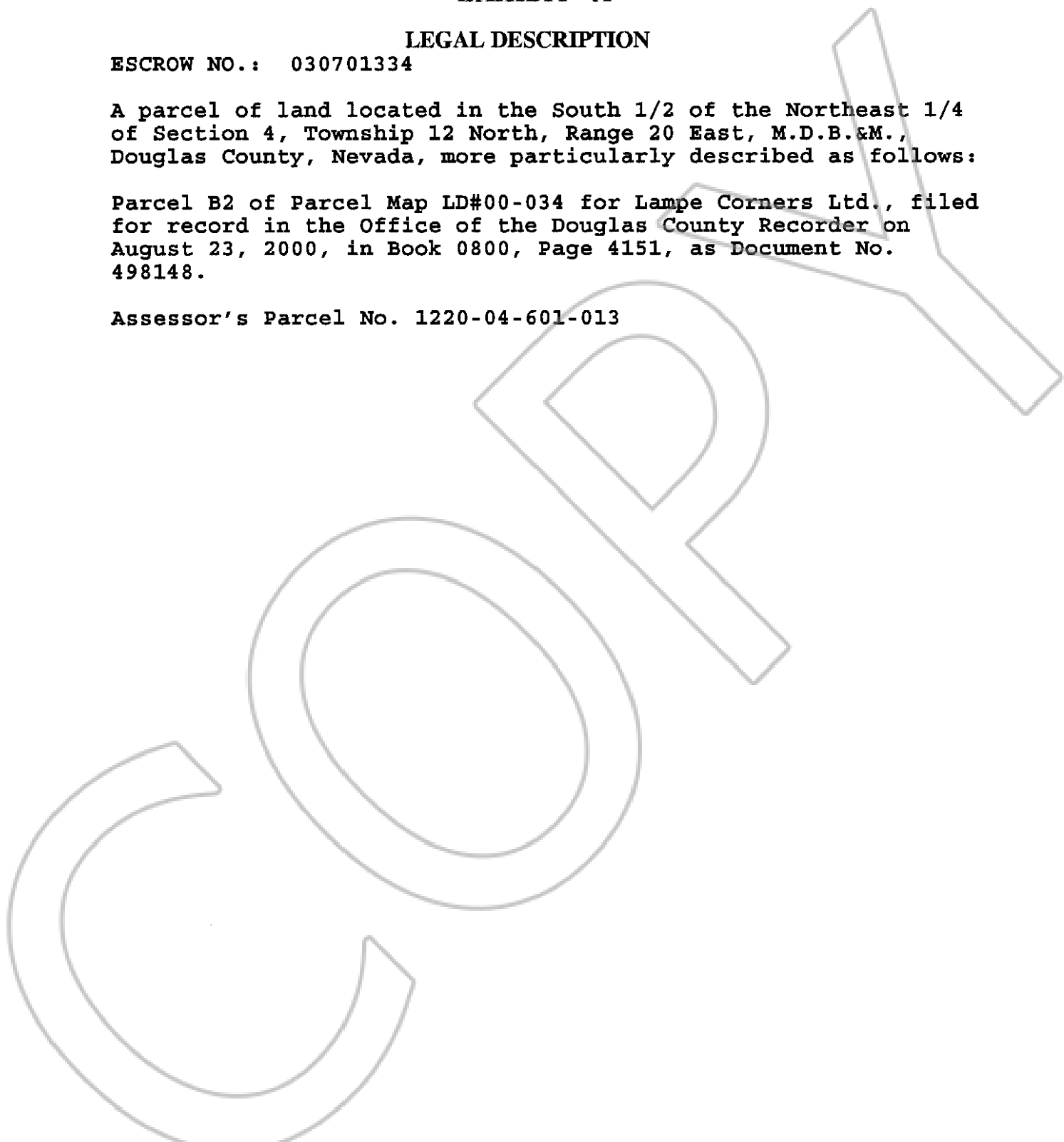

0586619

BK 0803 PG 07710