

EXHIBIT "A"

LEGAL DESCRIPTION

ESCROW NO.: 030802354

Lot 34, Block J, as set forth on the map of Valley Vista Estates I, Phase 1A, filed for record in the Office of the Douglas County Recorder, on June 2, 1994, in Book 694, Page 437, as Document No. 338792, Official Records.

Assessors Parcel No. 1420-07-512-009

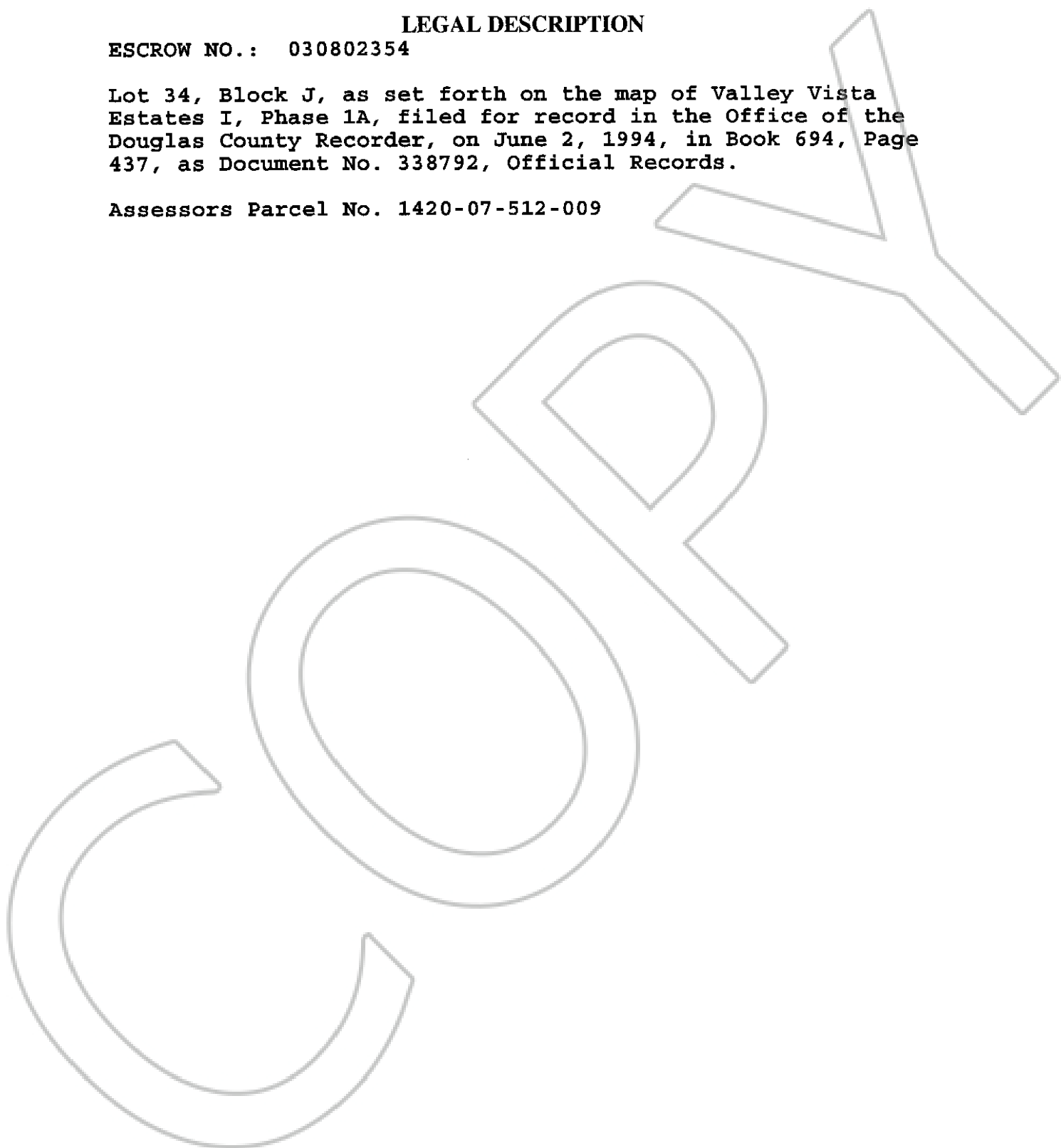

0587099

BK0803PG09843