

A.P.N. # 1022-29-410-008

R.P.T.T. \$ 295.10

ESCROW NO. 030802823

RECORDING REQUESTED BY:  
**STEWART TITLE COMPANY**  
MAIL TAX STATEMENTS TO:  
**SAME AS BELOW**

WHEN RECORDED MAIL TO:  
MR. AND MRS. RHYNER  
P.O. BOX 1041  
FAIR OAKS, CA 95628

REQUESTED BY  
**Stewart Title of Douglas County**  
IN OFFICIAL RECORDS OF  
DOUGLAS CO., NEVADA

2003 AUG 21 AM 10:44

WERNER CHRISTEN  
RECORDER

\$ 15.00 PAID Kg DEPUTY

(Space Above for Recorder's Use Only)

### GRANT, BARGAIN, SALE DEED

THIS INDENTURE WITNESSETH: That **MARJORIE E. GREGORY, SUCCESSOR TRUSTEE OF THE GEORGE GREGORY AND MARJORIE E. GREGORY FAMILY TRUST DATED MARCH 1, 1990**

in consideration of \$10.00<sup>D</sup>, the receipt of which is hereby acknowledged, does hereby Grant, Bargain Sell and Convey to **KEVIN RHYNER and PATRICIA M. RHYNER, husband and wife as joint tenants**

and to the heirs and assigns of such Grantee forever, all that real property situated in the County of **DOUGLAS** State of Nevada, bounded and described as:

**SEE EXHIBIT "A" ATTACHED HERETO AND MADE A PART HEREOF**

Together with all and singular the tenements, hereditaments and appurtenances thereunto belonging or in anywise appertaining, and any reversions, remainders, rents, issues or profits thereof.

DATE: **July 28, 2003**

**THE GEORGE GREGORY AND MARJORIE E. GREGORY FAMILY TRUST DATED MARCH 1, 1990**

BY: *Marjorie E. Gregory*  
**MARJORIE E. GREGORY**  
TRUSTEE

BY: \_\_\_\_\_

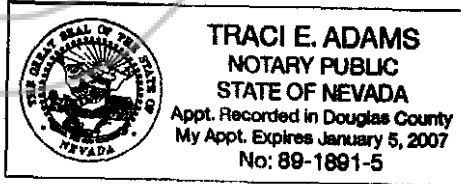

STATE OF Nevada }  
COUNTY OF Douglas } ss.

This instrument was acknowledged before me on 8/1/03  
by, MARJORIE E. GREGORY

Signature *Traci E. Adams*  
Notary Public (One Inch Margin on all sides of Document for Recorders Use Only)

0587301

BK 0803 PG 11147

**EXHIBIT "A"**

**LEGAL DESCRIPTION**

**ESCROW NO.:** 030802823

Lot 115, as set forth on the map of TOPAZ SUBDIVISION, filed in the Office of the County Recorder of Douglas County, State of Nevada, on August 10, 1954, as Document No. 9774.

**Assessors Parcel No.** 1022-29-410-008

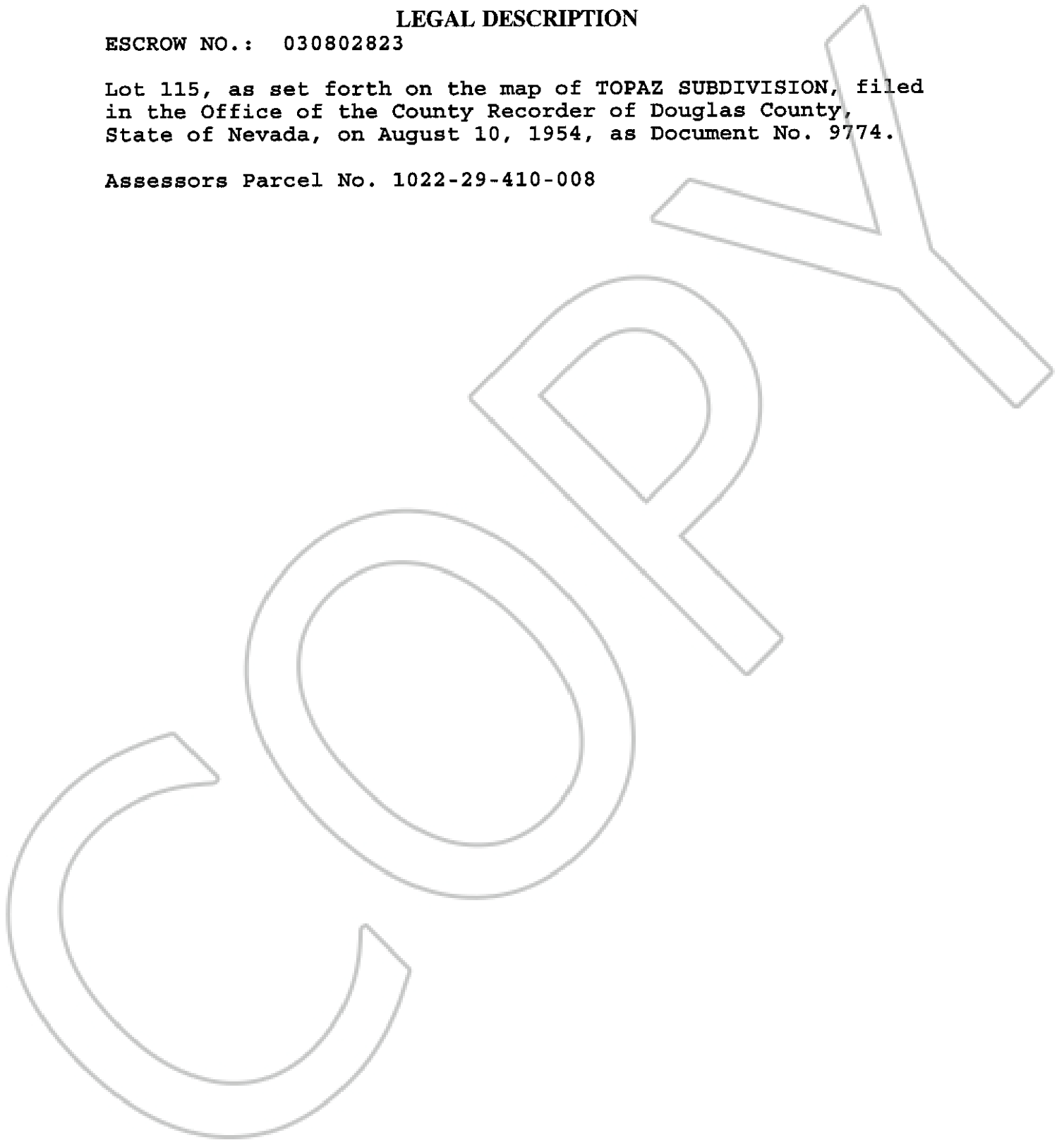

**0587301**

**BK0803PG11148**