

A.P. No. 1320-30-214-001
Escrow No. 61214
Title No. 79300-T0
R.P.T.T. \$ 396.50

REQUESTED BY
TSI TITLE & ESCROW
IN OFFICIAL RECORDS OF
DOUGLAS CO., NEVADA

2003 AUG 21 PM 3:28

WERNER CHRISTEN
RECORDER
\$15.00 PAID *Kg* DEPUTY

WHEN RECORDED MAIL TO:
Maureen Argon
850 Larchwood Way
Minden, NV 89423

MAIL TAX STATEMENT TO:
Maureen Argon
850 Larchwood Way
Minden, NV 89423

GRANT, BARGAIN and SALE DEED

FOR A VALUABLE CONSIDERATION, receipt of which is hereby acknowledged, ERIN A. PELLEGRINO, Successor Trustee of THE SWEENEY REVOCABLE TRUST, dated August 1, 1995 do(es) hereby GRANT, BARGAIN and SELL to MAUREEN E. ARGON, a married woman, as her sole and separate property the real property situate in the County of DOUGLAS, State of Nevada, described as follows:

SEE EXHIBIT "A" ATTACHED HERETO AND MADE A PART HEREOF

ERIN A. PELLEGRINO, Successor Trustee
of THE SWEENEY REVOCABLE TRUST,
dated August 1, 1995

Erin A. Pellegrino
ERIN A. PELLEGRINO,
Successor Trustee

Date: *8-16-03*
California
STATE OF ~~NEVADA~~

COUNTY OF ~~DOUGLAS~~ *El Dorado*

On *8-16-2003* before me, *Lila M Rohrich*
personally appeared *Erin A. Pellegrino*

personally known to me (or proved to me on the basis of satisfactory evidence) to be the person(s) whose name(s) is/are subscribed to the within instrument and acknowledged to me that he/she/they executed the same in his/her/their authorized capacity(ies), and that by his/her/their signature(s) on the instrument the person(s), or the entity upon behalf of which the person(s) acted, executed the instrument.

WITNESS my hand and official seal.

Lila M Rohrich

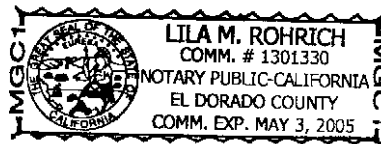

0587359

BK0803PG11521

EXHIBIT "A"

LEGAL DESCRIPTION

ALL THAT REAL PROPERTY SITUATE IN THE COUNTY OF DOUGLAS,
STATE OF NEVADA MORE PARTICULARLY DESCRIBED AS FOLLOWS:

LOT 1, BLOCK C, AS SET FORTH ON THE FINAL MAP OF WESTWOOD
VILLAGE UNIT NO. III AS FILED IN THE OFFICE OF THE COUNTY
RECORDER ON AUGUST 31, 1989, BOOK 889, PAGE 4564 AS
DOCUMENT NO. 209883, OFFICIAL RECORDS OF OF DOUGLAS
COUNTY, NEVADA

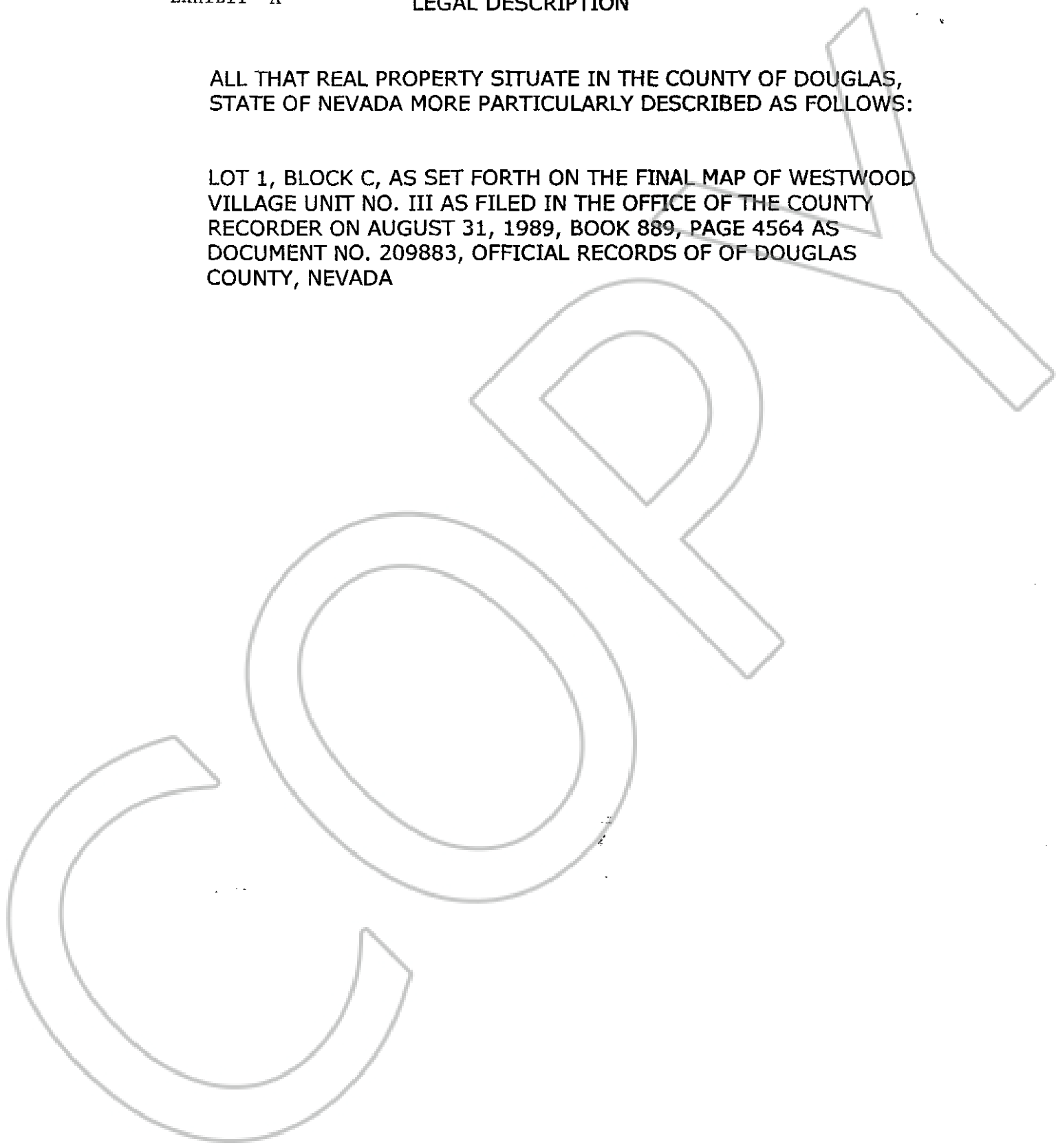

0587359

BK 0803 PG 11522