

A.P.N. # 1022-10-001-084

R.P.T.T. \$ 161.20
ESCROW NO. 030802815

RECORDING REQUESTED BY:
STEWART TITLE COMPANY
MAIL TAX STATEMENTS TO:
SAME AS BELOW

WHEN RECORDED MAIL TO:
GRANTEE
1200 SPATTER CONE ROAD
WELLINGTON, NV 89444

REQUESTED BY
Stewart Title of Douglas County
IN OFFICIAL RECORDS OF
DOUGLAS CO., NEVADA

2003 AUG 22 PM 2: 14

WERNER CHRISTEN
RECORDER
\$15⁰⁰ PAID *KJ* DEPUTY

(Space Above for Recorder's Use Only)

GRANT, BARGAIN, SALE DEED

THIS INDENTURE WITNESSETH: That **KRISTIN J. RATH**

in consideration of \$10.00, the receipt of which is hereby acknowledged, does hereby Grant, Bargain Sell and Convey to **JACK HABERMAN and JENNIFER MUNDT**, BOTH UNMARRIED PERSONS AS JOINT TENANTS

and to the heirs and assigns of such Grantee forever, all that real property situated in the County of **Douglas** State of Nevada, bounded and described as:

SEE EXHIBIT "A" ATTACHED HERETO AND MADE A PART HEREOF

Together with all and singular the tenements, hereditaments and appurtenances thereunto belonging or in anyway appertaining, and any reversions, remainders, rents, issues or profits thereof.

DATE: July 31, 2003

Kristin J. Rath
KRISTIN J. RATH

 CHARLENE L. HANOVER
NOTARY PUBLIC
STATE OF NEVADA
Appt. Recorded in Douglas County
My Appt. Expires February 3, 2007
No: 98-2565-5

STATE OF NEVADA }
 } ss.
COUNTY OF DOUGLAS }

This instrument was acknowledged before me on 8/8/2003,
by KRISTIN J. RATH

Signature *Charlene L. Hanover*
Notary Public (One inch margin on all sides of document for Recorder's Use Only)

0587506

BK0803PG12367

EXHIBIT "A"

LEGAL DESCRIPTION

ESCROW NO.: 030802815

Lot 48, as shown on the map of TOPAZ RANCH ESTATES UNIT NO. 2, filed in the Office of the County Recorder of Douglas County, Nevada, on February 20, 1967, as Document No. 35464.

Assessor's Parcel No. 1022-10-001-084.

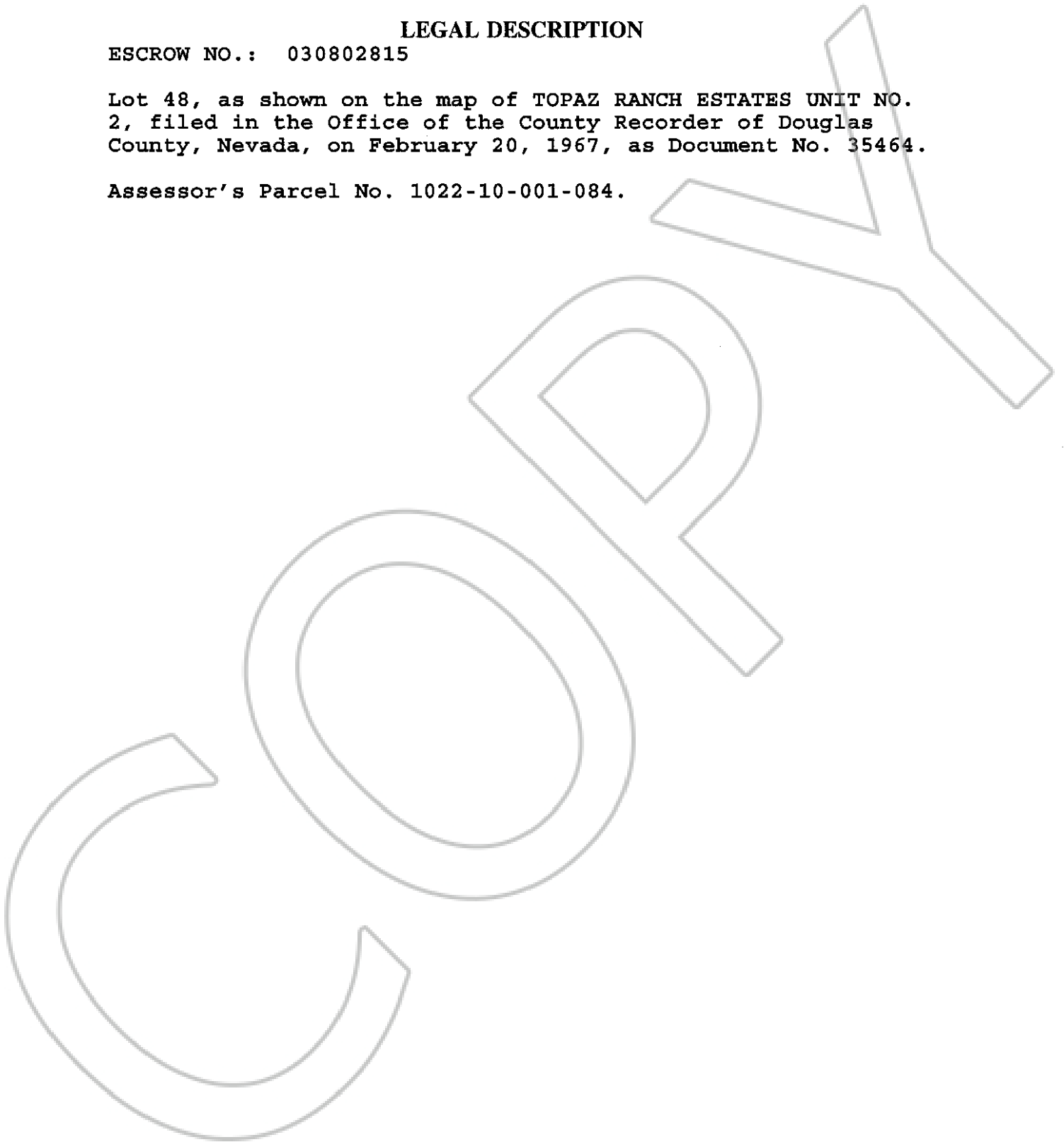

0587506

BK0803PG12368