

A.P.N. # 1318-23-812-003

R.P.T.T. \$ 487.50
ESCROW NO. 030202510

RECORDING REQUESTED BY:
STEWART TITLE COMPANY

MAIL TAX STATEMENTS TO:
SAME AS BELOW
*306 View Crest Rd.
Glendale, CA 91202*
WHEN RECORDED MAIL TO:
MR. AND MRS. TATE
*306 View Crest Rd.
Glendale, CA 91202*

REQUESTED BY
Stewart Title of Douglas County
IN OFFICIAL RECORDS OF
DOUGLAS CO., NEVADA

2003 AUG 27 PM 3:35

WERNER CHRISTEN
RECORDER

\$ 15⁰⁰ PAID Bl DEPUTY

(Space Above for Recorder's Use Only)

GRANT, BARGAIN, SALE DEED

THIS INDENTURE WITNESSETH: That **MARK ASHTON AND CHARLENE ASHTON,**
HUSBAND AND WIFE

in consideration of \$10.00, the receipt of which is hereby acknowledged, does hereby Grant, Bargain Sell
and Convey to **THOMAS TATE AND SUE ANN TATE, HUSBAND AND WIFE**
AS JOINT TENANTS

SEAL

and to the heirs and assigns of such Grantee forever, all that real property situated in the
unincorporated area County of **DOUGLAS** State of Nevada, bounded and described as:
SEE EXHIBIT "A" ATTACHED HERETO AND MADE A PART HEREOF

Together with all and singular the tenements, hereditaments and appurtenances thereunto belonging or in
anywise appertaining, and any reversions, remainders, rents, issues or profits thereof.

DATE: **July 17, 2003**

Mark Ashton 8/11/2003

MARK ASHTON
Charlene Ashton 8/11/2003

CHARLENE ASHTON

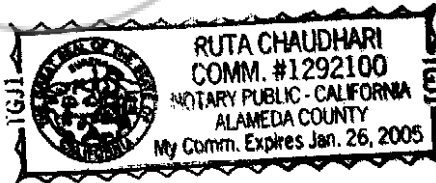
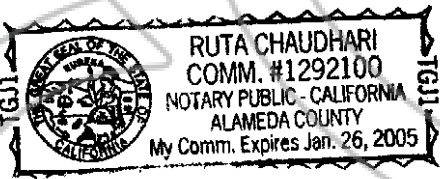

Re: *California*
STATE OF NEVADA }
Re: Alameda Co. }
COUNTY OF DOUGLAS }

This instrument was acknowledged before me on 11th August 2003
by MARK ASHTON and CHARLENE ASHTON

Signature *Ruta Chaudhari*
Notary Public (One inch margin on all sides of document for Recorder's Use Only)

0587989
BK0803PG15203

EXHIBIT "A"

LEGAL DESCRIPTION

ESCROW NO.: 030202510

Lot 6, Block A, as shown on the Official Map of KINGSBURY HEIGHTS SUBDIVISION filed in the Office of the County Recorder of Douglas County, State of Nevada, on August 5, 1959, as Document No. 14738.

Assessors Parcel No. 1318-23-812-003

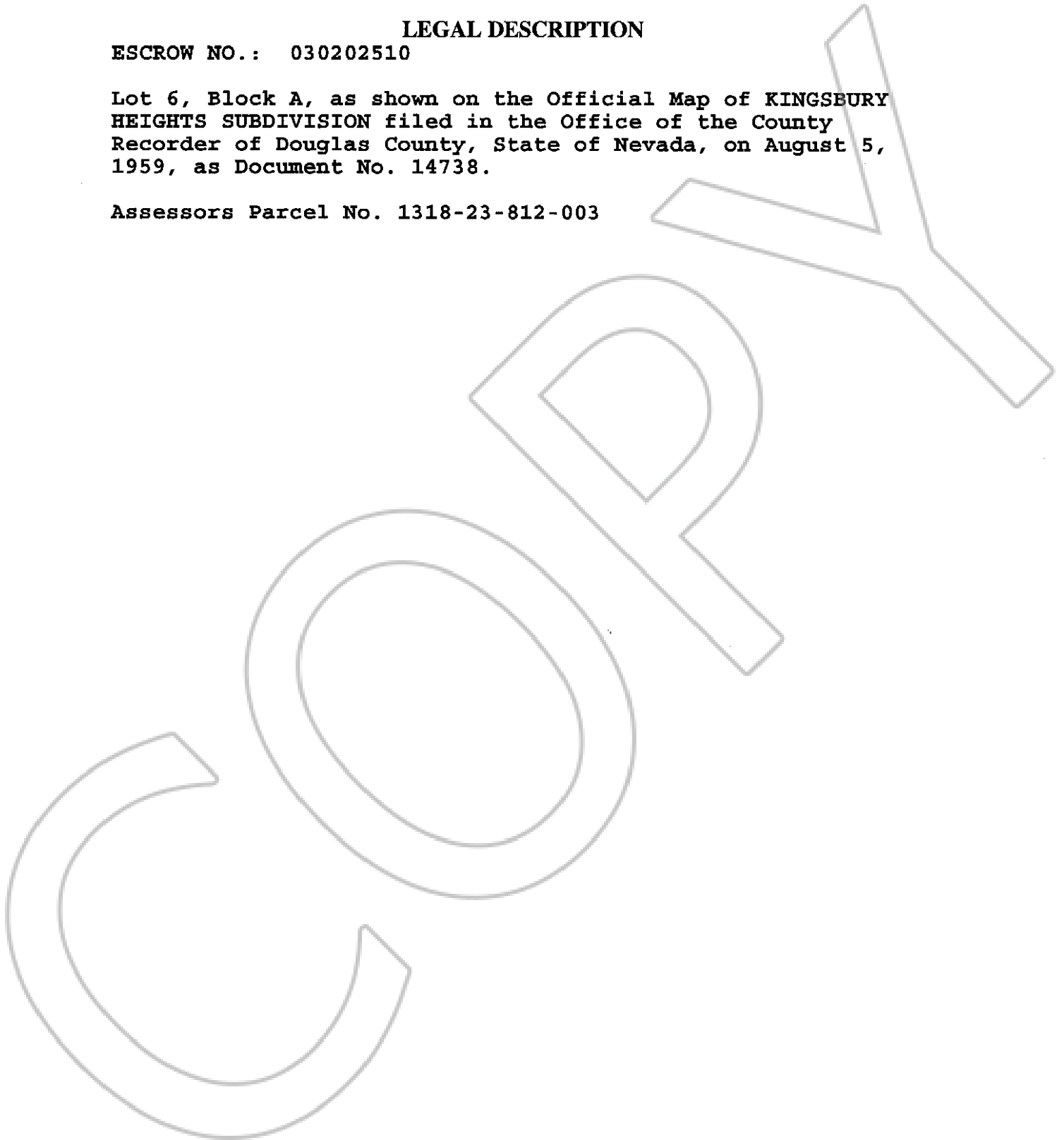

0587989

BK0803PG15204