

A.P.N. # 1220-09-810-002

R.P.T.T. \$ 318.50

ESCROW NO. 030103056

RECORDING REQUESTED BY:
STEWART TITLE COMPANY

MAIL TAX STATEMENTS TO:
SAME AS BELOW

WHEN RECORDED MAIL TO:
GRANTEE
1007 TILLMAN LANE
GARDNERVILLE, NV 89460

REQUESTED BY
Stewart Title of Douglas County
IN OFFICIAL RECORDS OF
DOUGLAS CO., NEVADA

2003 AUG 27 PM 3: 58

WERNER CHRISTEN
RECORDER

\$ 1500 PAID BC DEPUTY

(Space Above for Recorder's Use Only)

GRANT, BARGAIN, SALE DEED

THIS INDENTURE WITNESSETH: That **LISA A. WETZEL, SPECIAL ADMINISTRATOR** of the Estate of **JESSIE LEE WORDEN, Deceased**

in consideration of \$10.00, the receipt of which is hereby acknowledged, does hereby Grant, Bargain Sell and Convey to **CARLA J. WETZEL, an unmarried woman**

and to the heirs and assigns of such Grantee forever, all that real property situated in the County of **Douglas** State of Nevada, bounded and described as:

SEE EXHIBIT "A" ATTACHED HERETO AND MADE A PART HEREOF

Together with all and singular the tenements, hereditaments and appurtenances thereunto belonging or in anywise appertaining, and any reversions, remainders, rents, issues or profits thereof.

DATE: **August 20, 2003** **THE ESTATE OF JESSIE LEE WORDEN, DECEASED**

BY: *Lisa A. Wetzel*
LISA A. WETZEL
SPECIAL ADMINISTRATOR

BY: _____

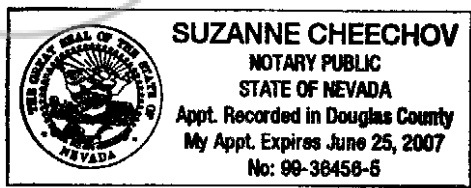

STATE OF NV }
COUNTY OF Douglas } ss.

This instrument was acknowledged before me on 8/26/03
by LISA A. WETZEL

Signature *Suzanne Cheechov*
Notary Public (One Inch Margin on all sides of Document for Recorders Use Only)

0588004
BK0803PG15363

EXHIBIT "A"

LEGAL DESCRIPTION

ESCROW NO.: 030103056

Lot 239, as said lot is shown on the Official Plat of GARDNERVILLE RANCHOS UNIT NO. 2, filed in the office of the County Recorder of Douglas County, Nevada, on June 1, 1965, in Book 1 of Maps, filed as No. 28309, and Title Sheet amended on June 4, 1965, as Filing No. 28377.

Assessor's Parcel No. 1220-09-810-002

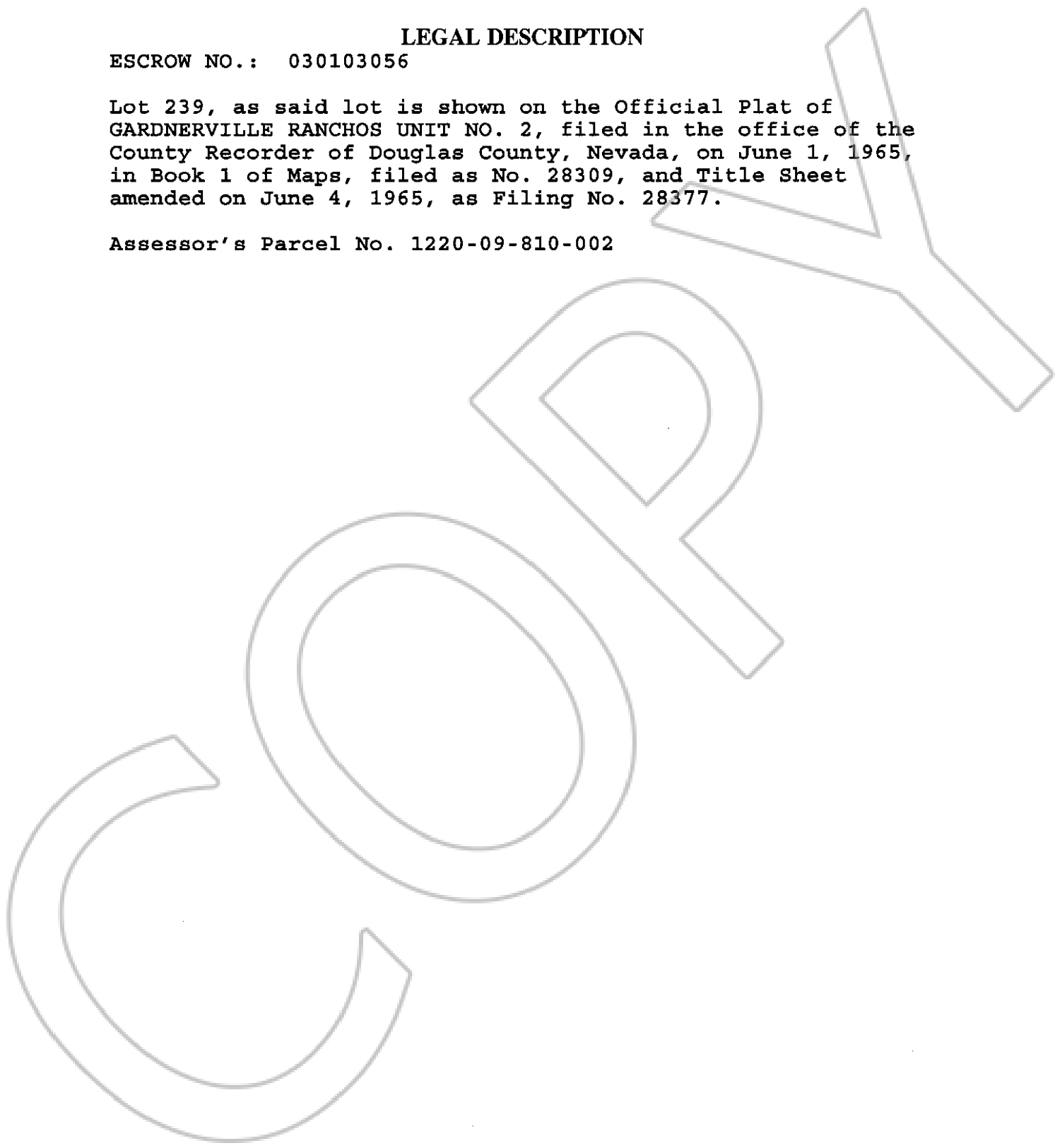

0588004

BK0803PG15364