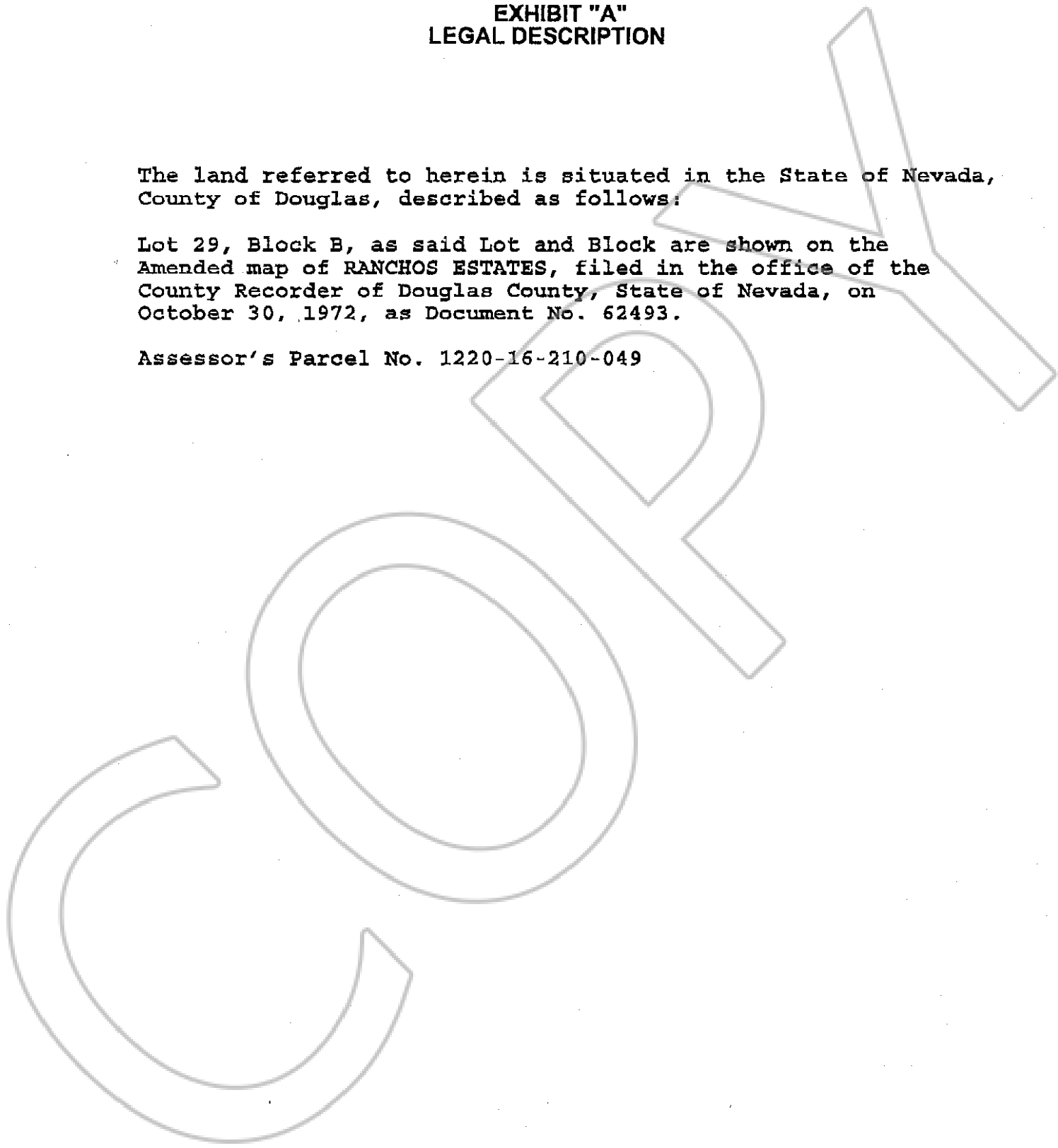

**EXHIBIT "A"
LEGAL DESCRIPTION**

The land referred to herein is situated in the State of Nevada,
County of Douglas, described as follows:

Lot 29, Block B, as said Lot and Block are shown on the
Amended map of RANCHOS ESTATES, filed in the office of the
County Recorder of Douglas County, State of Nevada, on
October 30, 1972, as Document No. 62493.

Assessor's Parcel No. 1220-16-210-049



0588278
BK0803PG16676