

A.P.N. # 1220-22-110-131

R.P.T.T. \$ 371.80

ESCROW NO. 030802824

RECORDING REQUESTED BY:
STEWART TITLE COMPANY
MAIL TAX STATEMENTS TO:
SAME AS BELOW

WHEN RECORDED MAIL TO:
GRANTEE
740 MAMMOTH WAY
GARDNERVILLE, NV 89460

REQUESTED BY
Stewart Title of Douglas County

IN OFFICIAL RECORDS OF
DOUGLAS CO., NEVADA

2003 SEP -3 AM 10:42

WERNER CHRISTEN
RECORDER

\$15.00 PAID Be DEPUTY

(Space Above for Recorder's Use Only)

GRANT, BARGAIN, SALE DEED

THIS INDENTURE WITNESSETH: That **RAYMOND E. COOPER AND SHARON LEE COOPER, Trustees, or Successor Trustee(s)** of the **COOPER FAMILY TRUST DATED JUNE 4, 2002**

in consideration of \$10.00, the receipt of which is hereby acknowledged, does hereby Grant Bargain Sell and Convey to **ROBERT/HILLMAN and PATRICIA/HILLMAN, TRUSTEES OF THE ROBERT S. HILLMAN AND PATRICIA M. HILLMAN TRUST DATED NOVEMBER 4, 1998**

and to the heirs and assigns of such Grantee forever, all that real property situated in the County of **Douglas** State of Nevada, bounded and described as:

SEE EXHIBIT "A" ATTACHED HERETO AND MADE A PART HEREOF

Together with all and singular the tenements, hereditaments and appurtenances thereunto belonging or in anywise appertaining, and any reversions, remainders, rents, issues or profits thereof.

DATE: **August 08, 2003** **COOPER FAMILY TRUST**
DATED JUNE 4, 2002

BY: Raymond E. Cooper TRUSTEE
RAYMOND E. COOPER
TRUSTEE

BY: Sharon Lee Cooper TRUSTEE
SHARON LEE COOPER
TRUSTEE

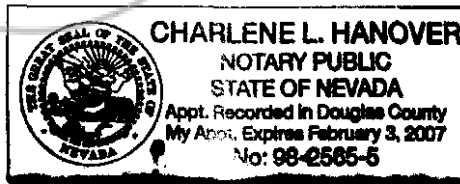

STATE OF NEVADA }
 } ss.
COUNTY OF DOUGLAS }

This instrument was acknowledged before me on 8/15/2003,
by RAYMOND E. COOPER and SHARON LEE
COOPER

Signature Charlene L Hanover
Notary Public (One Inch Margin on all sides of Document for Recorders Use Only)

0588560

BK0903PG00899

EXHIBIT "A"

LEGAL DESCRIPTION

ESCROW NO.: 030802824

Lot 101, as shown on the Official map of GARDNERVILLE RANCHOS UNIT NO. 5, filed for record on November 4, 1970 in the office of the County Recorder of Douglas County, Nevada, as Document No. 50056.

Assessor's Parcel No. 1220-22-110-131

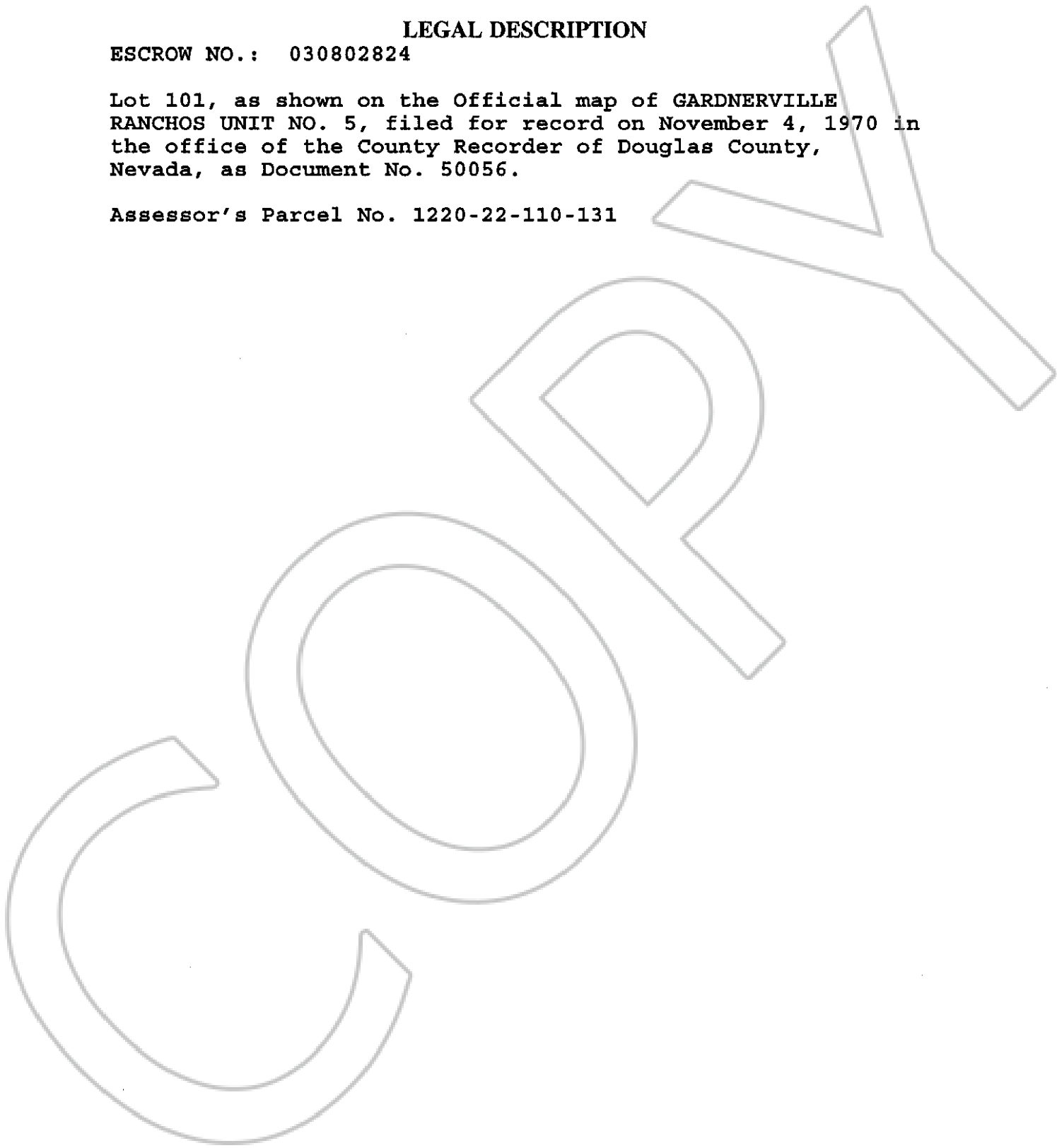

0588560

BK0903PG00900