

EXHIBIT "A"

LEGAL DESCRIPTION

ESCROW NO.: 030802813

Lot 224, Block E, as shown on the Final Map #PD99-02-04 for SARATOGA SPRINGS ESTATES UNIT NO. 4, A PLANNED UNIT DEVELOPMENT, recorded in the Office of the County Recorder of Douglas County, Nevada, on May 19, 2000, in Book 0500, Page 4445, as Document No. 492337, and as shown on Certificate of Amendment recorded November 30, 2000, in Book 1100, Page 6042, as Document No. 504169.

ASSESSOR'S PARCEL NO. 1420-28-113-010

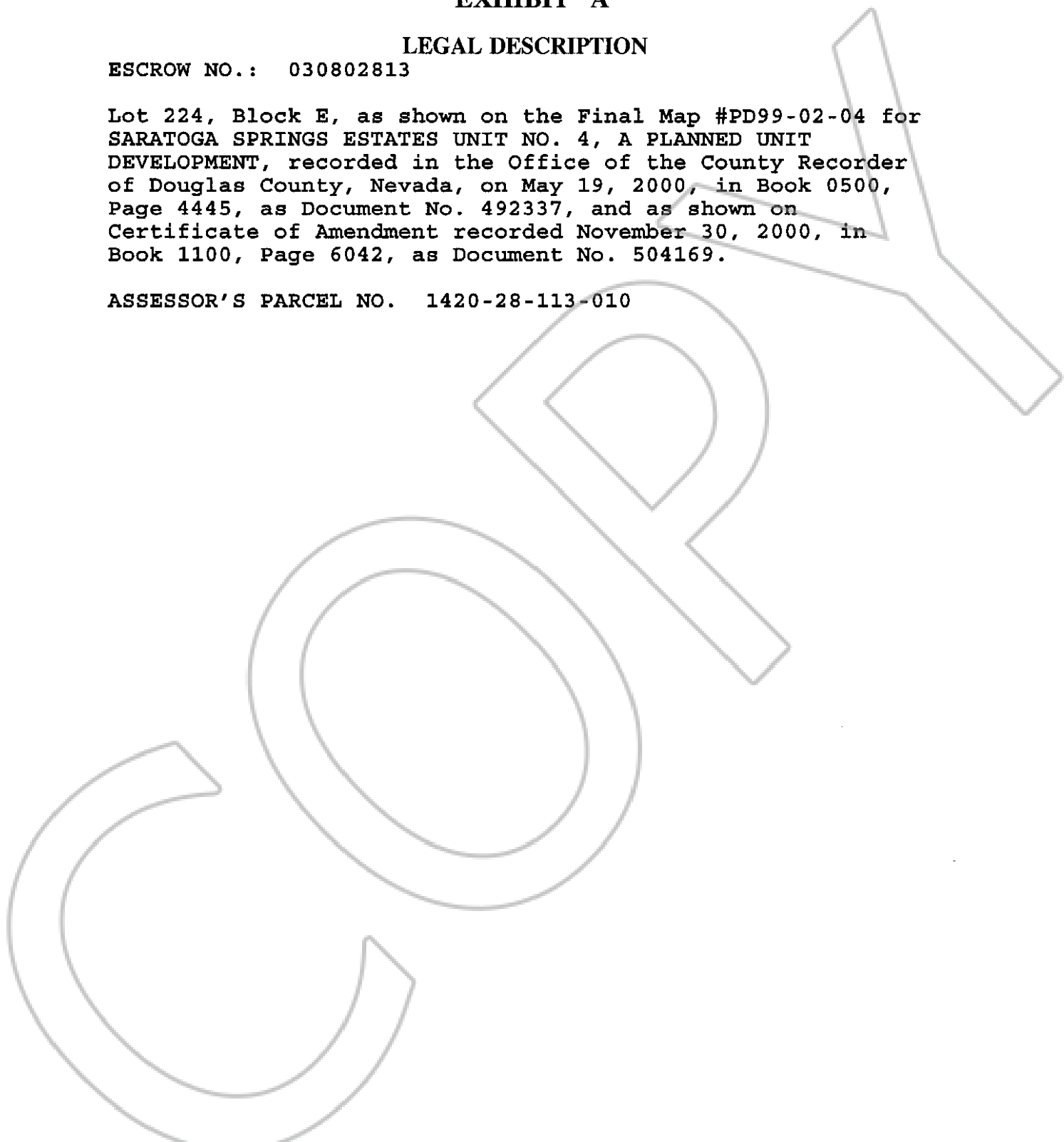

0588842

BK0903PG01988