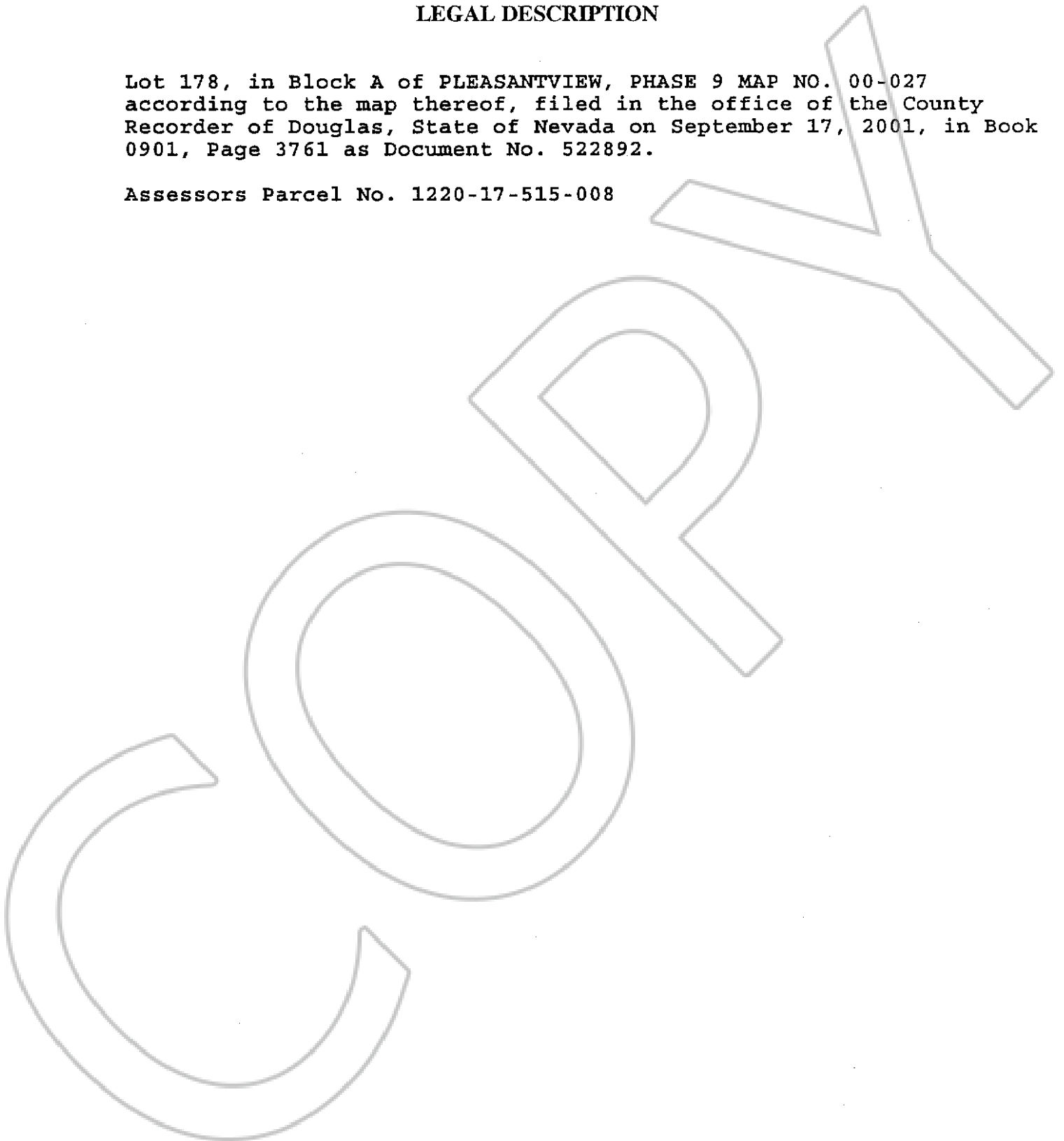

EXHIBIT "A"

LEGAL DESCRIPTION

Lot 178, in Block A of PLEASANTVIEW, PHASE 9 MAP NO. 00-027
according to the map thereof, filed in the office of the County
Recorder of Douglas, State of Nevada on September 17, 2001, in Book
0901, Page 3761 as Document No. 522892.

Assessors Parcel No. 1220-17-515-008



0588916

BK0903PG02331