



**EXHIBIT "A"**

**LEGAL DESCRIPTION**

**ESCROW NO.: 030202973**

Parcel 10-G as shown on Parcel Map #3 for K.D.T. Inc., being a division of Parcel 10 on Land division Map for G.S.F. Development Co. as Document No. 34176, filed for record in the office of the Douglas County Recorder, State of Nevada on May 31, 1995 in Book 595, Page 4986 as Document No. 363200, Official Records.

**Assessors Parcel No. 1220-01-001-052**

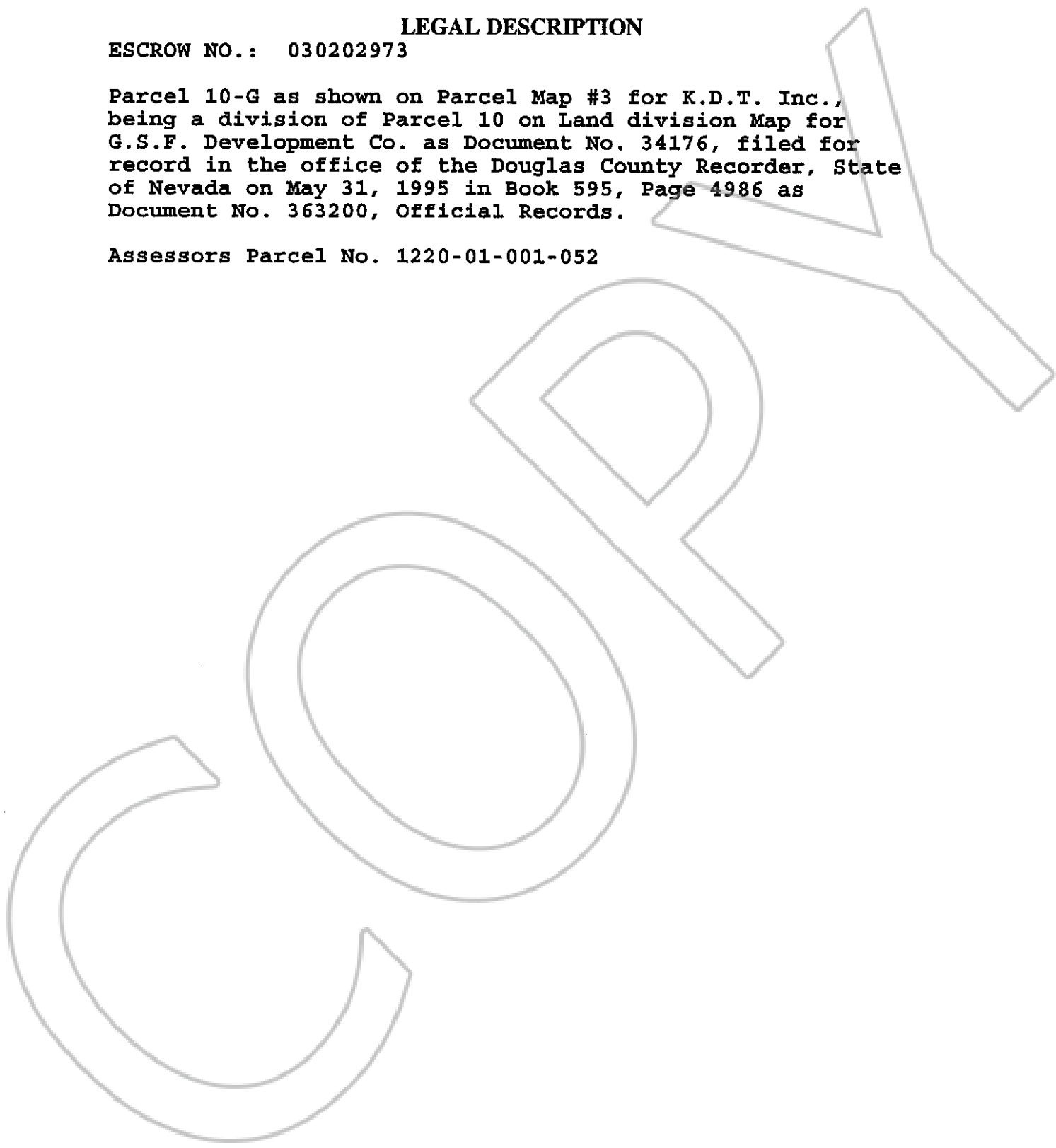

**0589154**

**BK0903PG03548**