

A.P.N. # 1319-10-111-027

R.P.T.T. \$ 292.50  
ESCROW NO. 030703088

RECORDING REQUESTED BY:  
**STEWART TITLE COMPANY**  
MAIL TAX STATEMENTS TO:  
**SAME AS BELOW**

WHEN RECORDED MAIL TO:  
**GRANTEE**  
**346 PALIKU STREET**  
**HONOLULU, HI 96825-2341**

(Space Above for Recorder's Use Only)

REQUESTED BY  
**Stewart Title of Douglas County**  
IN OFFICIAL RECORDS OF  
DOUGLAS CO., NEVADA

2003 SEP -9 AM 11: 58

WERNER CHRISTEN  
RECORDER

\$15<sup>00</sup> PAID KJ DEPUTY

**GRANT, BARGAIN, SALE DEED**

THIS INDENTURE WITNESSETH: That **JEFF J. WHITE and MARIE A. WHITE,**  
Trustees of the **JEFF J. WHITE FAMILY TRUST** DATED DECEMBER  
1, 1979

in consideration of \$10.00, the receipt of which is hereby acknowledged, does hereby Grant, Bargain Sell  
and Convey to **ALLEN J. HAYES and MELANIE A. HAYES, husband and**  
**wife, as Joint Tenants with right of survivorship**

and to the heirs and assigns of such Grantee forever, all that real property situated in the  
County of **Douglas** State of Nevada, bounded and described as:

**SEE EXHIBIT "A" ATTACHED HERETO AND MADE A PART HEREOF**

Together with all and singular the tenements, hereditaments and appurtenances thereunto belonging or in  
anywise appertaining, and any reversions, remainders, rents, issues or profits thereof.

DATE: August 13, 2003      **JEFF J. WHITE FAMILY TRUST**  
DATED DECEMBER 1, 1979

BY: *Jeff J. White*  
**JEFF J. WHITE**  
TRUSTEE

BY: *Marie A. White*  
**MARIE A. WHITE**  
TRUSTEE

STATE OF Nevada }  
  } SS.  
COUNTY OF Clark }

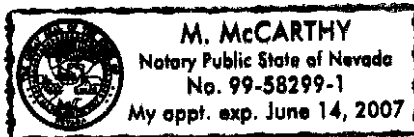

This instrument was acknowledged before me on Sept 5, 2003,  
by, **JEFF J. WHITE and MARIE A. WHITE**

Signature *PJ McCarthy*  
Notary Public (One Inch Margin on all sides of Document for Recorders Use Only)

0589240  
BK0903PG04056

**EXHIBIT "A"**

**LEGAL DESCRIPTION**

**ESCROW NO.: 030703088**

**Lot 121 as set forth on the final map of GENOA LAKES PHASE  
3 UNIT 2, A Planned Unit Development, recorded May 1, 1995,  
in Book 595 of Official Records at Page 78, Douglas County,  
Nevada, as Document No. 361251.**

**Assessors Parcel No. 1319-10-111-027**

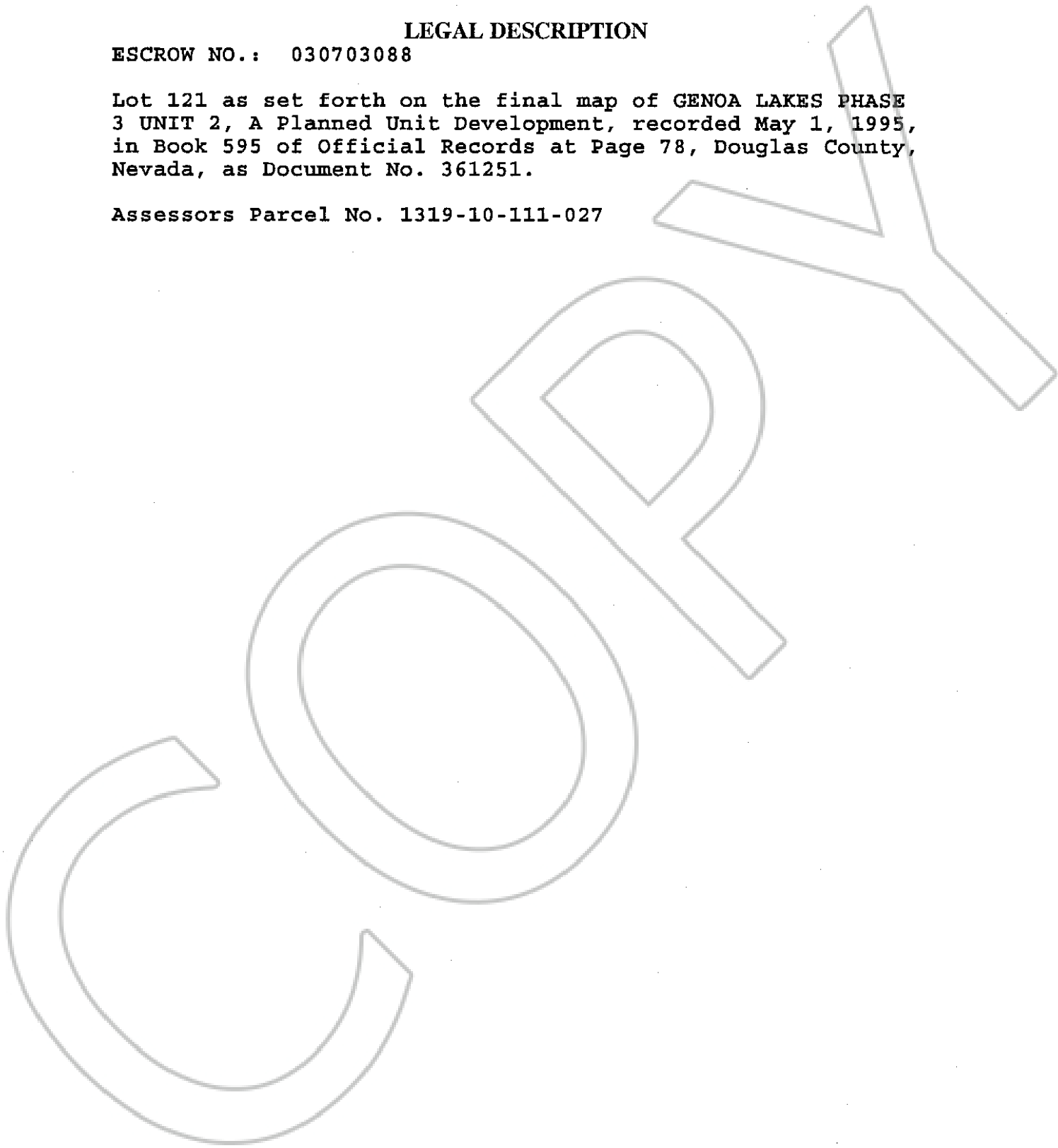

**0589240**

**BK0903PG04057**