

A.P.N. # 1219-03-001-042

R.P.T.T. \$ ~~737.10~~ 734.50 *we*
ESCROW NO. 030103312

RECORDING REQUESTED BY:
STEWART TITLE COMPANY
MAIL TAX STATEMENTS TO:
SAME AS BELOW

WHEN RECORDED MAIL TO:
GRANTEE
236 PEACH COURT
GARDNERVILLE, NV 89410

REQUESTED BY
Stewart Title of Douglas County
IN OFFICIAL RECORDS OF
DOUGLAS CO., NEVADA

2003 SEP 11 AM 11:00

WERNER CHRISTEN
RECORDER

\$15⁰⁰ PAID *BH* DEPUTY

(Space Above for Recorder's Use Only)

GRANT, BARGAIN, SALE DEED

THIS INDENTURE WITNESSETH: That **KURT G. CUDDY and LINDA T. CUDDY,**
husband and wife

in consideration of \$10.00, the receipt of which is hereby acknowledged, does hereby Grant, Bargain Sell
and Convey to **DANIEL KAHLER and JUDY KAHLER, husband and wife**
as joint tenants

and to the heirs and assigns of such Grantee forever, all that real property situated in the
County of **Douglas** State of Nevada, bounded and described as:

SEE EXHIBIT "A" ATTACHED HERETO AND MADE A PART HEREOF

Together with all and singular the tenements, hereditaments and appurtenances thereunto belonging or in
anywise appertaining, and any reversions, remainders, rents, issues or profits thereof.

DATE: **September 04, 2003**

Kurt G. Cuddy
KURT G. CUDDY
Linda T. Cuddy
LINDA T. CUDDY

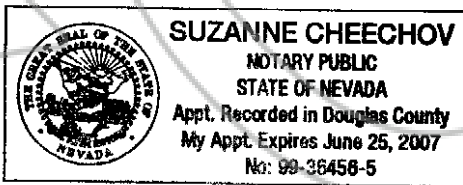

STATE OF NV }
COUNTY OF Douglas } ss

This instrument was acknowledged before me on 9/9/03
by KURT G. CUDDY and LINDA T. CUDDY

Signature *Suzanne Chee*
Notary Public (One inch margin on all sides of document for Recorder's Use Only)

0589614
BK0903PG05579

EXHIBIT "A"

LEGAL DESCRIPTION

ESCROW NO.: 030103312

Situate in the West 1/2 of Section 3, Township 12 North, Range 19 East, M.D.B.&M., more particularly described as follows:

Parcel 1-B, as set forth on Parcel Map #4 for Coldwell Banker Itildo, Inc., filed for record in the Office of the Douglas County Recorder, October 20, 1992, in Book 1092, Page 3274 as Document No. 291152 of Official Records.

Assessors Parcel No. 1219-03-001-042

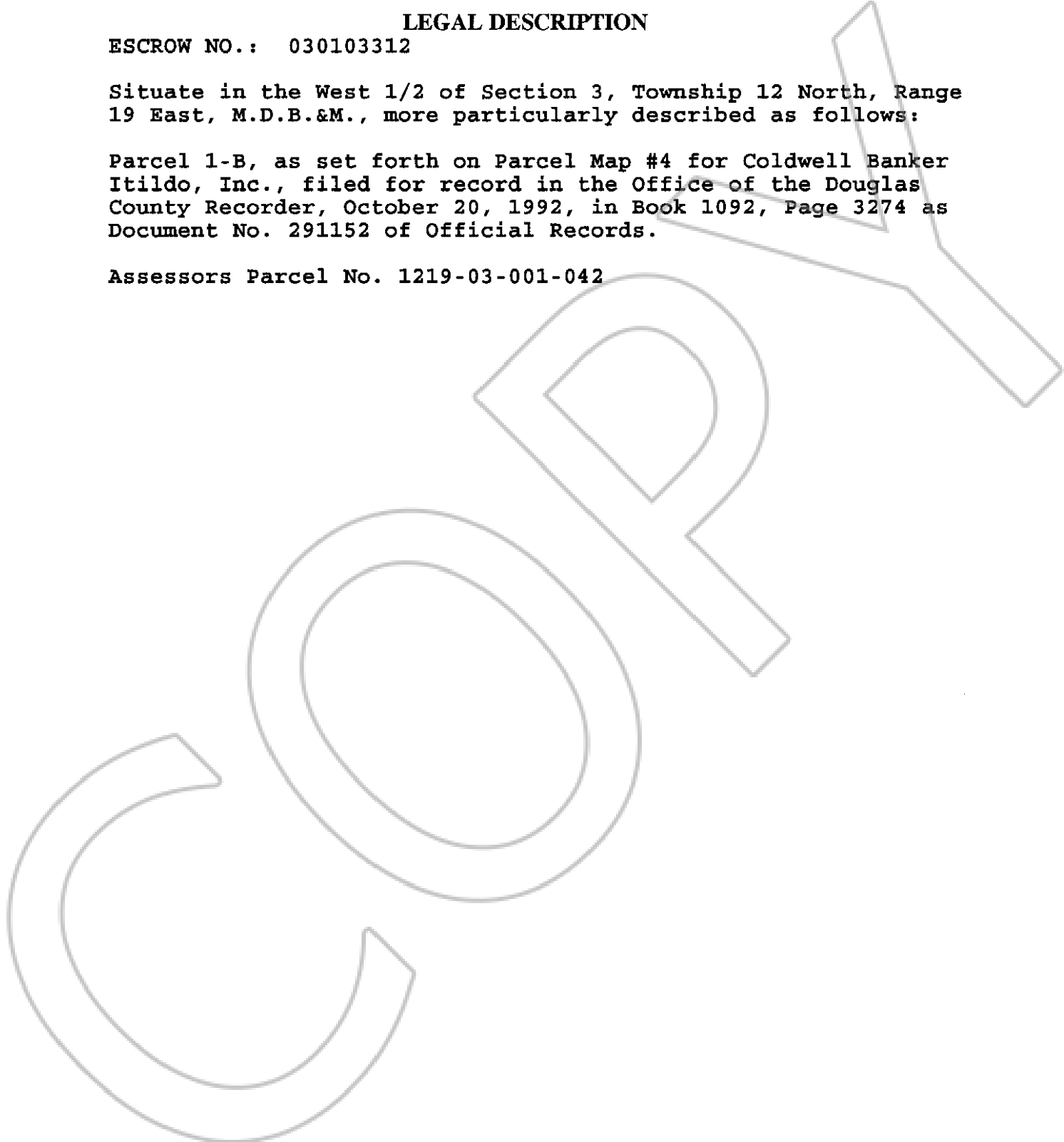

0589614

BK0903PG05580