

A.P.N. # 1420-28-811-024

R.P.T.T. \$ 274.95
ESCROW NO. 030802362

RECORDING REQUESTED BY:
STEWART TITLE COMPANY
MAIL TAX STATEMENTS TO:
SAME AS BELOW
1367 KIM PLACE
MINDEN, NV 89423
WHEN RECORDED MAIL TO:
GRANTEE

REQUESTED BY
Stewart Title of Douglas County
IN OFFICIAL RECORDS OF
DOUGLAS CO., NEVADA

2003 SEP 11 PM 3:23

WERNER CHRISTEN
RECORDER

\$15.00 PAID KJ DEPUTY

(Space Above for Recorder's Use Only)

GRANT, BARGAIN, SALE DEED

THIS INDENTURE WITNESSETH: That **KAREN CARY LARSEN** as Trustees of
the **BILL AND CARY LARSEN TRUST**, DATED JANUARY 13, 1999

in consideration of \$10.00, the receipt of which is hereby acknowledged, does hereby Grant, Bargain Sell
and Convey to **JOHN P. HASKELL**, A MARRIED MAN AS HIS SOLE AND
SEPARATE PROPERTY

and to the heirs and assigns of such Grantee forever, all that real property situated in the
County of **Douglas** State of Nevada, bounded and described as:

SEE EXHIBIT "A" ATTACHED HERETO AND MADE A PART HEREOF

Together with all and singular the tenements, hereditaments and appurtenances thereunto belonging or in
anywise appertaining, and any reversions, remainders, rents, issues or profits thereof.

DATE: **July 10, 2003**

BILL AND CARY LARSEN TRUST,
DATED JANUARY 13, 1999

BY: Karen Cary Larsen, Trustee
KAREN CARY LARSEN
TRUSTEE

BY: _____

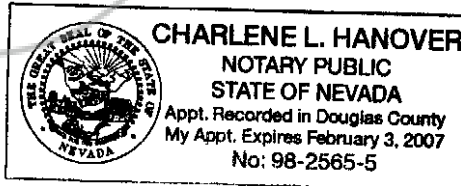

STATE OF NEVADA }
 } SS.
COUNTY OF DOUGLAS }

This instrument was acknowledged before me on 7/28/2003,
by KAREN CARY LARSEN, TRUSTEE

Signature Charlene L. Hanover
Notary Public (One Inch Margin on all sides of Document for Recorders Use Only)

0589655

BK0903PG05860

EXHIBIT "A"

LEGAL DESCRIPTION

ESCROW NO.: 030802362

**Lot 24, as shown on the map of SARATOGA HEIGHTS UNIT NO. 1,
filed in the Office of the County Recorder of Douglas
County, Nevada, on May 15, 1961, as Document No. 17827.**

Assessor's Parcel No. 1420-28-811-024

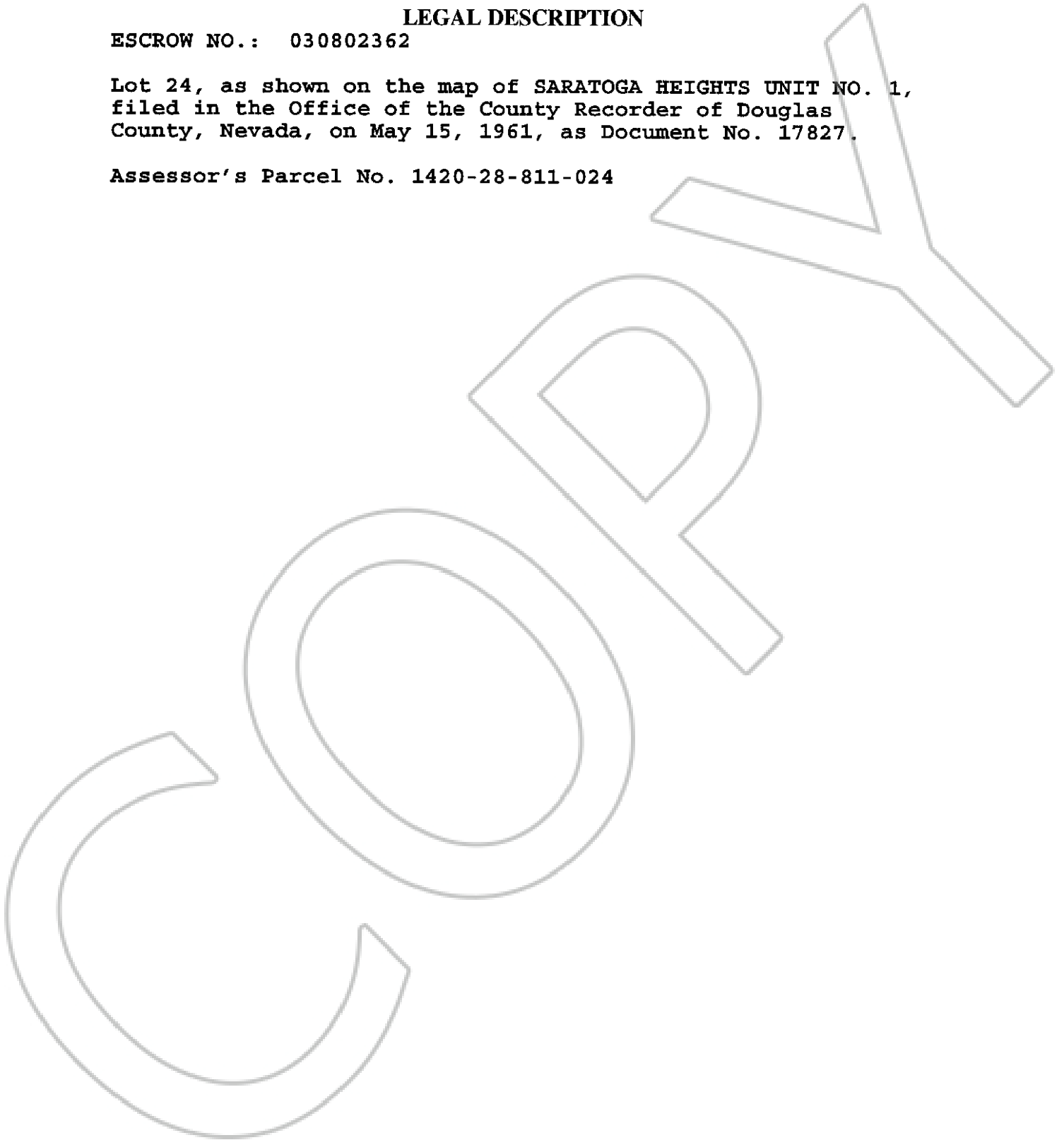

0589655

BK0903PG05861