

A.P.N. # 1420-08-411-009

R.P.T.T. \$ 312.00

ESCROW NO. 030202958

RECORDING REQUESTED BY:  
**STEWART TITLE COMPANY**  
MAIL TAX STATEMENTS TO:

Mr & Mrs. Corkill  
p.o. 11013

Zephyr Cove NV 89448  
WHEN RECORDED MAIL TO:

Mr & Mrs. Corkill  
p.o. 11013  
Zephyr Cove, NV 89448

REQUESTED BY  
**Stewart Title of Douglas County**

IN OFFICIAL RECORDS OF  
DOUGLAS CO., NEVADA

2003 SEP 15 AM 10:42

WERNER CHRISTEN  
RECORDER

\$ 15.00 PAID KJ DEPUTY

(Space Above for Recorder's Use Only)

### GRANT, BARGAIN, SALE DEED

THIS INDENTURE WITNESSETH: That **SCOTT ANDREW JOHNSTONE AND LORNA JOHNSTONE, HUSBAND AND WIFE**

in consideration of \$10.00, the receipt of which is hereby acknowledged, does hereby Grant, Bargain Sell and Convey to **ROBERT CORKILL AND JUDY CORKILL, HUSBAND AND WIFE**  
J L.  
AS JOINT TENANTS

and to the heirs and assigns of such Grantee forever, all that real property situated in the  
County of **Douglas** State of Nevada, bounded and described as:

**SEE EXHIBIT "A" ATTACHED HERETO AND MADE A PART HEREOF**

Together with all and singular the tenements, hereditaments and appurtenances thereunto belonging or in anywise appertaining, and any reversions, remainders, rents, issues or profits thereof.

DATE: **August 12, 2003**

Scott Andrew Johnstone  
**SCOTT ANDREW JOHNSTONE**  
Lorna Johnstone  
**LORNA JOHNSTONE**



STATE OF CALIF }  
COUNTY OF LOS ANGELES } ss.

This instrument was acknowledged before me on 9-5-03  
by **SCOTT ANDREW JOHNSTONE and LORNA JOHNSTONE**

Signature Guido A. Drogemuller  
Notary Public (One inch margin on all sides of document for Recorder's Use Only)

0589934

BK 0903 PG 07307

**EXHIBIT "A"**

**LEGAL DESCRIPTION**

**ESCROW NO.: 030202958**

Lot 19, in Block Q, of the final map of SUNRIDGE HEIGHTS, PHASES 6B, 7A and 8B, a Planned Unit Development, filed for record in the office of the County Recorder of Douglas County, State of Nevada, on January 30, 1996, as Document No. 380052, and Certificate of Amendment recorded February 2, 1996, as Document No. 380351.

**Assessor's Parcel No. 1420-08-411-009**

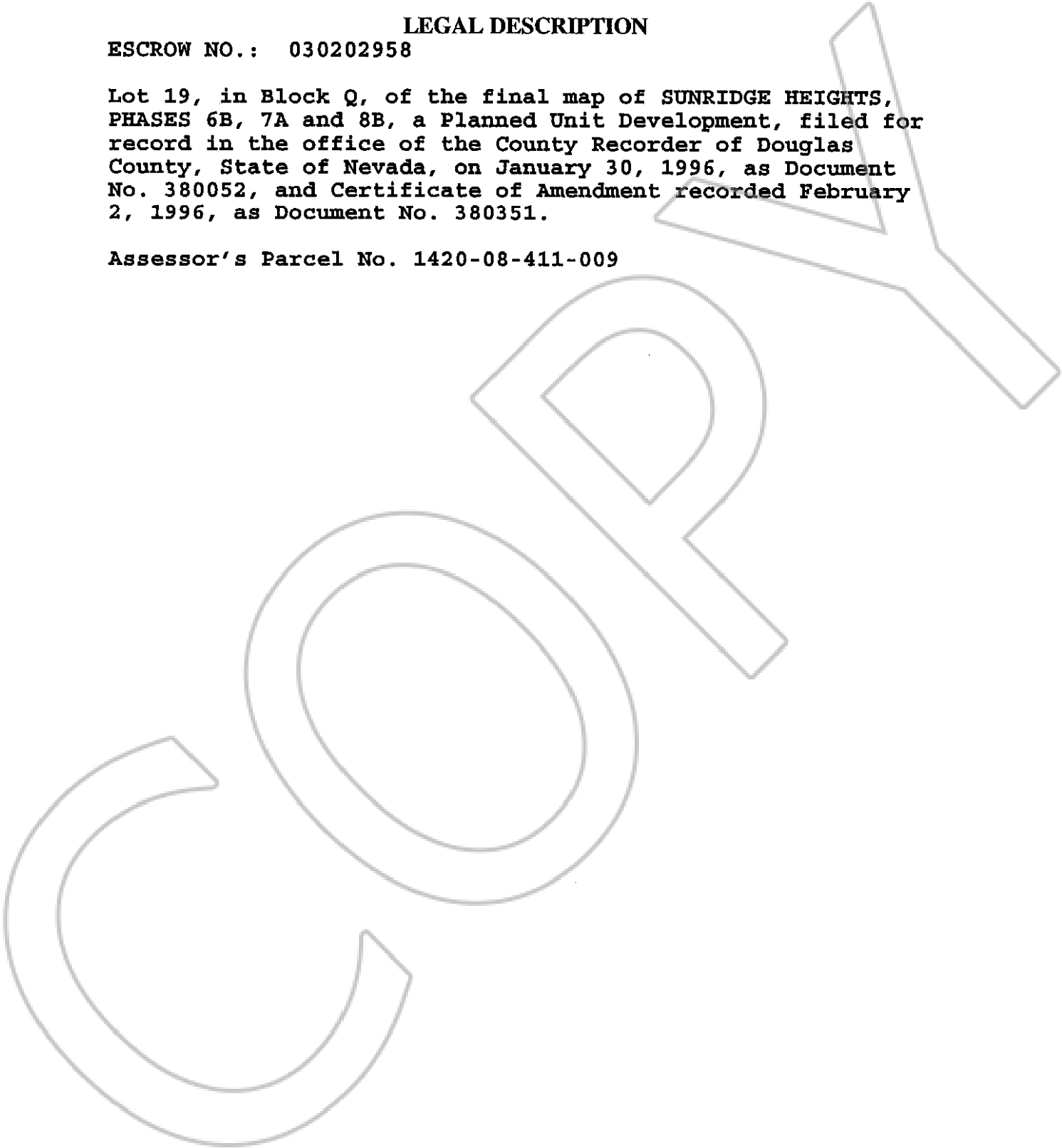

**0589934**

**BK0903PG07308**