

EXHIBIT "A"

LEGAL DESCRIPTION

ESCROW NO.: 030202983

Lot 16, as shown on the map of RIVERVIEW ESTATES, filed in the Office of the Douglas County Recorder, State of Nevada, on December 15, 1965, as File No. 30403.

Assessors Parcel No. 1220-24-410-016

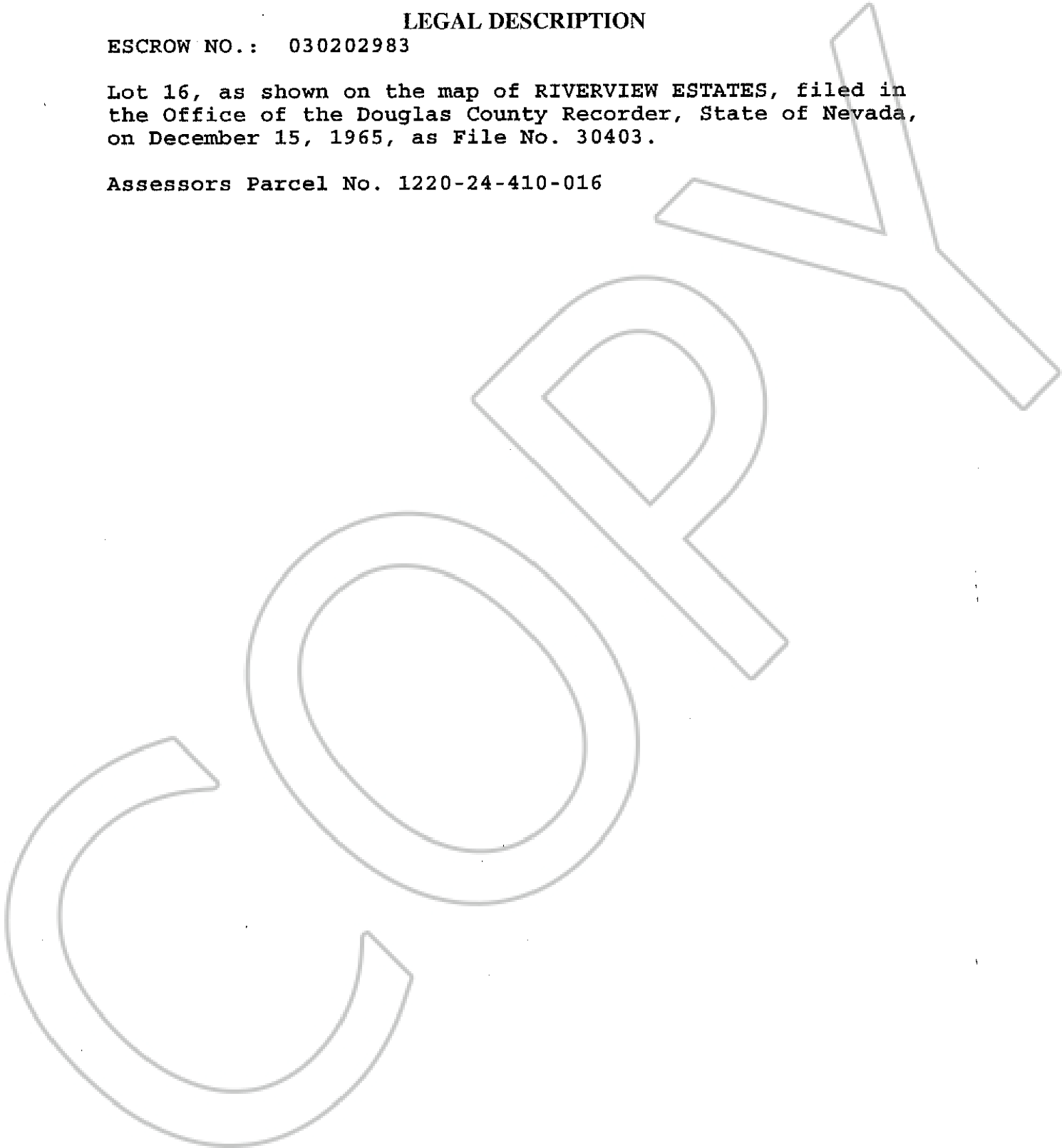

0589995

BK0903PG07626