

EXHIBIT "A"

LEGAL DESCRIPTION

ESCROW NO.: 030803203

Lot 29, SHERIDAN ACRES, UNIT NO. 1, as shown on the Official Map recorded June 8, 1966, in Book 1 of Maps in the Recorder's Office of Douglas County, Nevada, as Document No. 32486.

Assessment Parcel No. 1219-15-001-090.

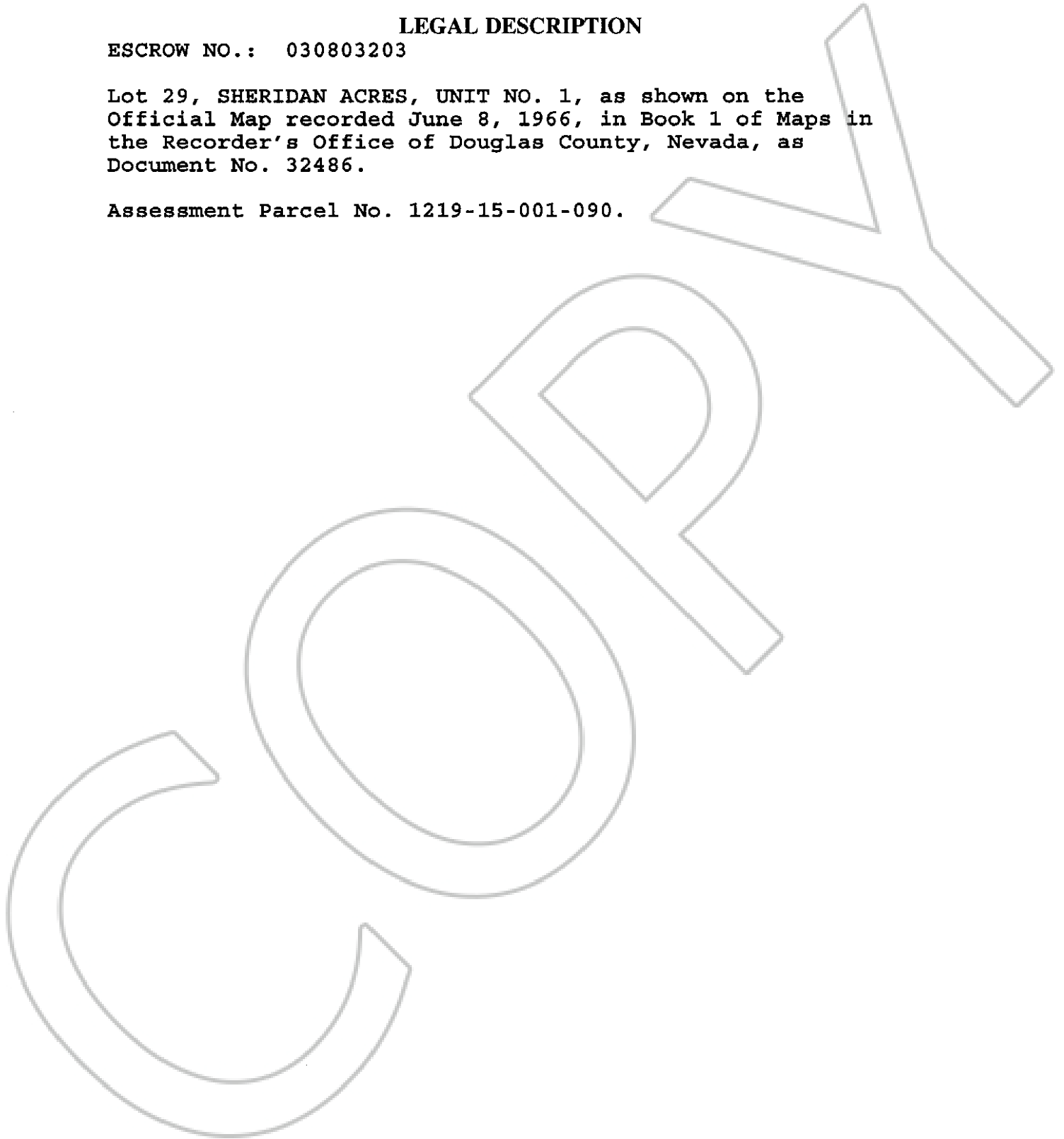

0589996

BK0903PG07628