

A.P.N. # 1220-17-515-013

R.P.T.T. \$ 169.00

ESCROW NO. 030803183

RECORDING REQUESTED BY:
STEWART TITLE COMPANY
MAIL TAX STATEMENTS TO:
SAME AS BELOW

WHEN RECORDED MAIL TO:
GRANTEE

REQUESTED BY
Stewart Title of Douglas County

IN OFFICIAL RECORDS OF
DOUGLAS CO., NEVADA

2003 SEP 19 AM 11:27

WERNER CHRISTEN
RECORDER

\$15⁰⁰ PAID *Kj* DEPUTY

(Space Above for Recorder's Use Only)

GRANT, BARGAIN, SALE DEED

THIS INDENTURE WITNESSETH: That **LOUANNE S. NOURSE, SURVIVING TRUSTEE OF THE NOURSE FAMILY TRUST OF 1991**

in consideration of \$10.00, the receipt of which is hereby acknowledged, does hereby Grant, Bargain Sell and Convey to **GREGORY C. LYNN and SUZANNE TOWSE, Trustees of the 1995 GREGORY C. LYNN & SUZANNE TOWSE TRUST AGREEMENT DATED MAY 16, 1995**

and to the heirs and assigns of such Grantee forever, all that real property situated in the County of **Douglas** State of Nevada, bounded and described as:
SEE EXHIBIT "A" ATTACHED HERETO AND MADE A PART HEREOF

Together with all and singular the tenements, hereditaments and appurtenances thereunto belonging or in anywise appertaining, and any reversions, remainders, rents, issues or profits thereof.

DATE: **August 14, 2003** **NOURSE FAMILY TRUST OF 1991**

BY: *Louanne Nourse*
LOUANNE S. NOURSE
SURVIVING TRUSTEE

THIS INSTRUMENT IS BEING RECORDED AS AN ACCOMODATION ONLY. NO LIABILITY, EXPRESSED OR IMPLIED, IS ASSUMED AS TO IT'S REGULARITY OR SUFFICIENCY NOR AS TO ITS EFFECT, IF ANY, UPON TITLE TO ANY REAL PROPERTY DESCRIBED THEREIN.

STEWART TITLE OF DOUGLAS COUNTY

STATE OF California }
COUNTY OF San Francisco } ss.

This instrument was acknowledged before me on 9/2/2003
by, LOUANNE S. NOURSE

Signature *Susan Diane Miller*

Notary Public (One Inch Margin on all sides of Document for Recorders Use Only)

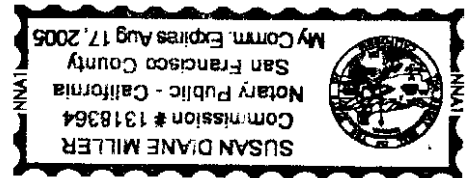

0590573

BK0903PG10601

EXHIBIT "A"

LEGAL DESCRIPTION

ESCROW NO.: 030803183

Lot 183, in Block A, as shown on the final map of PLEASANTVIEW PHASE 7, Final Subdivision Map No. 1009-7, filed for record in the office of the County Recorder of Douglas County, State of Nevada, on August 4, 1998, in Book 898, Page 634, as Document No. 446212.

Assessors Parcel No. 1220-17-515-013

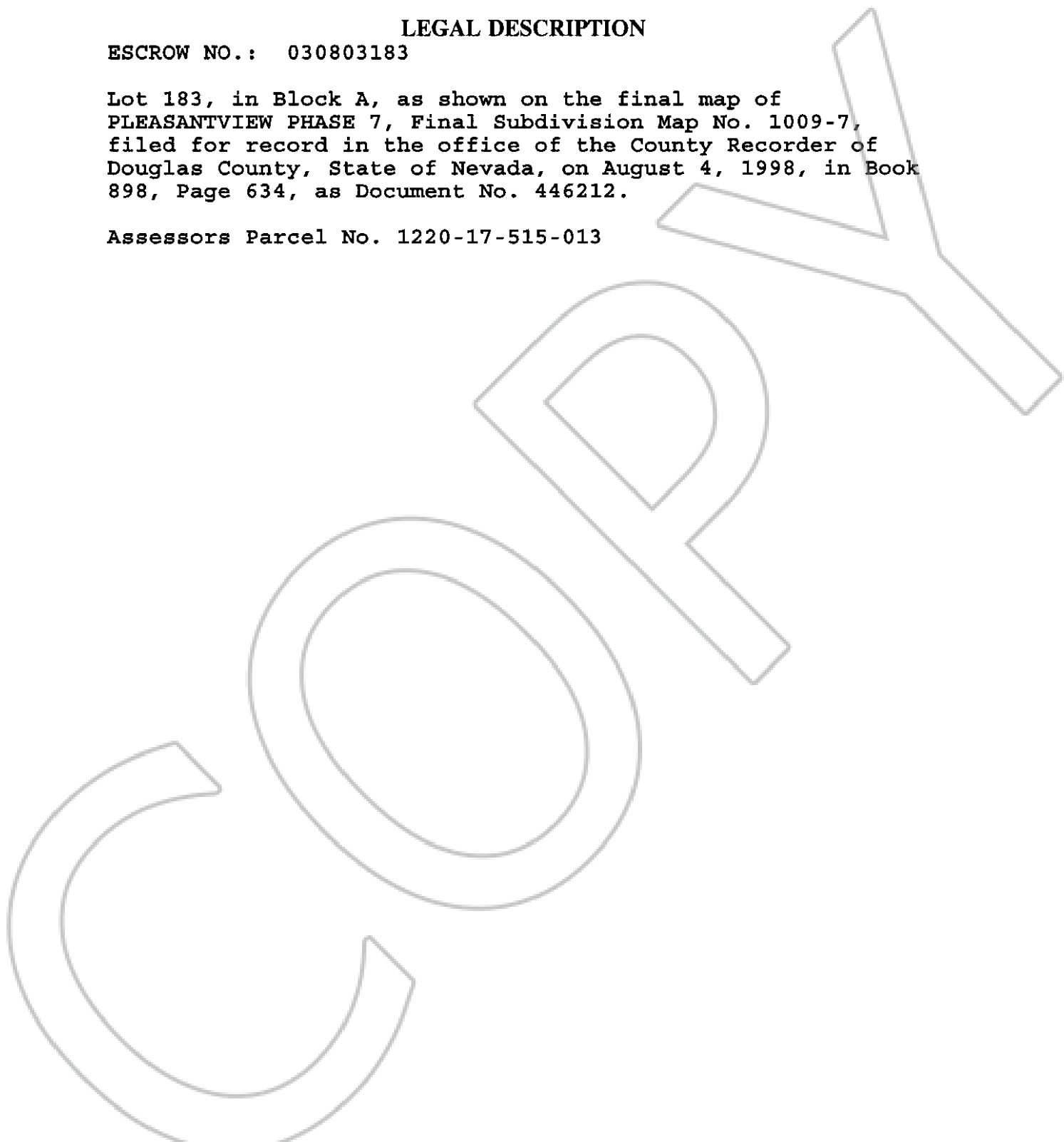

0590573

BK0903PG10602