

EXHIBIT "A"

LEGAL DESCRIPTION

ESCROW NO.: 030303365

Lot 20, Block G, as said Lot and Block are shown on the Amended map of RANCHOS ESTATES, filed in the office of the County Recorder of Douglas County, State of Nevada, on October 30, 1972, as Document No. 62493.

Assessor's Parcel No. 1220-17-614-002.

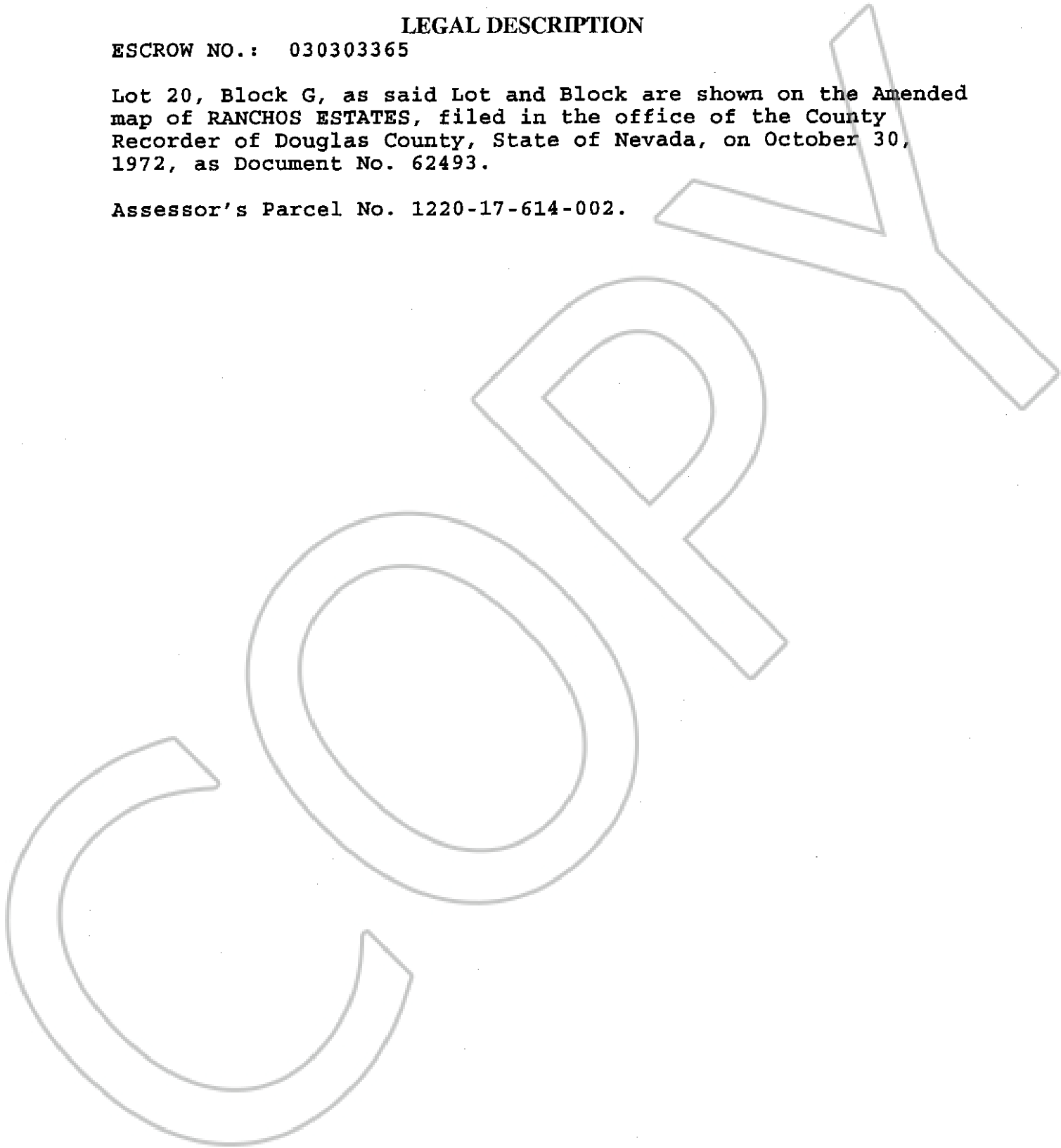

0590603

BK0903PG10800