

A.P.N. # 1320-29-115-012

R.P.T.T. \$ 492.70

ESCROW NO. 030703118

RECORDING REQUESTED BY:
STEWART TITLE COMPANY
MAIL TAX STATEMENTS TO:
SAME AS BELOW

WHEN RECORDED MAIL TO:
GRANTEE
1126 WISTERIA DRIVE
MINDEN, NEVADA 89423

REQUESTED BY
Stewart Title of Douglas County
IN OFFICIAL RECORDS OF
DOUGLAS CO., NEVADA

2003 SEP 22 PH 3:37

WERNER CHRISTEN
RECORDER

\$ 15⁰⁰ PAID Be DEPUTY

(Space Above for Recorder's Use Only)

GRANT, BARGAIN, SALE DEED

THIS INDENTURE WITNESSETH: That **JOHN K. FEATHERSTONE and JUDITH A. FEATHERSTONE**, as Trustees, UDT DATED NOVEMBER 25, 19912, wherein John K. Featherstone and Judith A. Featherstone are the Trustors

in consideration of \$10.00, the receipt of which is hereby acknowledged, does hereby Grant, Bargain Sell and Convey to **PHILLIP PINTO, a married man as his sole and separate property**

and to the heirs and assigns of such Grantee forever, all that real property situated in the County of **Douglas** State of Nevada, bounded and described as:

SEE EXHIBIT "A" ATTACHED HERETO AND MADE A PART HEREOF

Together with all and singular the tenements, hereditaments and appurtenances thereunto belonging or in anywise appertaining, and any reversions, remainders, rents, issues or profits thereof.

DATE: **September 09, 2003** FEATHERSTONE TRUST

BY: John K. Featherstone TRUSTEE
JOHN K. FEATHERSTONE
TRUSTEE/TRUSTOR

BY: Judith A. Featherstone Trustee
JUDITH A. FEATHERSTONE
TRUSTEE/STRUSTOR

STATE OF Nevada }
COUNTY OF Douglas } SS.

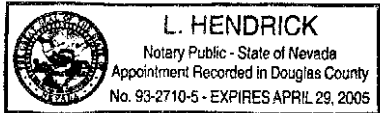

This instrument was acknowledged before me on 9-17-03
by, **JOHN K. FEATHERSTONE and JUDITH A. FEATHERSTONE**

Signature L. Hendrick
Notary Public (One Inch Margin on all sides of Document for Recorders Use Only)

0590814

BK0903PG12024

EXHIBIT "A"

LEGAL DESCRIPTION

ESCROW NO.: 030703118

Lot 260, as set forth on the Official Plat of WINHAVEN,
UNIT NO. 4, PHASE A, a Planned Unit Development filed for
record in the office of the County Recorder of Douglas
County, State of Nevada, on August 19, 1993, as Document
No. 315526.

Assessors Parcel No. 1320-29-115-012

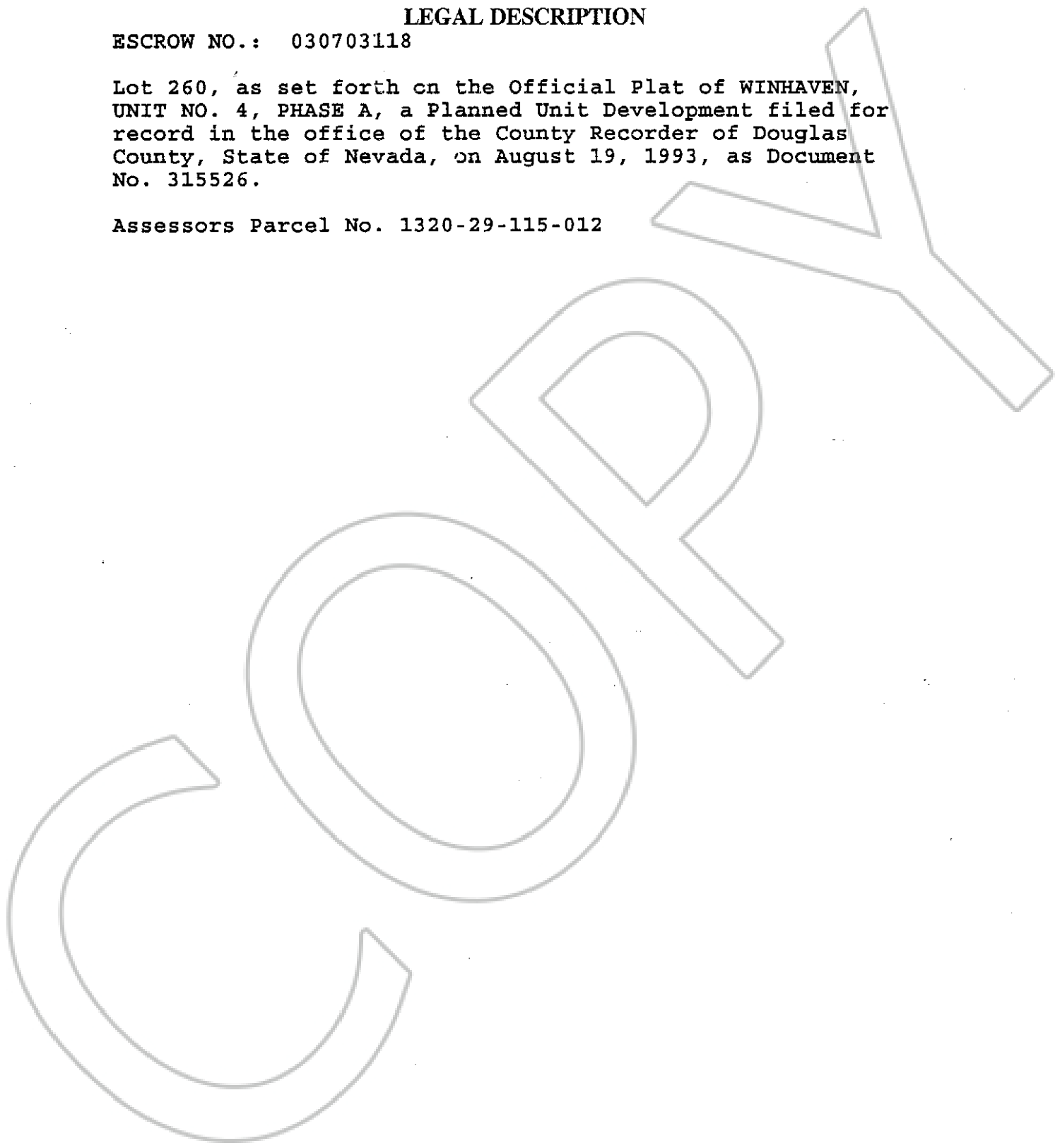

0590814
BK0903PG12025