

A.P.N. # 1320-29-115-012

R.P.T.T. \$ 0.00 #6

ESCROW NO. 030703118

RECORDING REQUESTED BY:
STEWART TITLE COMPANY
MAIL TAX STATEMENTS TO:
SAME AS BELOW

WHEN RECORDED MAIL TO:
GRANTEE
1126 WISTERIA DRIVE
MINDEN, NEVADA 89423

REQUESTED BY
Stewart Title of Douglas County
IN OFFICIAL RECORDS OF
DOUGLAS CO., NEVADA

2003 SEP 22 PM 3: 39

WERNER CHRISTEN
RECORDER

\$ 15.00 PAID Be DEPUTY

(Space Above for Recorder's Use Only)

GRANT, BARGAIN, SALE DEED

THIS INDENTURE WITNESSETH: That **VALERIE PINTO, SPOUSE OF THE GRANTEE SHOWN HEREIN**

in consideration of \$10.00, the receipt of which is hereby acknowledged, does hereby Grant, Bargain Sell and Convey to **PHILLIP PINTO, A MARRIED MAN, AS HIS SOLE AND SEPARATE PROPERTY**

and to the heirs and assigns of such Grantee forever, all that real property situated in the County of **Douglas** State of Nevada, bounded and described as :

SEE EXHIBIT "A" ATTACHED HERETO AND MADE A PART HEREOF

IT IS THE EXPRESS INTENT OF THE GRANTOR, BEING THE SPOUSE OF THE GRANTEE, TO CONVEY ALL RIGHT, TITLE AND INTEREST OF THE GRANTOR, COMMUNITY OR OTHERWISE, IN AND TO THE HEREIN DESCRIBED PROPERTY TO THE GRANTEE AS GRANTEE'S SOLE AND SEPARATE PROPERTY.

Together with all and singular the tenements, hereditaments and appurtenances thereunto belonging or in anywise appertaining, and any reversions, remainders, rents, issues or profits thereof.

DATE: **September 15, 2003**

Valerie Pinto
VALERIE PINTO



STATE OF Nevada }
COUNTY OF Douglas } ss.

This instrument was acknowledged before me on 9-16-03
by, **VALERIE PINTO**

Signature L. Hendrick
Notary Public (One Inch Margin on all sides of Document for Recorder's Use Only)

0590815

BK0903PG12026

EXHIBIT "A"

LEGAL DESCRIPTION

ESCROW NO.: 630703118

**Lot 260, as set forth on the Official Plat of WINHAVEN,
UNIT NO. 4, PHASE A, a Planned Unit Development filed for
record in the office of the County Recorder of Douglas
County, State of Nevada, on August 19, 1993, as Document
No. 315526.**

Assessors Parcel No. 1320-29-115-012

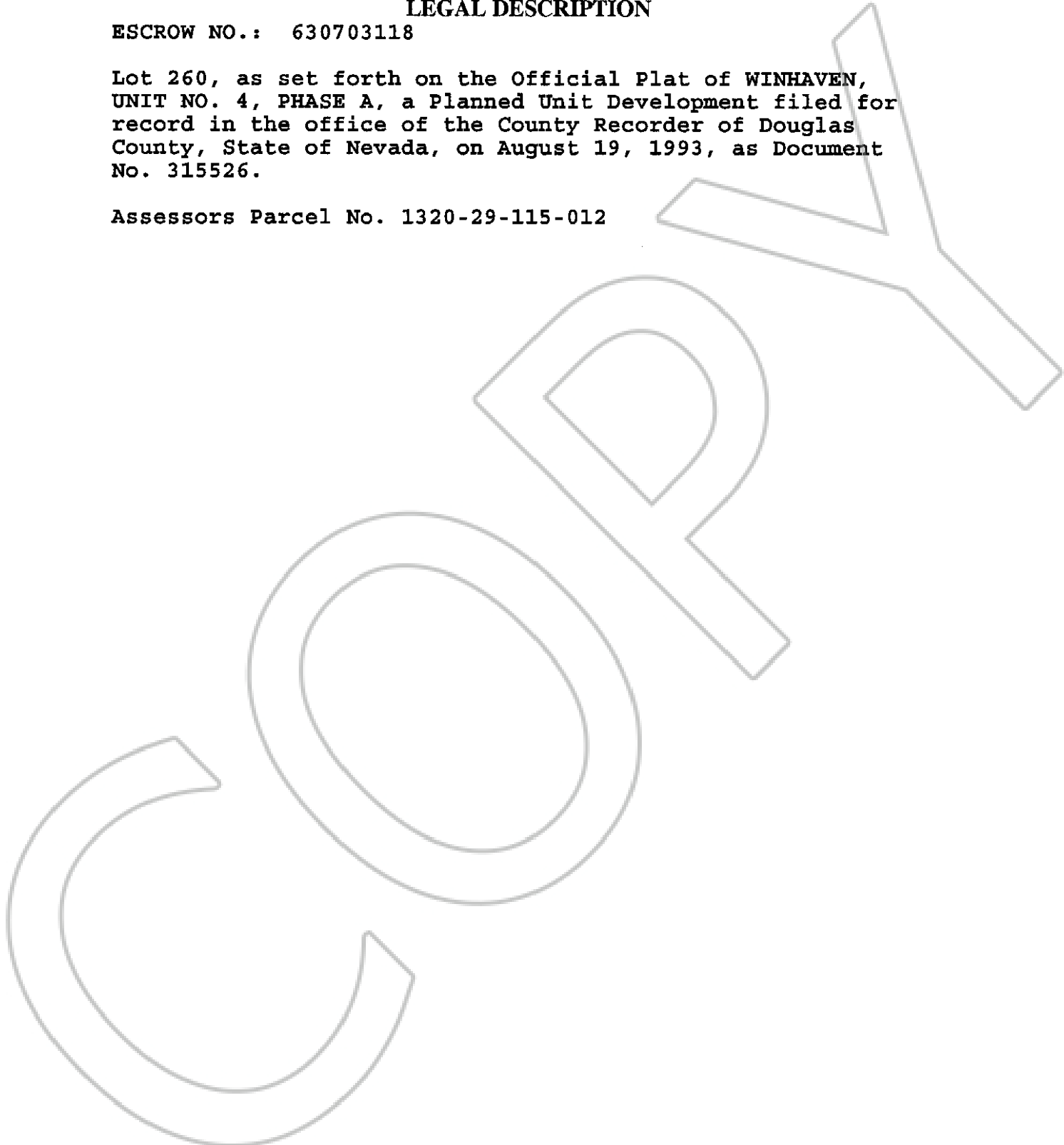

0590815

BK0903PG12027