

A.P.N. # 1320-29-212-035

R.P.T.T. \$ 377.00

ESCROW NO. 030803219

RECORDING REQUESTED BY:
STEWART TITLE COMPANY

MAIL TAX STATEMENTS TO:
SAME AS BELOW

WHEN RECORDED MAIL TO:
GRANTEE
2283 LUPINE TRAIL
SOUTH LAKE TAHOE, CA 96150

REQUESTED BY
Stewart Title of Douglas County

IN OFFICIAL RECORDS OF
DOUGLAS CO., NEVADA

2003 SEP 23 AM 10:51

WERNER CHRISTEN
RECORDER

\$ 15.00 PAID RL DEPUTY

(Space Above for Recorder's Use Only)

GRANT, BARGAIN, SALE DEED

THIS INDENTURE WITNESSETH: That **CHRISTIAN ARTHUR NENZEL and VIRGINIA ROSE NENZEL, Trustees of the CHRISTIAN ARTHUR NENZEL AND VIRGINIA ROSE NENZEL FAMILY TRUST DATED DECEMBER 11, 2002**

in consideration of \$10.00, the receipt of which is hereby acknowledged, does hereby Grant, Bargain Sell and Convey to **TERRY CANNON and LINDA CANNON, husband and wife** as Joint Tenants

and to the heirs and assigns of such Grantee forever, all that real property situated in the County of **Douglas** State of Nevada, bounded and described as:

SEE EXHIBIT "A" ATTACHED HERETO AND MADE A PART HEREOF

Together with all and singular the tenements, hereditaments and appurtenances thereunto belonging or in anywise appertaining, and any reversions, remainders, rents, issues or profits thereof.

DATE: **August 26, 2003** **CHRISTIAN ARTHUR NENZEL & VIRGINIA ROSE NENZEL FAMILY TRUST DTD 12/1/02**

BY: Christian Arthur Nenzel Trustee
CHRISTIAN ARTHUR NENZEL
TRUSTEE

BY: Virginia Rose Nenzel Trustee
VIRGINIA ROSE NENZEL
TRUSTEE

STATE OF Nevada }
COUNTY OF Douglas } SS.

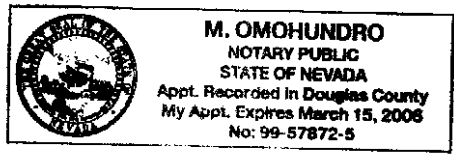

This instrument was acknowledged before me on 9-11-03
by CHRISTIAN ARTHUR NENZEL and VIRGINIA ROSE NENZEL

Signature [Signature]
Notary Public (One Inch Margin on all sides of Document for Recorders Use Only)

0590941

BK0903PG12505

EXHIBIT "A"

LEGAL DESCRIPTION

ESCROW NO.: 030803219

Lot 109, in Block B, as set forth on the map of WINHAVEN,
UNIT NO. 1, a Planned Unit Development filed for record in
the office of the County Recorder of Douglas County, State
of Nevada, on January 13, 1989 as Document No. 194373.

Assessors Parcel No. 1320-29-212-035

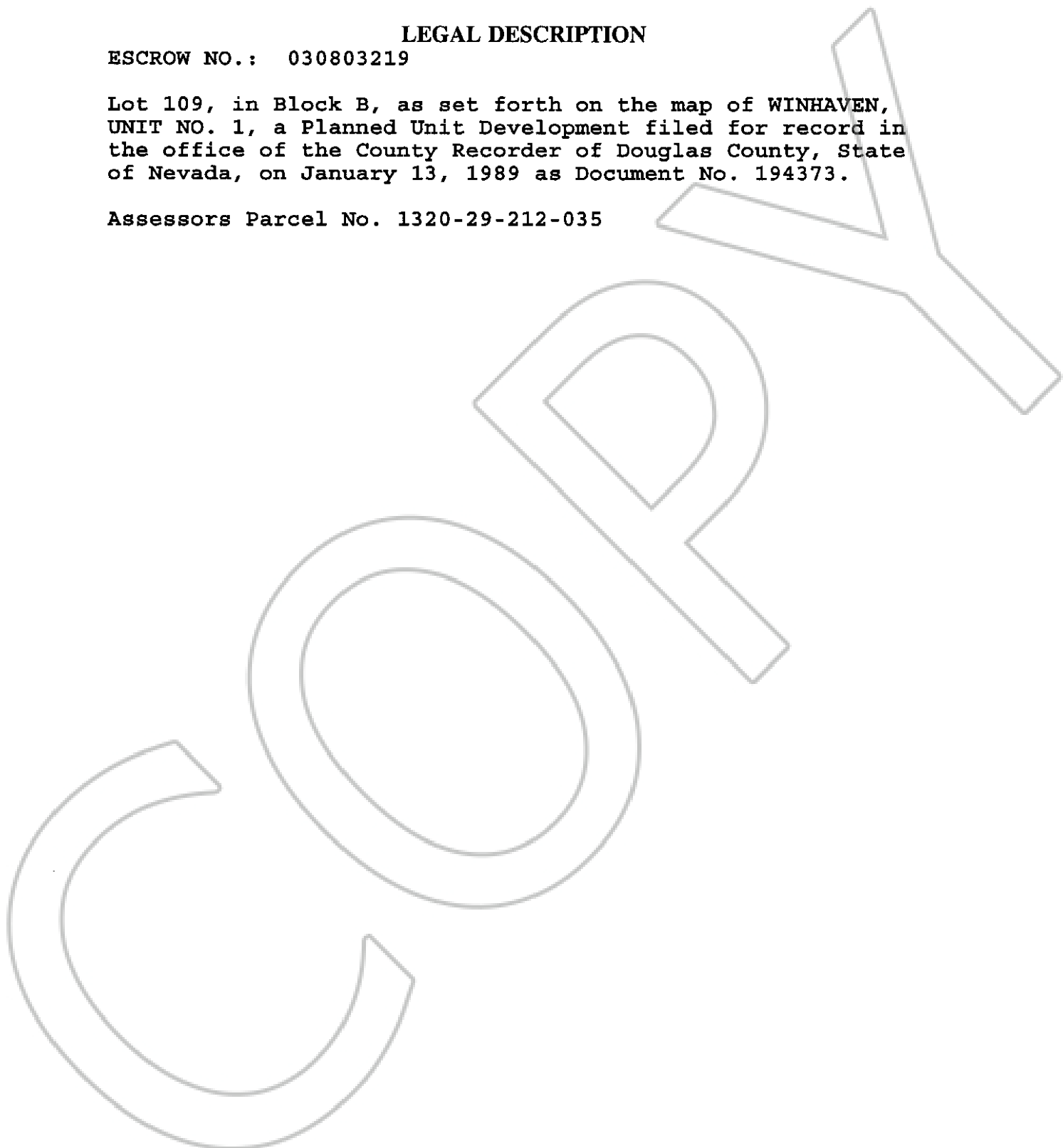

0590941

BK0903PG12506