

REQUESTED BY
Kenneth Garber
IN OFFICIAL RECORDS OF
DOUGLAS CO., NEVADA

Assessor Parcel Number: 1320-33-813-006 OR

2003 SEP 23 PM 12:39

Assessor's Manufactured Home ID number _____

WERNER CHRISTEN
RECORDER

\$15⁰⁰ PAID KJ DEPUTY

Declaration of Homestead

(Check One)

- Married (filing joint declaration)
- ____ Head of Family
- ____ By Husband (filing for joint benefit or both)
- ____ Single, Married or Widowed
- ____ By Wife (filing for joint benefit or both)
- ____ Multiple Single Persons

A. (Check One)

Regular Home Dwelling/Manufactured Home _____ Condominium Unit _____ Other _____

Name on Title of Property Garber Family Revocable Trust dated May 12, 2003

Do individually or severally certify and declare as follows: Debra L. & Kenneth S. Garber
is / are now residing on the land, premises (or manufactured home) located in the
City of Gardnerville, County of Douglas, State of Nevada, and more particularly
described as follows:

(Set forth legal description and commonly known street address OR manufactured home description)

1346 Chichester Drive; Gardnerville, Nevada 89410

See Exhibit "A" attached hereto and made a part hereof.

B. I/We claim the land and premises hereinabove described, together with the dwelling house thereon, and its appurtenances, or the described manufactured home as a Homestead.

C. (Check One)

- ____ (1) No former Declaration of Homestead has been made by me, or us, or either of us.
- ____ (2) This Declaration constitutes an abandonment of the former Declaration recorded _____

In Witness, Whereof, I/We have hereunto set my hand/our hands this 23 day of September, 2003

Kenneth S. Garber
(Signature)
Kenneth S. Garber
(Print or type name here)

Debra L. Garber
(Signature)
Debra L. Garber
(Print or type name here)

STATE OF NEVADA _____)
COUNTY OF Douglas _____)

This instrument was acknowledged before me on September 23, 2003
(date)

Kenneth S. Garber & Debra L. Garber
(Person(s) appearing before notary)

Kathy Swain My commission expires: _____
(Signature of notarial officer)



CONSULT AN ATTORNEY IF YOU DOUBT THIS FORM'S FITNESS FOR YOUR PURPOSE

Recording Requested by and Mail to:
Name: Kenneth S. Garber
Address/ City/ State/ Zip: 1346 Chichester Drive; Gardnerville, Nevada 89410

This form provided as a courtesy to the taxpayer by: Lisa Wetzel and Jim Valentine...RE/MAX Realty Affiliates. Lisa Wetzel, Jim Valentine & RE/MAX Realty Affiliates assumes no liability for the completion of the Homestead Declaration.

0590959
BK 0903 PG 12575

EXHIBIT "A"
LEGAL DESCRIPTION

**LOT 13, BLOCK B, AS SET FORTH ON FINAL SUBDIVISION MAP NO. 1006-5
FOR CHICHESTER ESTATES, PHASE 5, FILED IN THE OFFICE OF THE
COUNTY RECORDER OF DOUGLAS COUNTY, NEVADA AND RECORDED
APRIL 9, 1999, IN BOOK 499, PAGE 1900, AS DOCUMENT NO. 465394.**

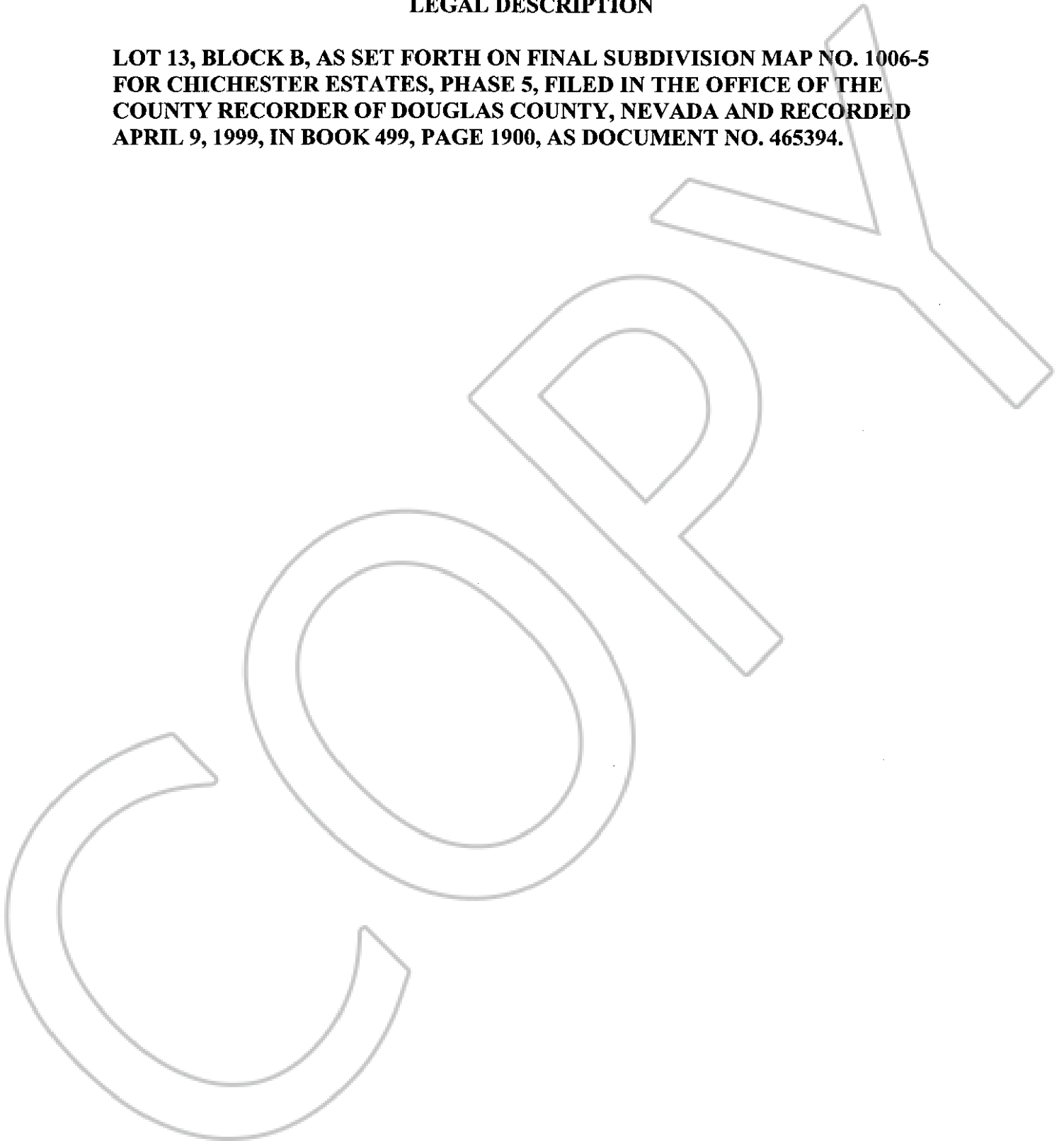

0590959

BK 0903 PG 12576