

A.P.N.# 1320-33-715-014

R.P.T.T.\$ 0.00 #6

ESCROW NO. 030303254

RECORDING REQUESTED BY:
STEWART TITLE COMPANY
MAIL TAX STATEMENTS TO:
SAME AS BELOW

WHEN RECORDED MAIL TO:
MARK HEDSTROM
1339 GRANBOROUGH DRIVE
GARDNERVILLE, NV 89410

REQUESTED BY
Stewart Title of Douglas County
IN OFFICIAL RECORDS OF
DOUGLAS CO., NEVADA

2003 SEP 29 PM 3:26

WERNER CHRISTEN
RECORDER

\$ 40⁰⁰ PAID KJ DEPUTY

(Space Above for Recorder's Use Only)

GRANT, BARGAIN, SALE DEED

THIS INDENTURE WITNESSETH: That **ARMIE HEDSTROM**, SPOUSE OF GRANTEE HEREIN

in consideration of \$10.00, the receipt of which is hereby acknowledged, does hereby Grant, Bargain Sell and Convey to **MARK HEDSTROM, A MARRIED MAN, AS HIS SOLE AND SEPERATE PROPERTY**

and to the heirs and assigns of such Grantee forever, all that real property situated in the County of **Douglas** State of Nevada, bounded and described as :

SEE EXHIBIT "A" ATTACHED HERETO AND MADE A PART HEREOF

IT IS THE EXPRESS INTENT OF THE GRANTOR, BEING THE SPOUSE OF THE GRANTEE, TO CONVEY ALL RIGHT, TITLE AND INTEREST OF THE GRANTOR, COMMUNITY OR OTHERWISE, IN AND TO THE HEREIN DESCRIBED PROPERTY TO THE GRANTEE AS GRANTEE'S SOLE AND SEPARATE PROPERTY.

Together with all and singular the tenements, hereditaments and appurtenances thereunto belonging or in anyway appertaining, and any reversions, remainders, rents, issues or profits thereof.

DATE: **September 19, 2003**

ARMIE HEDSTROM



STATE OF Nevada }
COUNTY OF Clark } ss.

This instrument was acknowledged before me on September 19, 2003
by, **ARMIE HEDSTROM**

Signature

Notary Public (One Inch Margin on all sides of Document for Recorder's Use Only)

0591722
BK 0903PG16380

EXHIBIT "A"

LEGAL DESCRIPTION

ESCROW NO.: 030303254

Lot 22, Block H, as set forth on Final Subdivision Map No. 1006-7 for Chichester Estates Phase 7, filed in the Office of the County Recorder of Douglas County, State of Nevada on October 13, 2000, in Book 1000, Page 2398, as Document No. 501336.

ASSESSOR'S PARCEL NO. 1320-33-715-014

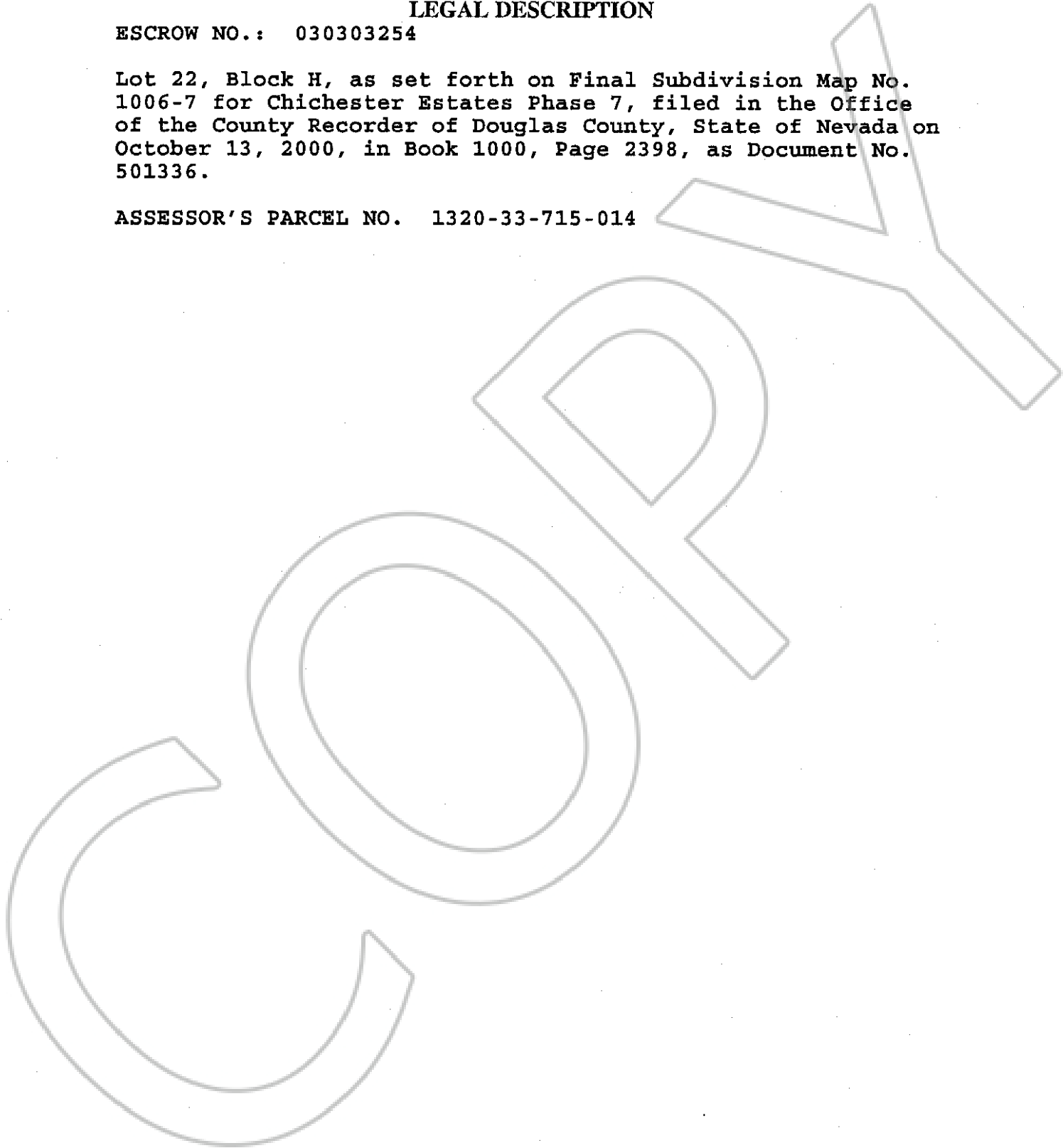

0591722

BK0903PG16381