



**EXHIBIT "A"**

**LEGAL DESCRIPTION**

ESCROW NO.: 030202471

Lot 5, as shown on the map of RIVERVIEW ESTATES, filed in the Office of the Douglas County Recorder, State of Nevada, on December 15, 1965, as File No. 30403.

Assessors Parcel No. 1220-24-410-005

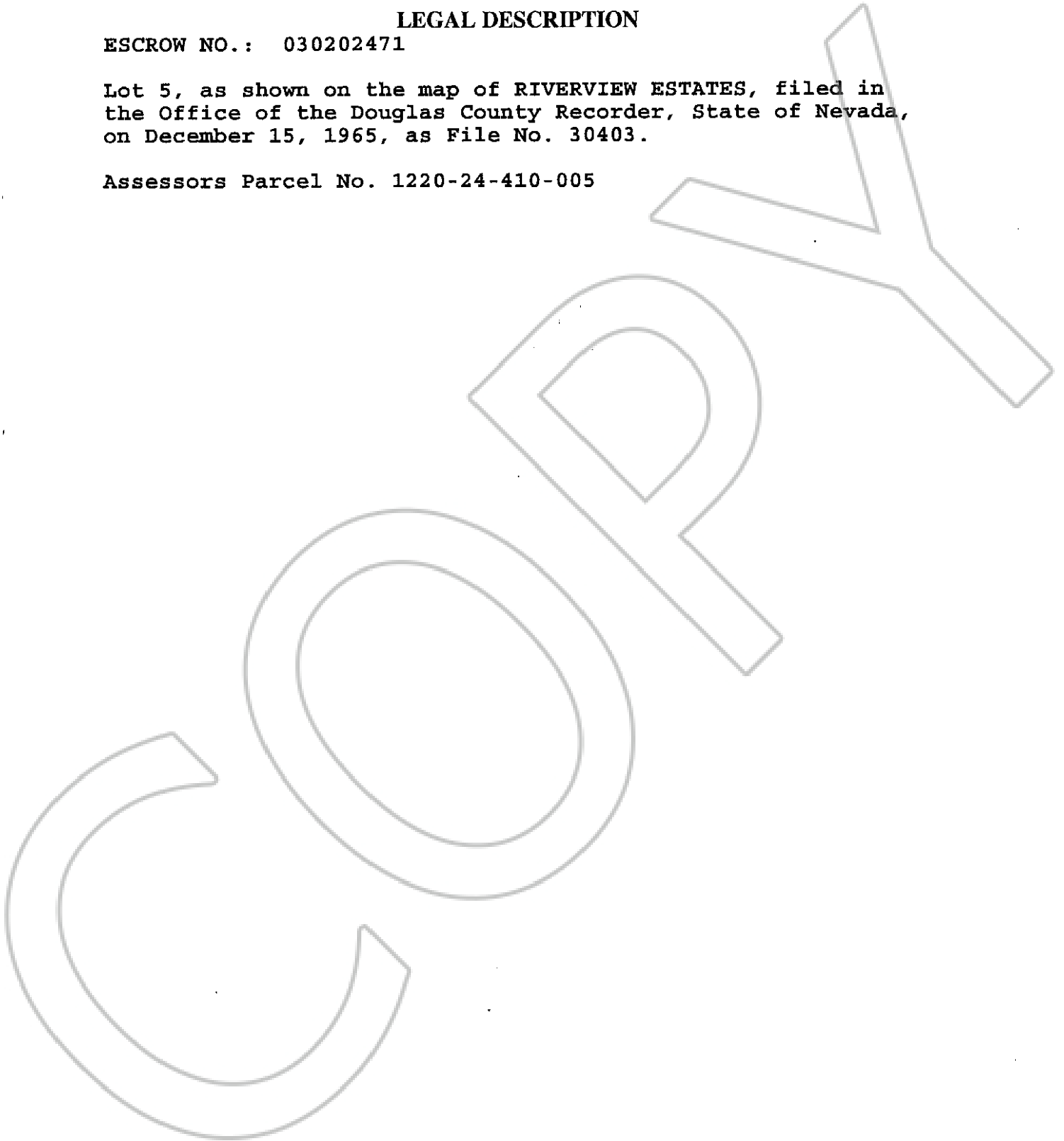

0591851

BK0903PG17051