

15-
A.P.N. # 1220-17-610-008

R.P.T.T. \$ #8A
ESCROW NO. 030802821

RECORDING REQUESTED BY:
STEWART TITLE COMPANY
MAIL TAX STATEMENTS TO:
SAME AS BELOW

REQUESTED BY
Barbara A. Parrish
IN OFFICIAL RECORDS OF
DOUGLAS CO., NEVADA

2003 SEP 30 AM 10:55

WERNER CHRISTEN
RECORDER

\$15.00 PAID *W* DEPUTY

✓ WHEN RECORDED MAIL TO:
*916 SPRINGFIELD DR
GARDNERVILLE, NV 89460*

(Space Above for Recorder's Use Only)

GRANT, BARGAIN, SALE DEED

THIS INDENTURE WITNESSETH: That **RAY M. PARRISH AND BARBARA A. PARRISH, HUSBAND AND WIFE**

in consideration of \$10.00, the receipt of which is hereby acknowledged, does hereby Grant, Bargain Sell and Convey to **RAY M. PARRISH AND BARBARA A. PARRISH, HUSBAND AND WIFE, TRUSTEES OF THE PARRISH FAMILY TRUST DATED APRIL 7, 1994**

and to the heirs and assigns of such Grantee forever, all that real property situated in the County of **DOUGLAS** State of Nevada, bounded and described as:

SEE EXHIBIT "A" ATTACHED HERETO AND MADE A PART HEREOF

Together with all and singular the tenements, hereditaments and appurtenances thereunto belonging or in anywise appertaining, and any reversions, remainders, rents, issues or profits thereof.

DATE: **August 05, 2003**

Ray M Parrish
RAY M. PARRISH

Barbara A Parrish
BARBARA A. PARRISH

STATE OF NEVADA }
COUNTY OF DOUGLAS } ss

 **CHARLENE L. HANOVER**
NOTARY PUBLIC
STATE OF NEVADA
Appt. Recorded in Douglas County
My Appt. Expires February 3, 2007
No: 98-2565-5

This instrument was acknowledged before me on August 5, 2003
by, RAY M, PARRISH AND BARBARA A. PARRISH

Signature *Charlene L Hanover*

Notary Public (One inch margin on all sides of document for Recorder's Use Only)

0591861

BK0903PG17158

EXHIBIT "A"

LEGAL DESCRIPTION

ESCROW NO.: 030802821

Lot 135, in Block A, as shown on the final map of PLEASANTVIEW PHASE 7, Final Subdivision Map No. 1009-7, filed for record in the office of the County Recorder of Douglas County, State of Nevada, on August 4, 1998, in Book 898, Page 634, as Document No. 446212.

Assessors Parcel No. 1220-17-610-008

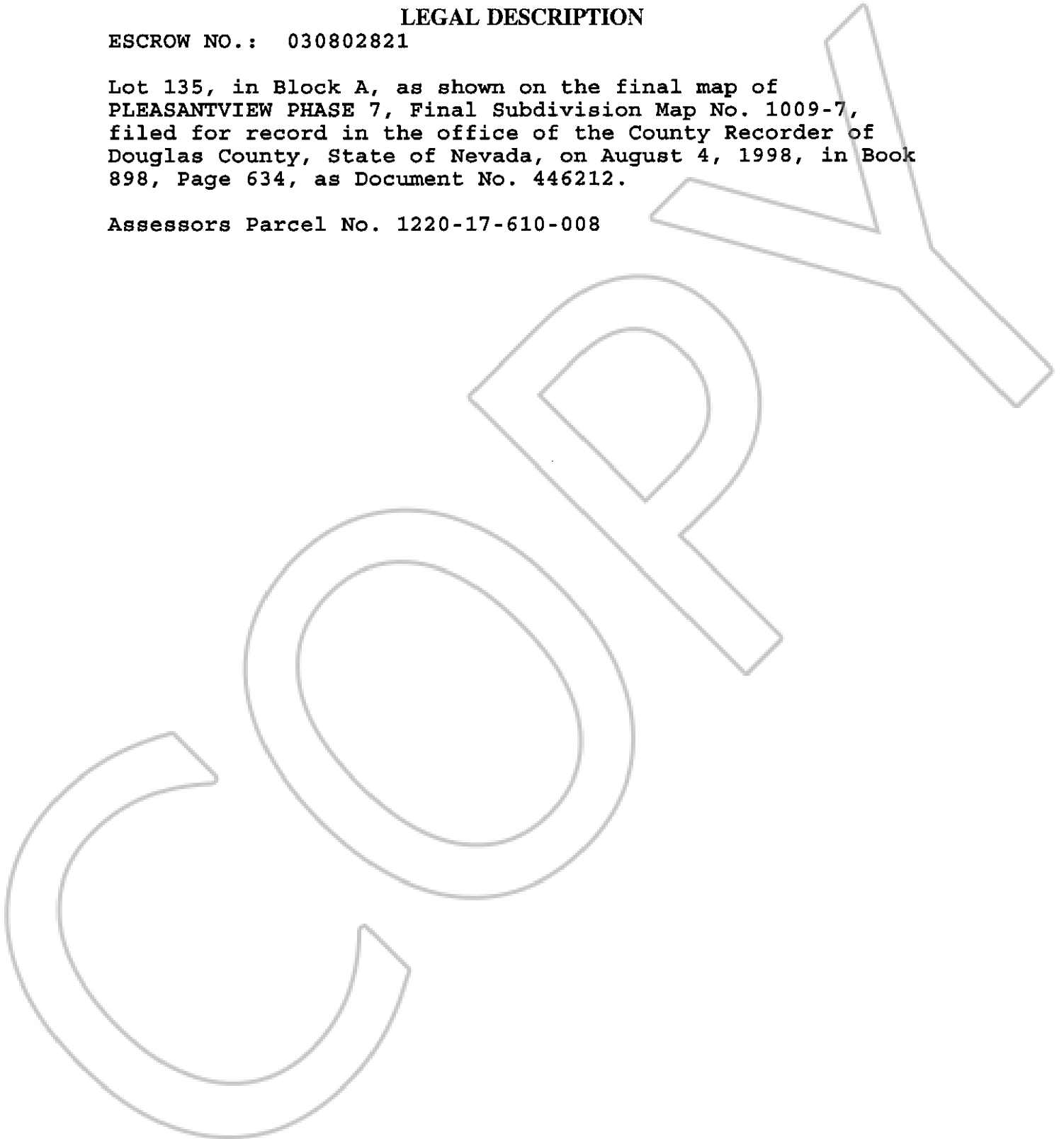

0591861

BK0903PG17159