



**LEGAL DESCRIPTION**

The land referred to herein is situated in the State of Nevada,  
County of Douglas, described as follows:

Lot 7, in Block A, as shown on the map of CAMERON HEIGHTS  
SUBDIVISION, filed for record January 10, 1989, Document No.  
194076, Official Records of Douglas County, Nevada.

ASSESSOR'S PARCEL NO. 1420-07-719-007

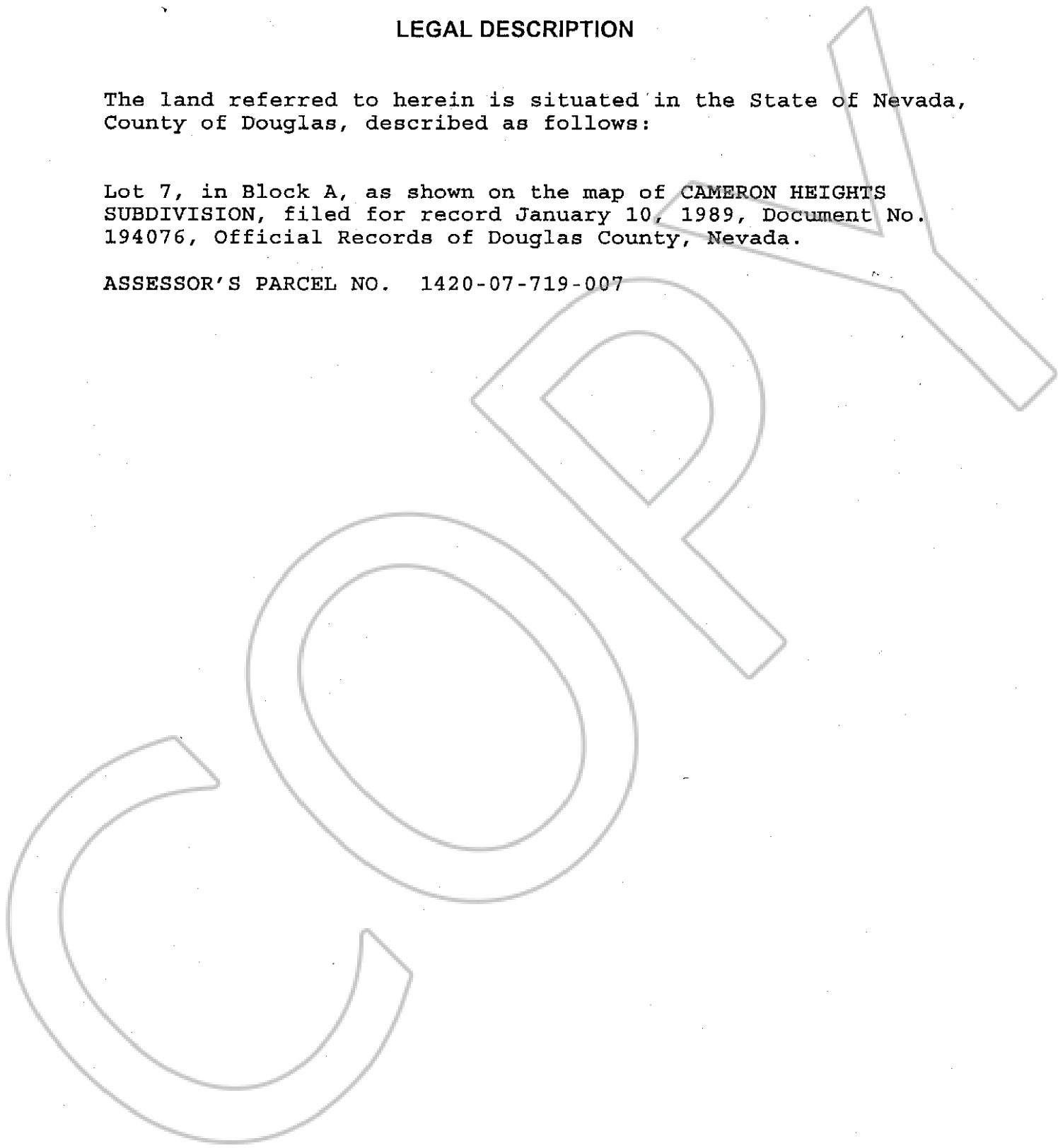

**0592126**

**BK1003PG00453**