

A.P.N. # 1318-22-002-030
 R.P.T.T. \$ 33750 (1/2 interest)
 ESCROW NO. 030202955
 RECORDING REQUESTED BY:
STEWART TITLE COMPANY
 MAIL TAX STATEMENTS TO:
GRANTEE
P.O. BOX 11745
ZEPHYR COVE, NV 89448
 WHEN RECORDED MAIL TO:
GRANTEE
P.O. BOX 11745
ZEPHYR COVE, NV 89448

REQUESTED BY
Stewart Title of Douglas County
 IN OFFICIAL RECORDS OF
 DOUGLAS CO., NEVADA
 2003 OCT -2 PM 3:52
 WERNER CHRISTEN
 RECORDER
 s/ke PAID Bl DEPUTY

(Space Above for Recorder's Use Only)

GRANT, BARGAIN, SALE DEED

THIS INDENTURE WITNESSETH: That **LAURIE E. WEDIN AND THOMAS R. UTZIG**

in consideration of \$10.00, the receipt of which is hereby acknowledged, does hereby Grant, Bargain Sell and Convey to **MARY L. WEDIN, A WIDOW AND LAURIE E. WEDIN, AN UNMARRIED WOMAN AND THOMAS R. UTZIG, AN UNMARRIED MAN** EACH TO AN UNDIVIDED 1/3 INTEREST

and to the heirs and assigns of such Grantee forever, all that real property situated in the County of **DOUGLAS** State of Nevada, bounded and described as:
SEE EXHIBIT "A" ATTACHED HERETO AND MADE A PART HEREOF
 Together with all and singular the tenements, hereditaments and appurtenances therunto belonging or in anywise appertaining, and any reversions, remainders, rents, issues or profits thereof.

DATE: **September 16, 2003**

Laurie E. Wedin
LAURIE E. WEDIN
Thomas R. Utzig
THOMAS R. UTZIG

STATE OF _____ }
 } ss.
 COUNTY OF _____ }
 This instrument was acknowledged before me on _____
 by **LAURIE E. WEDIN and THOMAS R. UTZIG**

Signature _____
 Notary Public (One inch margin on all sides of document for Recorder's Use Only)

0592329
BK 1003PG 1390

STATE OF NEVADA }
COUNTY OF CLARK } SS.

This instrument was acknowledged before me on 17, September 2003, by _____
LAURIE E. WEDIN AND THOMAS R. UTZIG

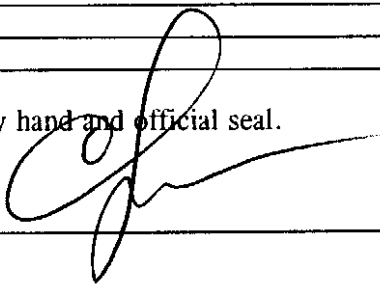
WITNESS my hand and official seal.
Signature 

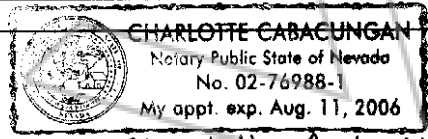

Charlotte Cabacungan
(This area for official notarial seal)

COPIES

0592329
BK1003PG1391

EXHIBIT "A"

LEGAL DESCRIPTION

ESCROW NO.: 030202955

Lot 44, in Block 2, as shown on the Official Map of OLIVER PARK, and filed in the Office of the County Recorder of Douglas County, Nevada, on February 2, 1958, in Book 1 of Maps, as Document No. 14034 Douglas County, Nevada Records.

Assessor's Parcel No. 1318-22-002-030

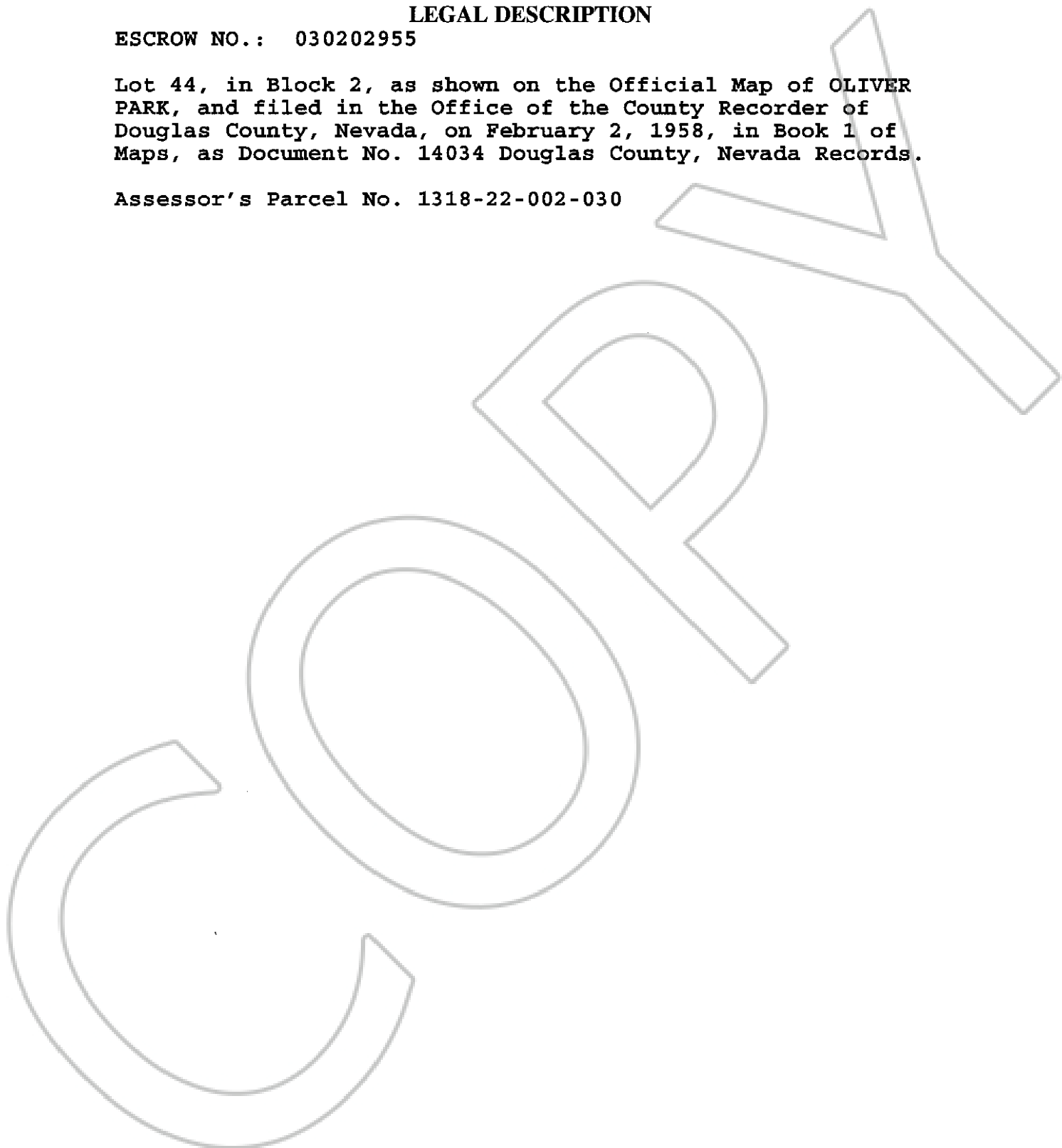

0592329

BK1003PG1392