

REQUESTED BY  
**WESTERN TITLE COMPANY, INC.**  
IN OFFICIAL RECORDS OF  
DOUGLAS CO., NEVADA

2003 OCT -6 PM 3:47

WERNER CHRISTEN  
RECORDER

\$16<sup>00</sup> PAID AS DEPUTY

APN: 1022-16-001-061  
RPTT \$15.24  Full Value  Full Value less liens

214.50

**WHEN RECORDED MAIL TO:**  
Name KENNETH E. WIRTH  
Street 3681 COOL WATER CT  
Address  
City,State PLACERVILLE, CA 95667  
Zip

**MAIL TAX STATEMENTS TO:**  
Name KENNETH E. WIRTH  
Street 3681 COOL WATER CT  
Address  
City,State PLACERVILLE, CA 95667  
Zip  
Order 00089061-201- KLS  
No.

(SPACE ABOVE THIS LINE FOR RECORDERS USE)

### GRANT, BARGAIN AND SALE DEED

THIS INDENTURE WITNESSETH: That

FOR A VALUABLE CONSIDERATION, receipt of which is hereby acknowledged, WILLIAM R MCGEE and PATRICIA A MCGEE, HUSBAND AND WIFE AS JOINT TENANTS do(es) hereby GRANT(s) BARGAIN SELL and CONVEY to KENNETH E. WIRTH and ROSE RENEE WIRTH, HUSBAND AND WIFE AS JOINT TENANTS WITH RIGHT OF SURVIVORSHIP and to the heirs and assigns of such Grantee forever, all the following real property situated in the County of Douglas, State of Nevada bounded and described as follows:

See Exhibit A attached hereto and made a part hereof.

TOGETHER with all tenements, hereditaments and appurtenances, if any, thereto belonging or appertaining, and any reversions, remainders, rents, issues or profits thereof.

Dated: September 29, 2003

0592592  
BK1003PG2541

William R. McGee  
WILLIAM R MCGEE

Patricia A. McGee  
PATRICIA A MCGEE

STATE OF NEVADA

COUNTY OF DOUGLAS } ss

This instrument was acknowledged before me on  
OCT. 2, 2003

by WILLIAM R. MCGEE AND  
PATRICIA A. MCGEE

Judith L. Perez  
Notary Public

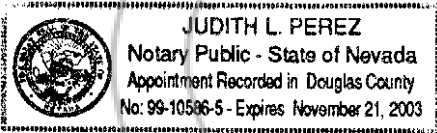

0592592

BK1003PG2542

Exhibit A

All that real property situate in the County of Douglas, State of Nevada, described as follows:

Lot 6, in Block O, as shown on the map of TOPAZ RANCH ESTATES UNIT NO. 4, filed for record in the Office of the County Recorder of Douglas County, State of Nevada, on November 16, 1970, in Book 1 of Maps, Page 224, as Document No. 50212.

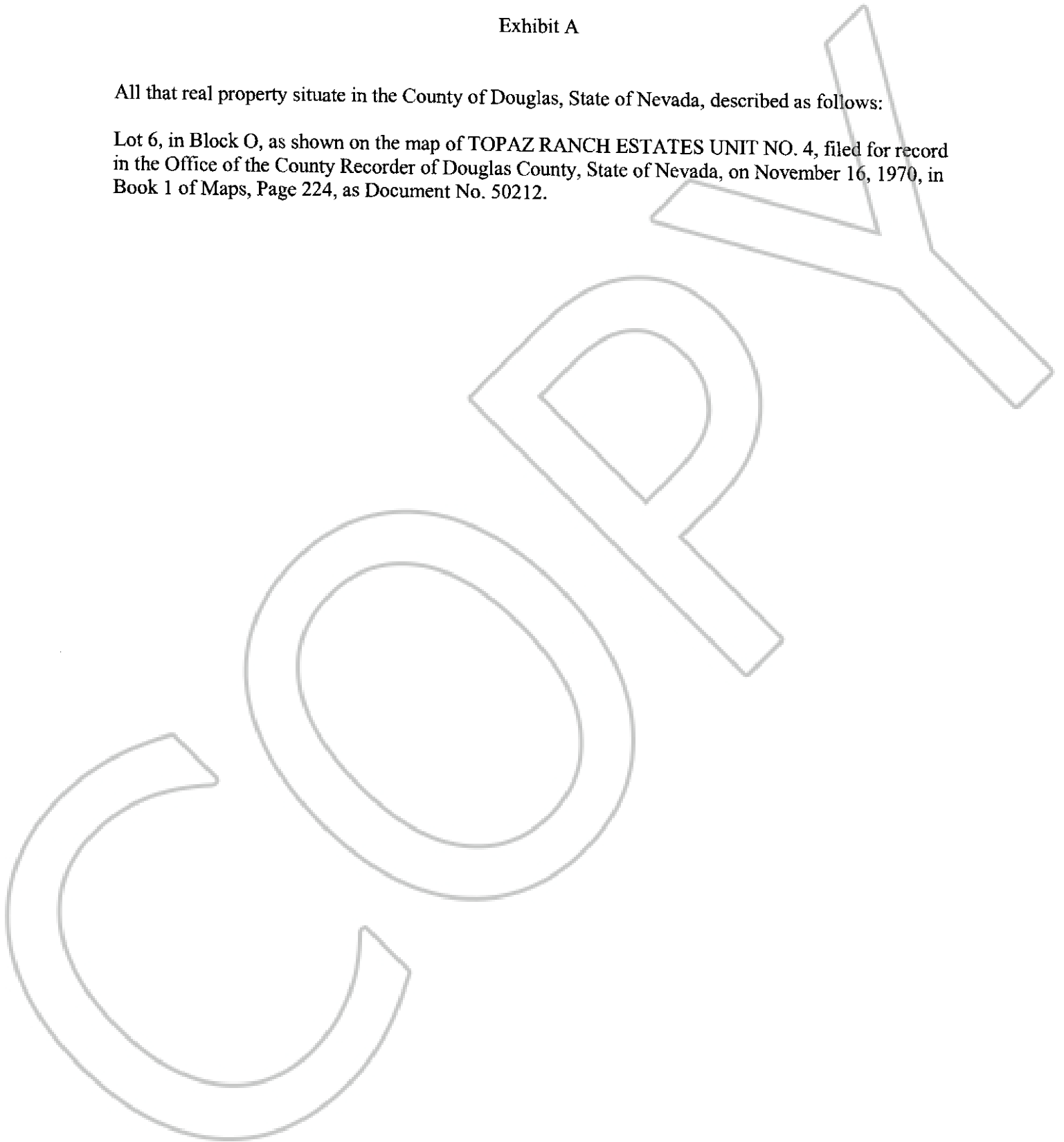

**0592592**  
**BK 1003PG2543**