

**EXHIBIT "A"
LEGAL DESCRIPTION**

Order No.: 030103323

The land referred to herein is situated in the State of Nevada,
County of Douglas, described as follows:

Lot 29, Block A, as said Lot and Block are shown on the
Amended map of RANCHOS ESTATES, filed in the office of the
County Recorder of Douglas County, State of Nevada, on
October 30, 1972, as Document No. 62493.

Assessor's Parcel No. 1220-16-210-009.

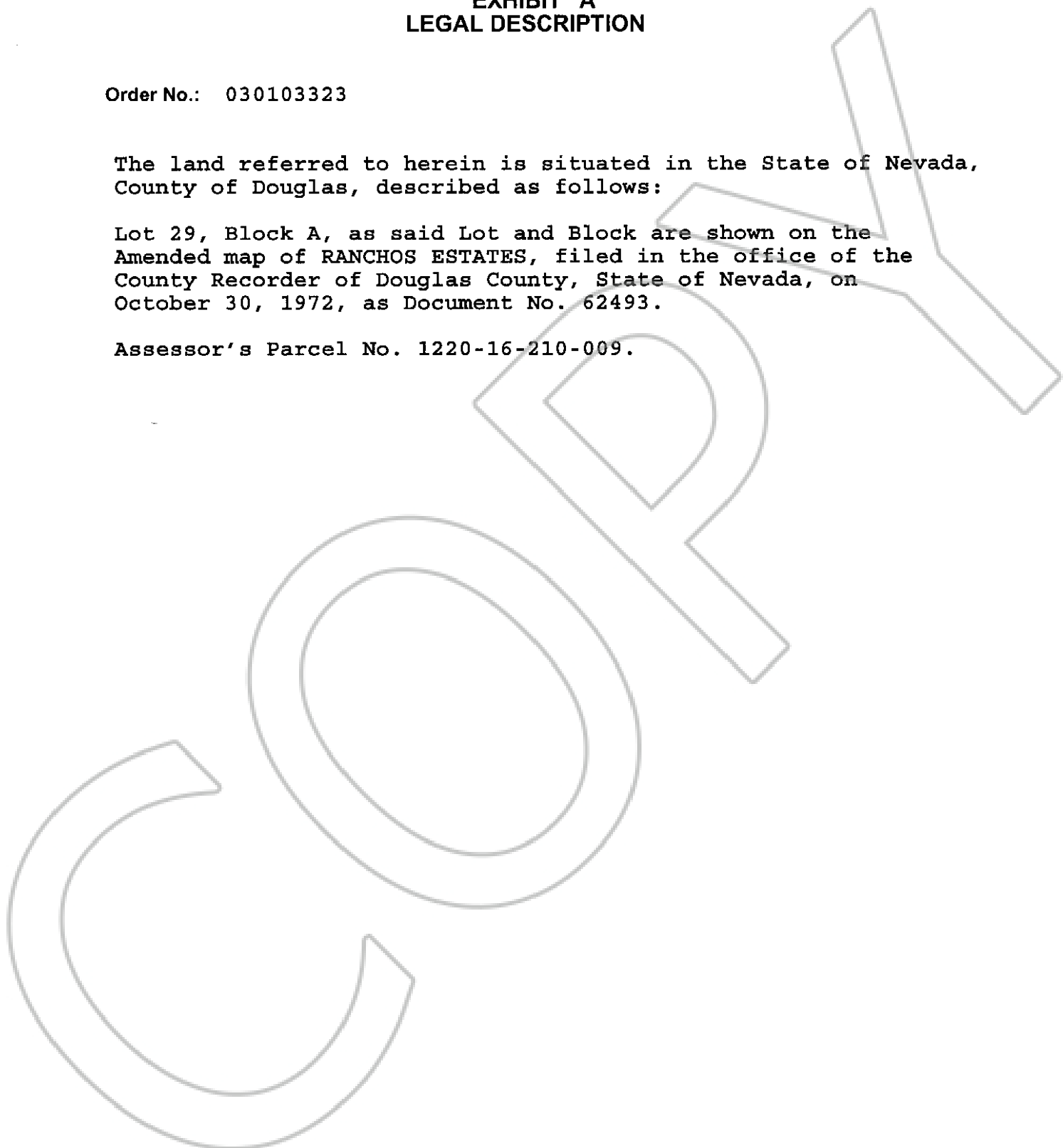

**0592789
BK1003PG3767**