

EXHIBIT "A"

LEGAL DESCRIPTION

ESCROW NO.: 030103323

Lot 29, Block A, as said Lot and Block are shown on the Amended map of RANCHOS ESTATES, filed in the office of the County Recorder of Douglas County, State of Nevada, on October 30, 1972, as Document No. 62493.

Assessor's Parcel No. 1220-16-210-009.

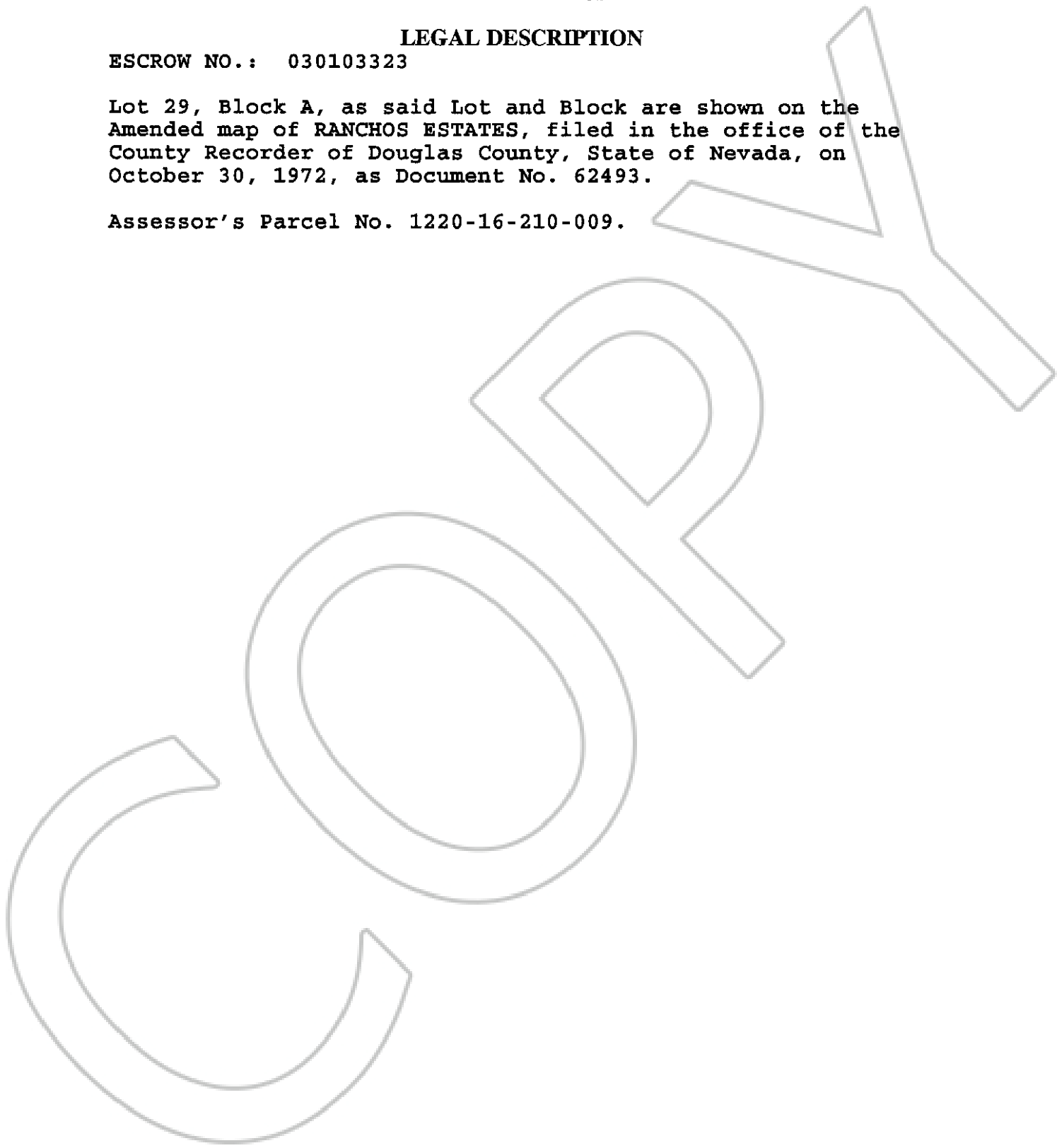

0593075
BK1003PG4861