

STATE OF NEVADA
COUNTY OF DOUGLAS

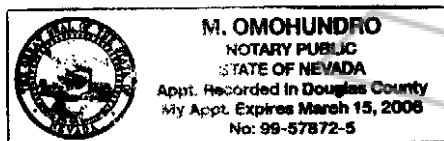

THIS INSTRUMENT WAS ACKNOWLEDGED BEFORE ME ON OCTOBER 10,
2003 BY DONNA L. SIMON.

COMMISSION EXPIRES 3-15-06

0593125
BK1003PG5151

EXHIBIT "A"

LEGAL DESCRIPTION

ESCROW NO.: 030103661

All that certain lot, piece or parcel of land situate in the County of Douglas, State of Nevada, described as follows:

Lot 3, Block A, as set forth on the Official Plat of MACKLAND SUBDIVISION, filed in the Office of the County Recorder on December 4, 1980, Book 1280, Page 475, Document No. 51372, and by Certificate of Amendment recorded November 7, 1984, Book 1184, Page 510, Document No. 109722, both instruments of Official Records of Douglas County, Nevada.

Assessment Parcel No. 1320-31-511-012

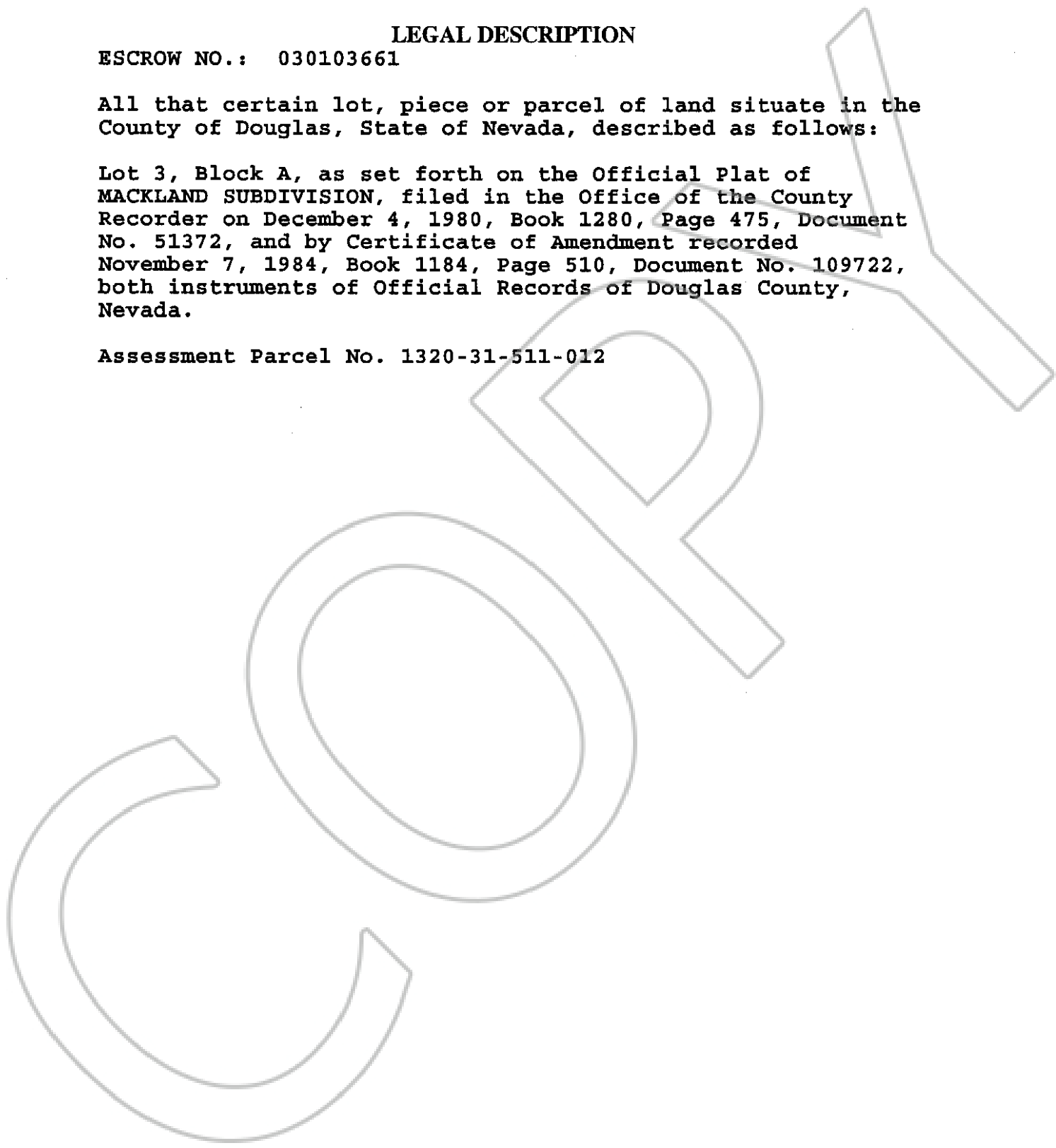

0593125
BK1003PG5152