

A.P.N. 1219-10-002-049

RECORDING REQUESTED BY:
Western Title Comopany

AND WHEN RECORDED MAIL TO:

Mrs. Shirley M. Boyd
1005 Lakeside Drive
Gardnerville, NV 89410

REQUESTED BY
WESTERN TITLE COMPANY, INC.
IN OFFICIAL RECORDS OF
DOUGLAS CO., NEVADA

2003 OCT 14 PM 3:44

WERNER CHRISTEN
RECORDER

\$15⁰⁰ PAID KJ DEPUTY

THIS SPACE FOR RECORDER'S USE ONLY:

Title Order No.: 88884-~~09123~~

Escrow No.: 01-05491

GRANT DEED

THE UNDERSIGNED GRANTOR(S) DECLARE(S)

DOCUMENTARY TRANSFER TAX is \$NONE #0

- computed on full value of property conveyed, or
- computed on full value less value of liens or encumbrances remaining at time of sale.
- Unincorporated area City of **AND**

FOR A VALUABLE CONSIDERATION, receipt of which is hereby acknowledged,

Shirley M. Boyd, a Widow

hereby GRANT(s) to:

**THIS DOCUMENT IS BEING RECORDED AS AN ASSIGNATION ONLY
WITHOUT LIABILITY FOR THE SUFFICIENCY HEREOF OR FOR THE CONDITION OF THE**

Shirley M. Boyd, Successor Trustee of the Charles I. and Shirley Mae Boyd 1997 Trust dated November 10, 1997

the real property in the County of Douglas, State of ~~California~~ ^{NEVADA}, described as:
LEGAL DESCRIPTION ATTACHED HERETO AS EXHIBIT "A" AND MADE A PART HEREOF
Also Known as: 1005 Lakeside Drive, Gardnerville, NV 89410
AP#: 1219-10-002-049

"THIS CONVEYANCE TRANSFERS THE GRANTOR'S INTEREST INTO HIS OR HER REVOCABLE LIVING TRUST, R&T 11911."

DATED September 26, 2003
STATE OF CALIFORNIA ^{Nevada}
COUNTY OF Douglas
On September 27, 2003
Before me, Charlene McDonald
A Notary Public in and for said State, personally appeared
Shirley M. Boyd

Shirley M. Boyd
Shirley M. Boyd

personally known to me (or proved to me on the basis of satisfactory evidence) to be the person(s) whose name(s) is/are subscribed to the within instrument and acknowledged to me that he/she/they executed the same in his/her/their authorized capacity(ies), and that by his/her/their signature(s) on the instrument the person(s), or the entity upon behalf of which the person(s) acted, executed the instrument.
WITNESS my hand and official seal.

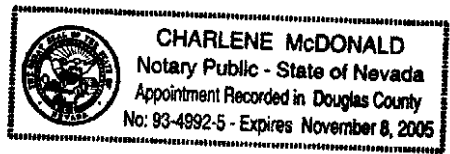

Signature Charlene McDonald

(This area for official notarial seal)

MAIL TAX STATEMENTS TO PARTY SHOWN BELOW; IF NO PARTY SHOWN, MAIL AS DIRECTED ABOVE:

0593493
BK 1003PG6687

Exhibit A
Legal Description

All that real property situate in the County of Douglas, State of Nevada, described as follows:

Lot 1, in Block B, as shown on the Official Map of SIERRA RANCHO ESTATES UNIT NO. 1, filed in the office of the County Recorder of Douglas County, State of Nevada, on August 23, 1978, in Book 878, Page 1963, as Document No. 24464.

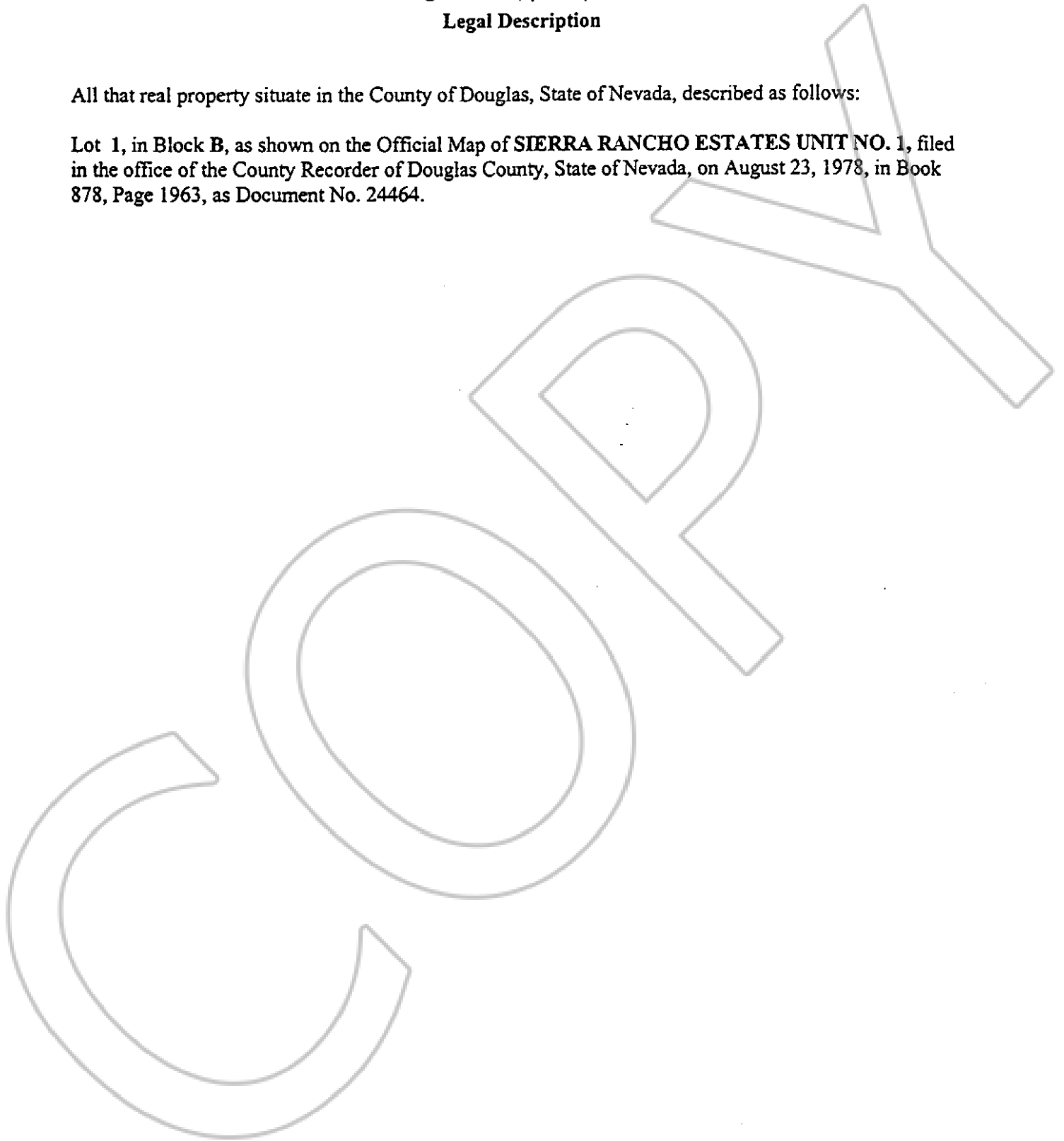

0593493
BK 1003PG6688