

A.P.N. # 1320-33-816-070

R.P.T.T. \$ 1195.35

ESCROW NO. 030303335

RECORDING REQUESTED BY:
STEWART TITLE COMPANY

MAIL TAX STATEMENTS TO:
SAME AS BELOW

WHEN RECORDED MAIL TO:
MR. & MRS. JOHNSON
1351 CHICHESTER DRIVE
GARDNERVILLE, NV 89410

REQUESTED BY
Stewart Title of Douglas County

IN OFFICIAL RECORDS OF
DOUGLAS CO., NEVADA

2003 OCT 17 PM 3:49

WERNER CHRISTEN
RECORDER

\$ 15.00 PAID KJ DEPUTY

(Space above for Recorder's Use Only)

CORPORATION
GRANT, BARGAIN, SALE DEED

THIS INDENTURE WITNESSETH: That
SYNCON HOMES, a Nevada Corporation

in consideration of \$10.00, the receipt of which is hereby acknowledged, does hereby Grant, Bargain Sell and Convey to
RICHARD T. JOHNSON and SANDRA G. JOHNSON, husband and wife
as JOINT TENANTS

and to the heirs and assigns of such Grantee forever, all that real property situated in the
County of **DOUGLAS** State of Nevada,

bounded and described as follows:

SEE EXHIBIT "A" ATTACHED HERETO AND MADE A PART HEREOF

Together with all and singular the tenements, hereditaments and appurtenances thereunto belonging or in anywise appertaining, and any reversions, remainders, rents, issues or profits thereof.

DATE: **October 13, 2003**

SYNCON HOMES
A NEVADA CORPORATION

BY: Andrew W. Mitchell Pres
ANDREW W. MITCHELL
PRESIDENT

BY: _____

STATE OF Nevada }
COUNTY OF DOUGLAS } ss.

This instrument was acknowledged before me on 10-16-03
by ANDREW W. MITCHELL

Signature [Signature]
Notary Public (One Inch Margin on all sides of Document for Recorder's Use Only)

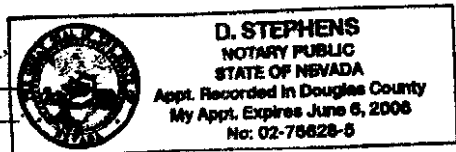

0593941

BK1003PG8967

EXHIBIT "A"

LEGAL DESCRIPTION

ESCROW NO.: 030303335

Lot 13, Block B, as set forth on FINAL SUBDIVISION MAP No. 1006-11 for CHICHESTER ESTATES, PHASE 11, filed in the office of the County Recorder of Douglas County, Nevada and recorded December 27, 2002 in Book 1202, Page 12732, as Document No. 562225, and by Certificate of Amendment recorded March 27, 2003 in Book 0303, Page 13037, as Document No. 0571430, Official Records of Douglas County, Nevada.

Assessors Parcel Number 1320-33-816-070

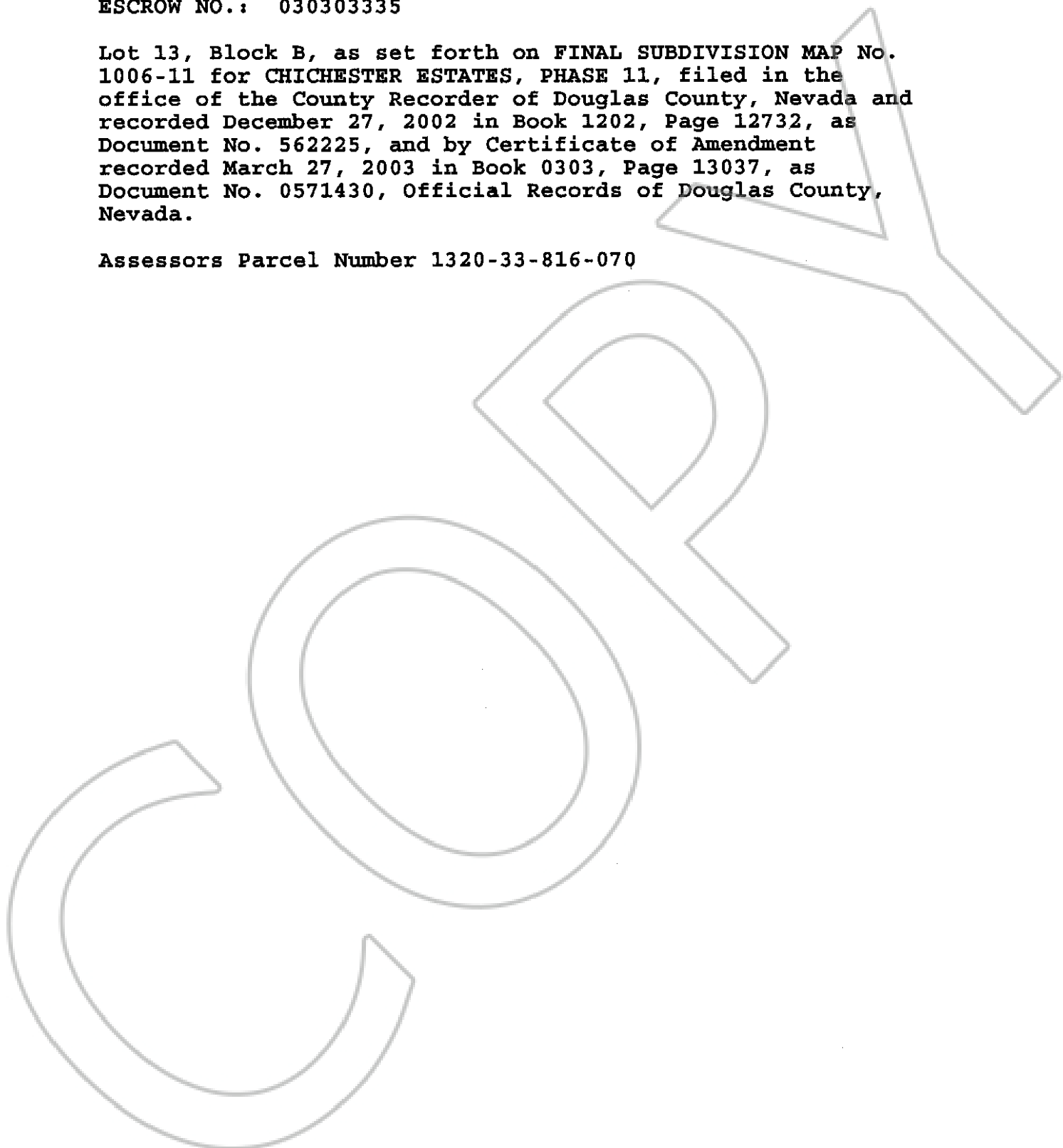

0593941

BK1003PG8968