

A.P.N. # 1420-07-510-006

R.P.T.T. \$ 0.15

ESCROW NO. 03053044

RECORDING REQUESTED BY:
STEWART TITLE COMPANY
MAIL TAX STATEMENTS TO:
SAME AS BELOW

WHEN RECORDED MAIL TO:
GRANTEE
3388 ANGEL LANE
PLACERVILLE, CA 95667

REQUESTED BY
Stewart Title of Douglas County
IN OFFICIAL RECORDS OF
DOUGLAS CO., NEVADA

2003 OCT 21 PM 3:21

WERNER CHRISTEN
RECORDER

\$15⁰⁰ PAID KJ DEPUTY

(Space Above for Recorder's Use Only)

GRANT, BARGAIN, SALE DEED

THIS INDENTURE WITNESSETH: That **KAREN HERBERT* *A MARRIED WOMAN**

in consideration of \$10.00, the receipt of which is hereby acknowledged, does hereby Grant, Bargain Sell and Convey to **COLIN R. HERBERT * A MARRIED MAN AS HIS SOLE AND SEPARATE PROPERTY**

and to the heirs and assigns of such Grantee forever, all that real property situated in the County of **Douglas** State of Nevada, bounded and described as :

SEE EXHIBIT "A" ATTACHED HERETO AND MADE A PART HEREOF

IT IS THE EXPRESS INTENT OF THE GRANTOR, BEING THE SPOUSE OF THE GRANTEE, TO CONVEY ALL RIGHT, TITLE AND INTEREST OF THE GRANTOR, COMMUNITY OR OTHERWISE, IN AND TO THE HEREIN DESCRIBED PROPERTY TO THE GRANTEE AS GRANTEE'S SOLE AND SEPARATE PROPERTY.

Together with all and singular the tenements, hereditaments and appurtenances thereunto belonging or in anywise appertaining, and any reversions, remainders, rents, issues or profits thereof.

DATE: **October 06, 2003**

Karen Herbert
KAREN HERBERT

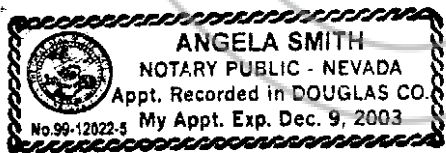

STATE OF NV }
COUNTY OF Douglas } ss.

This instrument was acknowledged before me on 10-7-03,
by, **KAREN HERBERT**

Signature Angela Smith

Notary Public (One Inch Margin on all sides of Document for Recorder's Use Only)

0594203

BK1003PG10368

EXHIBIT "A"
LEGAL DESCRIPTION

The land referred to herein is situated in the State of Nevada,
County of Douglas, described as follows:

Lot K-20, in Block K, as shown on the Final Map #1007-3 of
VALLEY VISTA ESTATES, PHASE 2 recorded in the office of the
Douglas County Recorder, State of Nevada, on August 29,
1997, in Book 897, at Page 6072, as Document No. 420670,
Official Records.

Assessors Parcel No. 1420-07-510-006

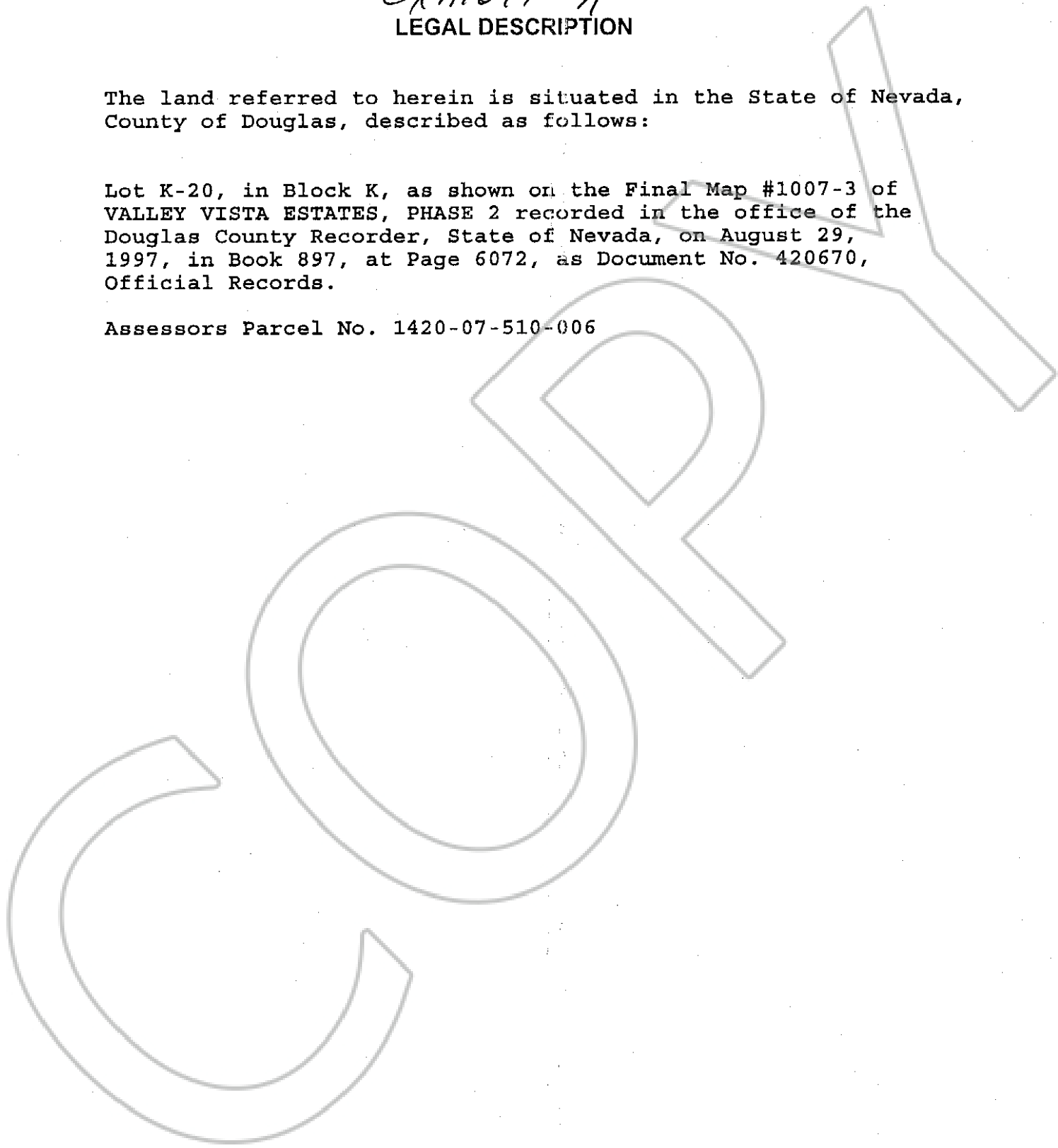

0594203

BK 1003PG10369