

REQUESTED BY
WESTERN TITLE COMPANY, INC.
IN OFFICIAL RECORDS OF
DOUGLAS CO., NEVADA

APN: 1319-18-410-012
RPTT \$492.70 1478.10

2003 OCT 21 PM 3:41

WHEN RECORDED MAIL TO:
Name MICHAEL E. WONDKA
Street P.O. BOX 7136
Address
City,State STATELINE, NV 89449
Zip

WERNER CHRISTEN
RECORDER

\$16⁵⁰ PAID *KJ* DEPUTY

MAIL TAX STATEMENTS TO:
Name MICHAEL E. WONDKA
Street P.O. BOX 7136
Address
City,State STATELINE, NV 89449
Zip
Order 00088988-201- SLG
No.

(SPACE ABOVE THIS LINE FOR RECORDERS USE)

GRANT, BARGAIN AND SALE DEED

THIS INDENTURE WITNESSETH: That

FOR A VALUABLE CONSIDERATION, receipt of which is hereby acknowledged, JAN L. ARDREY, an unmarried man, do(es) hereby GRANT(s) BARGAIN SELL and CONVEY to MICHAEL E. WONDKA, an unmarried man and to the heirs and assigns of such Grantee forever, all the following real property situated in the City of N/A, County of Douglas, State of Nevada bounded and described as follows:

See Exhibit A attached hereto and made a part hereof.

TOGETHER with all tenements, hereditaments and appurtenances, if any, thereto belonging or appertaining, and any reversions, remainders, rents, issues or profits thereof.

Dated: September 6, 2003

0594216

BK1003PG0457

STATE OF NEVADA

COUNTY OF WASHOE

} ss

Jan L. Ardrey
JAN L. ARDREY

This instrument was acknowledged before me on

September 25, 2003

by JAN L. ARDREY

STARKER SERVICES AS
INTERMEDIARY ARDREY

Autumn Smith
Notary Public

 AUTUMN SMITH
Notary Public - State of Nevada
Appointment Recorded in Washoe County
No: 03-82752-2 - Expires June 26, 2007

0594216

BK1003PG0458

Exhibit A

All that real property situate in the County of Douglas, State of Nevada, described as follows:

Lot 2, as shown on THE AMENDED MAP OF KINGSBURY VILLAGE UNIT NO. 2, filed for record in the office of the County Recorder of Douglas County, State of Nevada, on July 10, 1963, in Book 1 of Maps, as Document No. 22953.

Said lot being one and the same as lot 85 of the Official Map of KINGSBURY VILLAGE UNIT NO. 2, filed for record on June 14, 1962, in Book 1 of Maps as Document No. 20221, of Official Records.

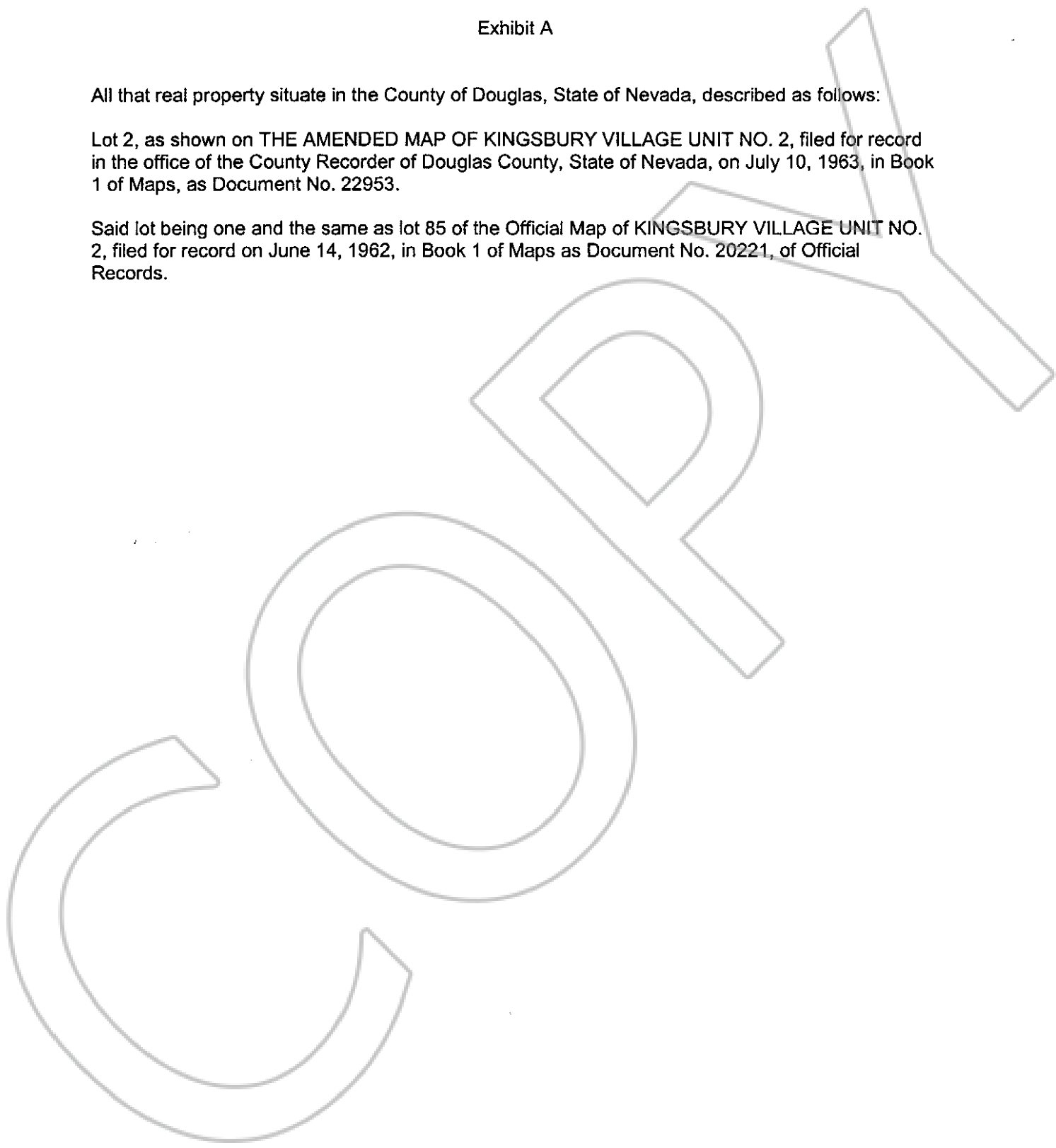

0594216
BK 1003PG0459