

Mr
A.P.N. # ~~22N~~ 1220-12-000-004

R.P.T.T.S. Ex # 6
ESCROW NO. _____

RECORDING REQUESTED BY: _____

MAIL TAX STATEMENTS TO:
GRANTEE
1323 THURGAU COURT
INCLINE VILLAGE, NV. 89450

WHEN RECORDED MAIL TO:
GRANTEE
1323 THURGAU COURT
INCLINE VILLAGE, NV. 89450

REQUESTED BY
R. Witzig
IN OFFICIAL RECORDS OF
DOUGLAS CO., NEVADA

2003 OCT 23 PM 2:23

WERNER CHRISTEN
RECORDER

\$15⁰⁰ PAID Bk DEPUTY

(Space Above for Recorder's Use Only)

GRANT, BARGAIN, SALE DEED

THIS INDENTURE WITNESSETH: That **RICHARD A. WITZIG, a married man**
as his sole and separate property

in consideration of \$10.00, the receipt of which is hereby acknowledged, does hereby Grant, Bargain Sell
and Convey to **RICHARD A. WITZIG and MARY LOIS TENGE WITZIG,**
husband and wife as joint tenants

and to the heirs and assigns of such Grantee forever, all that real property situated in the
unincorporated area County of **DOUGLAS** State of Nevada, bounded and described as:

SEE EXHIBIT "A" ATTACHED HERETO AND MADE A PART HEREOF

Together with all and singular the tenements, hereditaments and appurtenances thereunto belonging or in
anywise appertaining, and any reversions, remainders, rents, issues or profits thereof.

DATE: **October 02, 2003**

Richard A. Witzig
RICHARD A. WITZIG

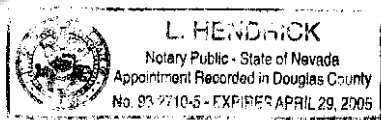

STATE OF **NEVADA** }
 } ss.
COUNTY OF **DOUGLAS** }

This instrument was acknowledged before me on 10-23-03
by **RICHARD A. WITZIG**

Signature L. Hendrick
Notary Public (One inch margin on all sides of document for Recorder's Use Only)

0594583
BK 1003PG/1961

EXHIBIT "A"

LEGAL DESCRIPTION

ESCROW NO.: 030701647

Being a portion of the North one-half of Section 12,
Township 12 North, Range 20 East, M.D.B.&M., further
described as follows:

Lot 40 in Block A, as set forth on FINAL SUBDIVISION MAP
2DA #01-083 FOR PINION RIDGE, filed for record in the
office of the County Recorder of Douglas County, State of
Nevada on September 15, 2003 in Book 0903, Page 7332 as
Document No. 589938.

A portion of Assessor's Parcel No. 1220-12-000-004

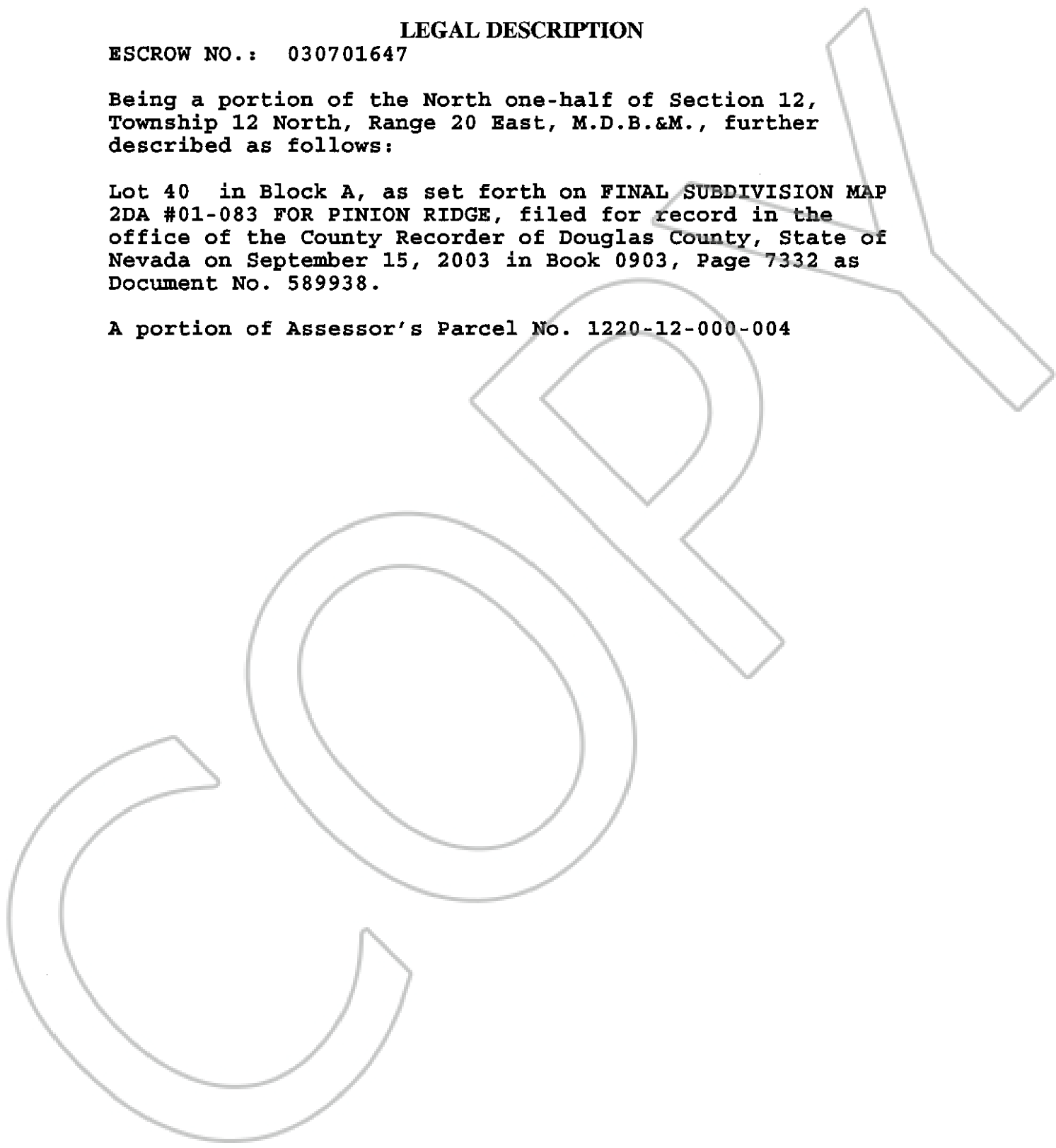

0594583
BK 1003PG 962